

JCB Hammermaster Rockbreakers Service Repair Manual





Service Manual

Hammermaster Rockbreakers

PUBLISHED BY THE
JCB ATTACHMENTS
RIVERSIDE, RUGELEY
STAFFORDSHIRE, WS15 2WA
ENGLAND
Tel. ROCESTER (01889) 572700
PRINTED IN ENGLAND

Publication No. 9803/1300

		Open front screen
General Information & Safety	1	Servicing - 570/670/770 Range 12
Routine Maintenance	2	Servicing - 70 13
Servicing - 260 Range	3	Servicing - 550 14
Servicing - 360 Range	4	*Servicing - 1050/1150 15
Servicing - 460-110	5	*Servicing - 1350/1450 16
Servicing - 560	6	Servicing - 1750 17
Servicing - 660	7	*Servicing - 2350/2950/3850/3950 18
Servicing - 760	8	Servicing - 850 19
Servicing - 860	9	*Servicing - 100/115 20
Servicing - 960	10	Servicing - 60/110 21
Servicing - 160 Range	11	22

* Torque Settings - Hammermaster 460-110

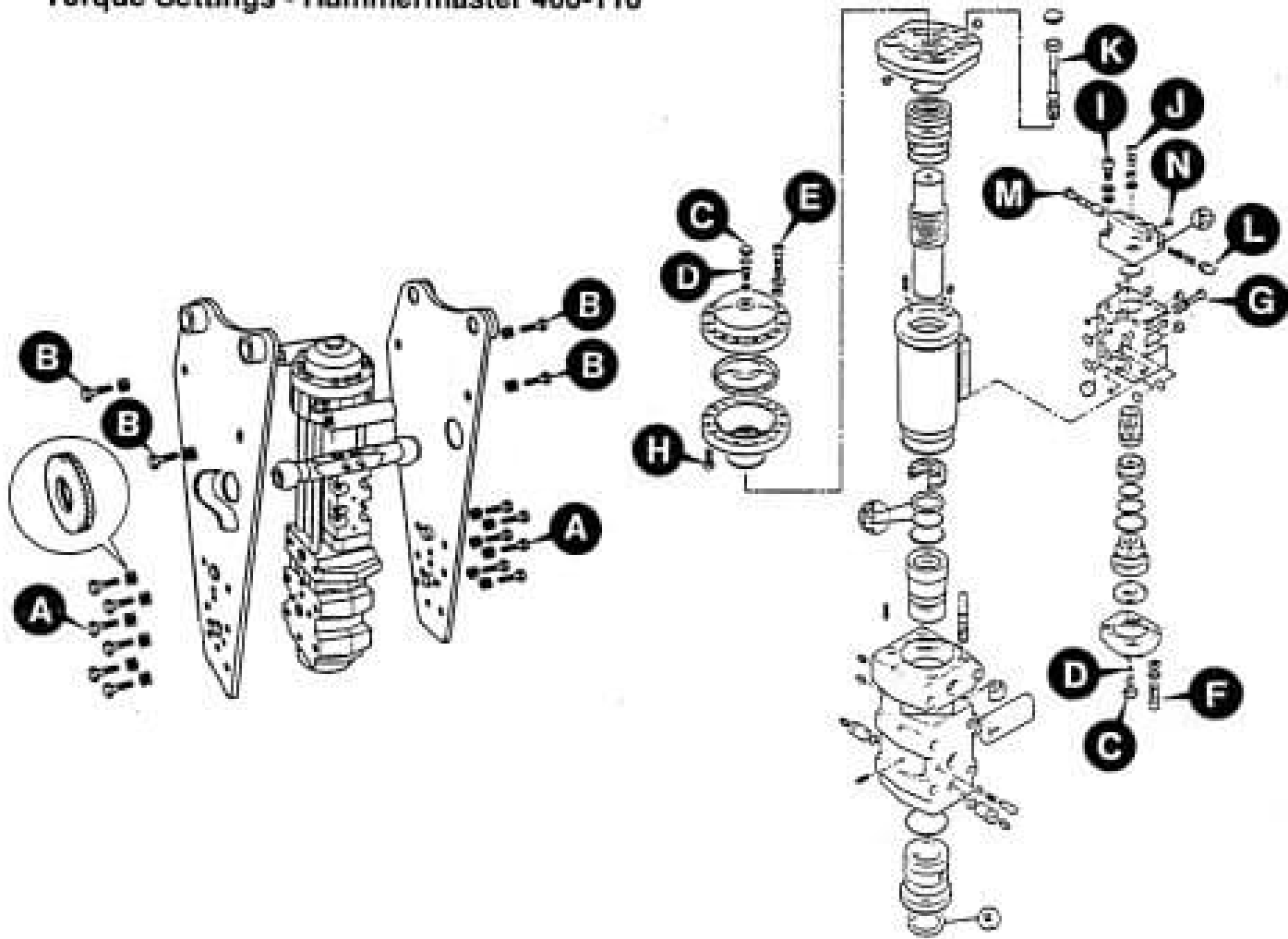

Item	Description	Quantity	Torque Setting	
			Nm	lbf ft
A	Sideplate mounting screws (lower) M30	12	1150	848
B	Sideplate mounting screws (upper) M24	4	580	430
C	Accumulator plugs	2	150	110
D	Accumulator filling plug	1	90	66
E	Mounting screws - LP accumulator	8	175	129
F	Mounting screws - HP accumulator	4	340	250
G	Mounting screws - valve body	6	340	250
H	Cover mounting screws - LP accumulator	8	175	129
I	Mounting screws - pressure adjusting cover	2	340	250
J	Mounting screws - pressure adjusting cover	3	175	129
K	Tie rods (plus 60")	4	500	370
L	Spring housing	1	150	110
M	Plug - pressure adjusting valve	1	150	110
N	Plug - pressure adjusting cover	1	90	66
-	All other plugs	6	33	24

Greasing

The Tool Bushings (Every 2-4 Hours)

Position the Hammermaster vertically as shown, with its weight on the tool. Make sure the carrier parking brake is engaged, the drive is in neutral and the engine stopped. Remove the starter key.

Inject JCB Special Hammer Grease through grease point(s) **A** using the grease gun supplied. Ten - to - fifteen shots should normally be enough.

Note: Make sure that the tool is kept fully up in its housing during greasing, to prevent grease filling the cavity between the piston and the tool.

The actual frequency of this job will depend on operating conditions and the material being worked. If inspection reveals that the greasing has been insufficient, grease more often.

Hammermaster Pivots (except 160Q, 260L) (Daily)

Use a grease gun to inject JCB 'Special' MPL Grease into the pivot grease points **B**.

Total 4 Grease Points

Hammermaster Pivots (260L only) (Daily)

Use a grease gun to inject JCB 'Special' MPL Grease into the pivot grease points **C** which are located on the carrier dipper and tipping link.

Total 2 Grease Points

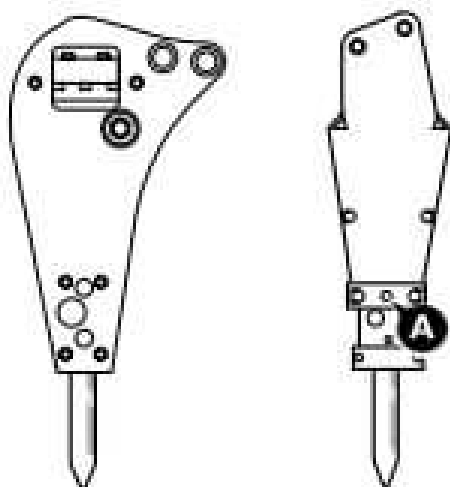

0911A

Hammermaster 160, 160Q, 160R

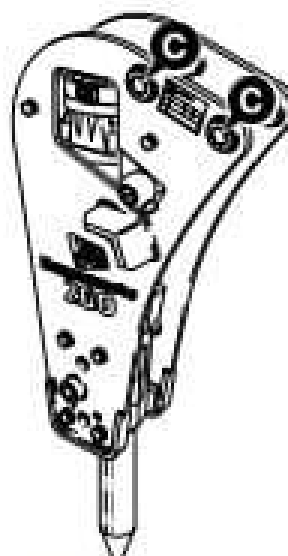

0908A

Hammermaster 260L (Pivots only)

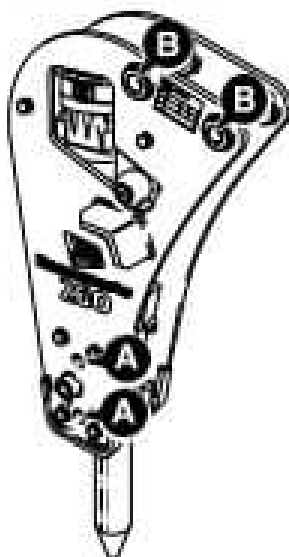

0908A

Hammermaster 260 (Tool bushings and pivots)

Hammermaster 260L (Tool bushings only)

Note: Lower grease point **A** not fitted to early models.

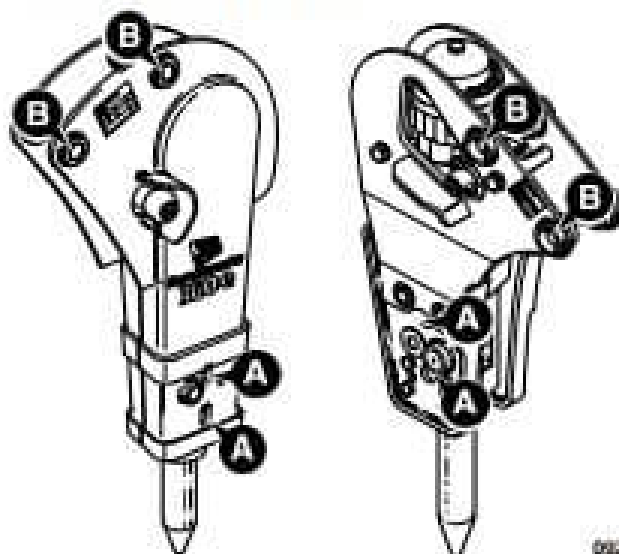

0926A

Hammermaster 360, 360Q, 260LD

* Hammermaster 360 - 70, 550



Thank you very much
for your reading.
Please click here
to get more information.