

JCB JS110,JS130,JS150LC Tracked Excavators Service Repair Manual



9802/2010

M555001 on to M125000

Change Notification

Section A - Buckets and Attachments

- A1 - Shovel
- A2 - Backhoe
- A3 - Grab
- A4 - Jaw Bucket

Section B - Excavator and Framework

- B1 - Shovel
- B2 - Bodywork
- B3 - Cab and Seat
- B4 - Backhoe
- B5 - Miscellaneous
- B6 - International Harvester

Section C - Electrical Equipment

- C1 - Cab Electrics

Section E - Hydraulics

- E1 - Hose and Pipework
- E2 - Valves
- E3 - Pump and Filter
- E4 - Rams
- E5 - Hydraulic Clamping
- E6 - International Harvester
- E7 - Options and Attachments
- E8 - Foot Operated Attachments

Section H - Steering

- H1 - Axle
- H2 - Hose and Pipework
- H3 - Rams and Valves



A 1-1 SHOVEL

3042A

ITEM PART No. CHANGE No

4 990/14700

990/15900

5 1019/2052

1019/2084 To M68150

1019/2052

6 1019/3831

1021/3846 To M68150

1019/3831

7 1305/3222

8 1340/0203

9 1305/3222

1305/3430

10 1340/0203

1340/0403

11 1450/0001

12 510/20720

13 510/20721

14 103/20201

15 531/03204

16 990/45900

#Bucket for long rear

#Bucket for JCB 3D w
fitted.

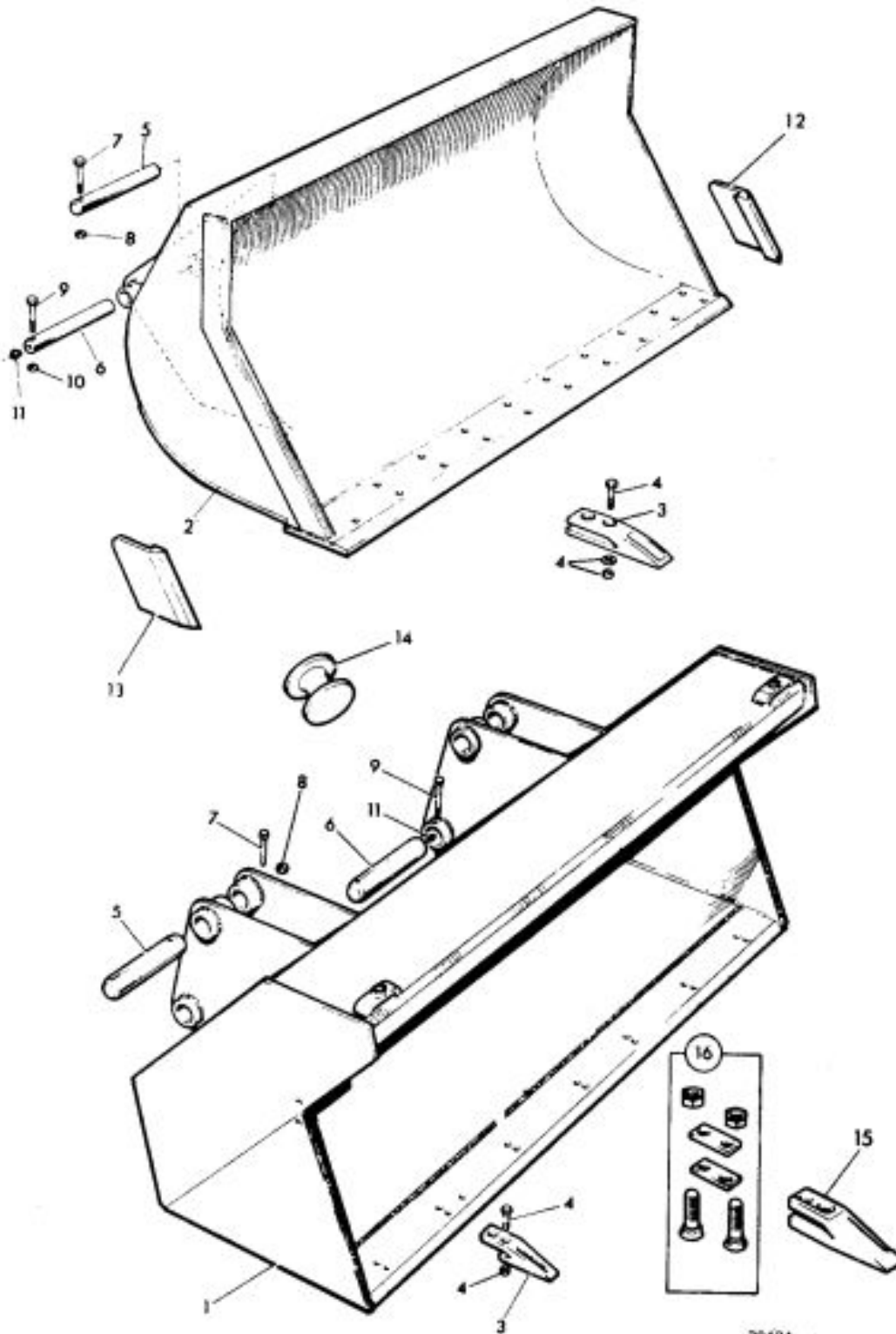

3042A

Logic Sequence

Introduction

This Logic sequence should be read in conjunction with:

➔ [Circuit Description \(D 11\)](#)

➔ [Hydraulics Schematic \(D 20\)](#)

➔ [Electrical Schematic \(D 22\)](#)

Each item should be read sequentially, unless indicated (for example: Go to item 10).

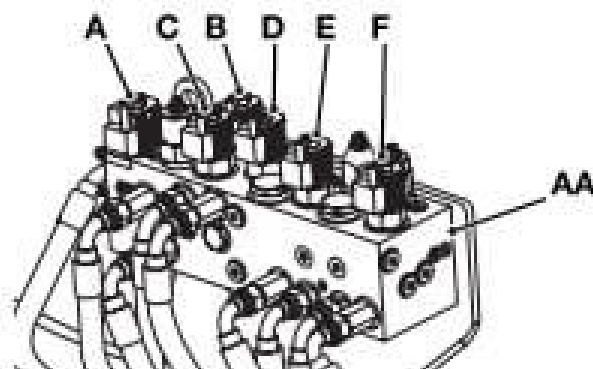

Fig 11. Solenoid Locations

- A Solenoid, proportional (PWM) valve
- B Solenoid, valve B
- C Solenoid, valve C⁽¹⁾
- D Solenoid, valve D
- E Solenoid, valve E
- F Solenoid, valve F

(1) Machines without stabiliser legs (528-70, 535-95) do not have solenoid valve C fitted.

Note: In the following description, the various thresholds have the meanings below:

Minimum Threshold	Green Lights (LED) on
Maximum Threshold	Red Light (LED) on

The amber light (LED) will be on between minimum and maximum thresholds.

Note: MVB = Main Valve Block.

- 1 Start Machine.
- 2 Machine defaults to Load Control Mode.
 - a Load Control Mode Symbol Illuminated.
- 3 >45° boom angle and stabiliser leg up?
 - a Yes - Go to item 4.
 - b No - Go to item 8.
- 4 Solenoid B = 0V. Flow regulator for lower in circuit.

Solenoid E = 0V, Solenoid C = 0V. Lift oil from MVB to tank.
- 5 532-120, 533-105, 537-135 Only - solenoid C = 0V. Lift oil from MVB to tank.
- 6 LMI Signal:
 - a Below maximum threshold (red light not on).

Solenoid D - 12V. Extend oil from MVB to ram.

Proportional valve partially open. Lower oil from MVB to ram (supply limited). Go to item 3.
 - b Above maximum threshold (red light on)

Solenoid D = 0V. Extend oil from MVB to tank.

No power to proportional valve (fully closed).
- 7 Retract boom to reduce load moment (or use override). Go to item 3.
- 8 Is mode change required?
 - a Yes - Go to item 9.
 - b No - Go to item 15.
- 9 Which mode?
 - a Load Control, Go to 10.
 - b Ground Work, Go to 12.
- 10 Press and hold mode switch for 5 seconds. LMI signal:
 - a Above min. threshold (amber or red light on) - prevent mode change. Go to 11.
 - b Below min. threshold (green lights on) - allow mode change. LMI display LEDs flash indicating change. Release mode button. Go to 2a.
- 11 Press and hold mode button. No change takes place, Load Control symbol remains lit.

Reduce load moment by retract/lift or retract boom and remove load. Go to 10.



Thank you very much
for your reading.
Please click here
to get more information.