

JCB Teletruk From M/c No.788001 Skid Steer Loader Service Repair Manual



PDF  **DOWNLOAD** 



Service Manual

8080

PUBLISHED BY THE
TECHNICAL PUBLICATIONS DEPARTMENT
OF JCB SERVICE; © WORLD PARTS CENTRE,
WATERLOO PARK, UTTOXETER, ST14 5PA
ENGLAND

Tel. ROCESTER (01889) 590312
PRINTED IN ENGLAND

Publication No. 9803/9330 Issue 3

General Information	1
Care & Safety	2
Routine Maintenance	3
Body and Framework	B
Electrics	C
Controls	D
Hydraulics	E
Transmission	F
Track and Running Gear	J
Engine	K

Contents	Page No.
Identifying your Machine	
Identification Plates	1 - 1
Operation	
Introduction	2 - 1
Before Entering the Cab	2 - 2
Entering/Leaving the Cab	2 - 3
Opening and Closing the Door	2 - 4
Opening and Closing the Front Upper Window	2 - 4
Opening and Closing the Front Lower Window	2 - 5
Emergency Exit	2 - 5
Door Sliding Window	2 - 5
Opening and Closing the Sunblind	2 - 5
Seat	2 - 6
Seat Belt	2 - 6
Location of Controls and Components	3 - 1
Switches and Controls	4 - 1
Right Console	4 - 1
Underseat Tool Box and Cool Box	4 - 2
Heater/Air Conditioning Controls	4 - 3
Left Console	4 - 4
EMS Panel	4 - 5
Facia Panel	4 - 9
Redundancy Switch	4 - 10
Mechanical Engine Speed Override	4 - 10
Servo Controls Immobilisation	4 - 10
Cab Interior Light	4 - 11
Radio (Optional)	4 - 11
Travel Levers	4 - 12
Travel Speed Change Button	4 - 12
Excavating Controls	5 - 1
Operation	5 - 1
Slewing	5 - 2
Boom Swing	5 - 3
Boom Swing Stop	5 - 3
Boom Raise/Lower	5 - 4
Dipper In/Out	5 - 5
Bucket Close/Open	5 - 6
Refuelling	6 - 1
Fuel Level	6 - 1
Filling the Tank	6 - 1
Refuelling Pump (optional)	6 - 2
Before Starting the Engine	6 - 3
Starting the Engine	6 - 4
Jump-Starting the Engine	6 - 5
Warming Up	6 - 6
Operating in Cold Climates	6 - 7
Operating in High Temperatures	6 - 7
Operating in Dusty or Sandy Areas	6 - 7
Operating in Coastal Regions	6 - 7
Operating on Wet or Soft Ground	6 - 7
Preparing for Travel	6 - 8
Stopping and Parking the Machine	6 - 9
Working on Slopes	7 - 1
Digging Near Walls	7 - 1
Dumping into a Truck	7 - 1

Excavator End (Standard Boom) (50 hours)

Read general information about greasing at the beginning of this section.

Each arrow highlights one grease point.

Grease Points

- | | | | |
|----|---------------------------------|----|---------------------------------|
| 1 | Dipper/tipping link pivot | 12 | Swing ram/kingpost pivot |
| 2 | Dipper/bucket pivot | 13 | Dozer ram/undercarriage pivot |
| 3 | Tipping link/bucket pivot | 14 | Swing ram/body pivot (remote) |
| 4 | Tipping link/tipping link pivot | 15 | Dozer/left hand pivot |
| 5 | Bucket ram/tipping lever pivot | 16 | Dozer ram/dozer pivot |
| 6 | Bucket ram/dipper pivot | 17 | Dozer - right hand pivot |
| 7 | Dipper Ram/dipper pivot | 18 | Boom ram/kingpost pivot |
| 8 | Boom/dipper pivot | 19 | Kingpost/carrier pivot |
| 9 | Boom ram/boom pivot | 20 | Boom/kingpost pivot - left hand |
| 10 | Dipper ram/boom pivot (remote) | 21 | Kingpost/lever pivot |
| 11 | Boom/kingpost pivot | | |

WARNING

You will be working close into the machine for these jobs. Lower the attachments if possible. Remove the starter key and disconnect the battery. This will prevent the engine being started.

2-3-1-3

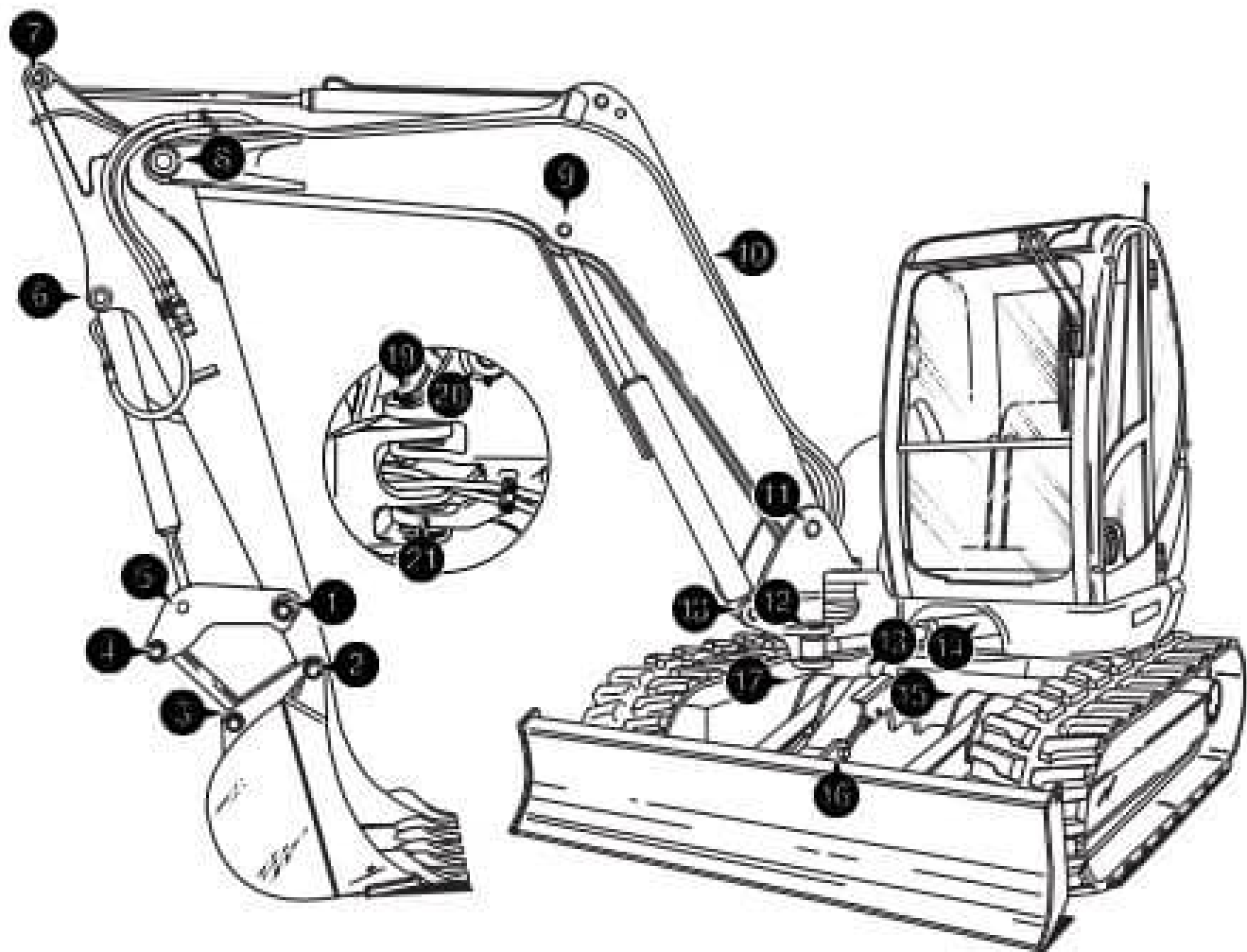



Thank you very much
for your reading.
Please click here
to get more information.