

# John Deere 1050K Crawler Dozer Diagnostic, Operation and Test Service Manual (TM13601X19)

670G, 670GP, 672G, and  
672GP Motor Graders  
Diagnostic



## OPERATION AND TEST MANUAL

T2/S2 models 670G, 670GP, 672G, 672GP (PIN: 1DW67\*G\*\*\*C656729-;  
1DW67\*G\*\*\*D656729-)

TM13065X19 10 MAR 16 (ENGLISH)

### For complete service information also see:

|   |            |
|---|------------|
| 670G, 670GP, 672G, and 672GP Motor Graders (PIN: 1DW67*G***C656729-)<br>(PIN: 1DW67*G***D656729- )  | TM13068X19 |
| JDLink (MTG) Technical Manual   | TM114519   |
| TeamMate II 1200 Series Inboard Planetary Axles   | CTM43      |
| PowerTech 9.0L O-Base Engine Repair   |            |
| PowerTech 6090 Diesel Engine High Pressure Common Rail  |            |
| PowerTech 4045, 6068 Diesel Engine Denso High Pressure Common Rail ECU  | CTM520     |
| DF180 Series Powershift Transmission Repair Manual  | CTM308     |
| TeamMate II 1400 Series Inboard Planetary Axles   | CTM138619  |
| 120 Series Hydraulic Cylinders  | CTM120519  |
| PowerTech 4.5L & 6.8L Diesel Engines Tier 1/Stage I, Tier 2/Stage II, Tier 3/Stage IIIA, Tier 3/Stage IIA Tier 3/Stage III, (Base Engine) | CTM104     |



John Deere Construction and Forestry  
Printed by Belgroen



Covers: 1050K,(PIN:1T01050K\_C268234-)

**Type:** Service Manual

**Language:** English

**Pages:** 1201

**Format:** PDF

**Features:** Bookmarked, searchable, printable

**Compatibility:** Windows/Mac/Tablet/Mobile

This service manual contains important information for the maintenance, troubleshooting and servicing of the **John Deere 1050K Crawler Dozer Diagnostic, Operation and Test Service Manual (TM13601X19)**

In this manual you will find detailed specifications, illustrations, schematics, diagrams and step-by-step procedures to properly service and diagnose the machine to the manufacturer's standards.

**Contents:**

- General Information
- Specifications
- Serial Number Location
- Engine Specifications
- Engine Diagnostics
- Engine Tests and Adjustments
- Engine Repair
- Power Train
- Transmission
- Axles
- Differential
- PTO
- Hydraulic System
- Electrical System
- Electrical Tests and Diagnostics
- Wiring Diagram / Schematic
- Ignition and Charging
- Steering
- Brakes
- Wheels
- Operator's Platform
- Body Panels
- Disassembly and Assembly
- Diagnostics, Tests and Adjustments
- Troubleshooting
- and much more...

Please note this manual is in **downloadable PDF format only**. If you have any questions about this product or would like to request sample pages, please contact us and reference the product name or SKU.

# Axle Circulation System

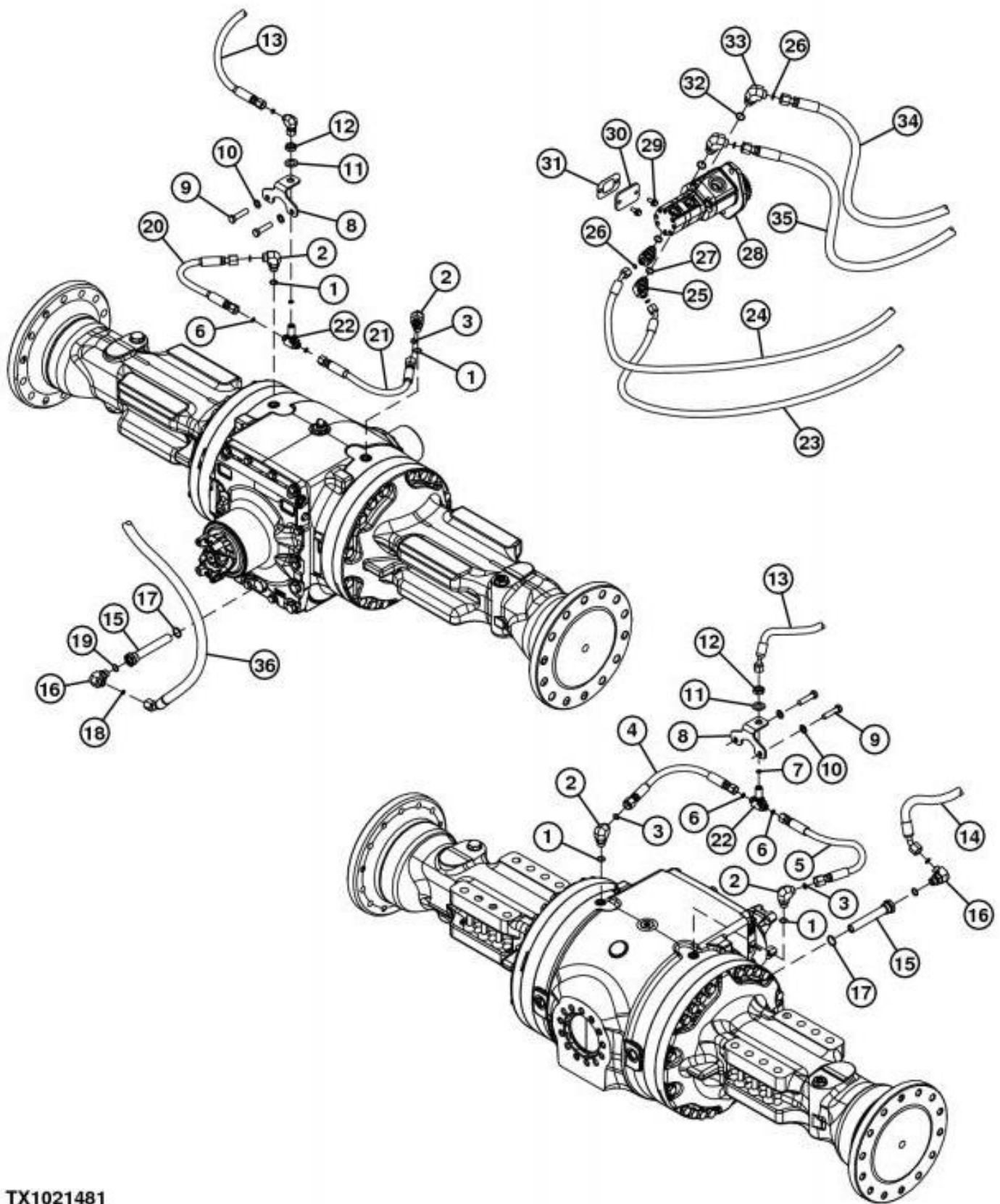

TX1021481

## Axle Circulation System

### LEGEND:

- |   |                        |
|---|------------------------|
| 1 | O-Ring (4 used)        |
| 2 | Elbow Fitting (4 used) |
| 3 | O-Ring (4 used)        |
| 4 | Hydraulic Hose         |



Thank you very much  
for your reading.  
Please click here  
to get more information.