

John Deere 1700, 1705, 1720, 1725 Twin Row Planter Diagnostic and Tests Service Manual (TM111319)

644J Loader (SN. from 611232) Repair



REPAIR TECHNICAL MANUAL

4WD Loaders models 644J (SN. 611232-)

TM10246 16 FEB 16 (ENGLISH)

For complete service information also see:

644J Loader (SN. from 611232) Diagnostic	TM10231
PowerTech 8.1 L Diesel Engines Base Engine	CTM86
Alternators and Starting Motors	CTM77
PowerTech E 4.5 and 6.8L Diesel Engines with 16 Electronic Fuel System With Denso HPCR	CTM502
TM1V1200 - 1400	
PowerTech 4045, 4055, 4065, 4075, 4085, 4095, 4105, 4115, 4125, 4135, 4145, 4155, 4165, 4175, 4185, 4195, 4205, 4215, 4225, 4235, 4245, 4255, 4265, 4275, 4285, 4295, 4305, 4315, 4325, 4335, 4345, 4355, 4365, 4375, 4385, 4395, 4405, 4415, 4425, 4435, 4445, 4455, 4465, 4475, 4485, 4495, 4505, 4515, 4525, 4535, 4545, 4555, 4565, 4575, 4585, 4595, 4605, 4615, 4625, 4635, 4645, 4655, 4665, 4675, 4685, 4695, 4705, 4715, 4725, 4735, 4745, 4755, 4765, 4775, 4785, 4795, 4805, 4815, 4825, 4835, 4845, 4855, 4865, 4875, 4885, 4895, 4905, 4915, 4925, 4935, 4945, 4955, 4965, 4975, 4985, 4995, 5005	
Denso High Pressure Common Rail	
Super Caddy Oil Cleanup Products	
PowerTech 8.1L Diesel Engines with 16 Electronic Fuel System with Denso High Pressure Common Rail	CTM255
TeamMate III 1000, 1200, and 1400 Series Inboard Planetary Axles	CTM150
120 Series Hydraulic Cylinders	CTM120519
185 Series Hydraulic Cylinders	CTM114919
120 Series Hydraulic Cylinders	CTM114319
PowerTech 4.5L & 6.8L Diesel Engines Tier 1/Stage I, Tier 2/Stage II, Tier 3/Stage IIIA, Tier 3/Stage IIA Tier 3/Stage III, (Base Engine)	CTM104

PDF



DOWNLOAD



John Deere Construction and Forestry
Printed by Belgreen



TM10246

Covers: 1700,1705,1720,1725

Type: Service Manual

Language: English

Pages: 542

Format: PDF

Features: Bookmarked, searchable, printable

Compatibility: Windows/Mac/Tablet/Mobile

This service manual contains important information for the maintenance, troubleshooting and servicing of the **John Deere 1700, 1705, 1720, 1725 Twin Row Planter Diagnostic and Tests Service Manual (TM111319)**

In this manual you will find detailed specifications, illustrations, schematics, diagrams and step-by-step procedures to properly service and diagnose the machine to the manufacturer's standards.

Contents:

- General Information
- Specifications
- Serial Number Location
- Engine Specifications
- Engine Diagnostics
- Engine Tests and Adjustments
- Engine Repair
- Power Train
- Transmission
- Axles
- Differential
- PTO
- Hydraulic System
- Electrical System
- Electrical Tests and Diagnostics
- Wiring Diagram / Schematic
- Ignition and Charging
- Steering
- Brakes
- Wheels
- Operator's Platform
- Body Panels
- Disassembly and Assembly
- Diagnostics, Tests and Adjustments
- Troubleshooting
- and much more...

Please note this manual is in **downloadable PDF format only**. If you have any questions about this product or would like to request sample pages, please contact us and reference the product name or SKU.

Axle Circulation System

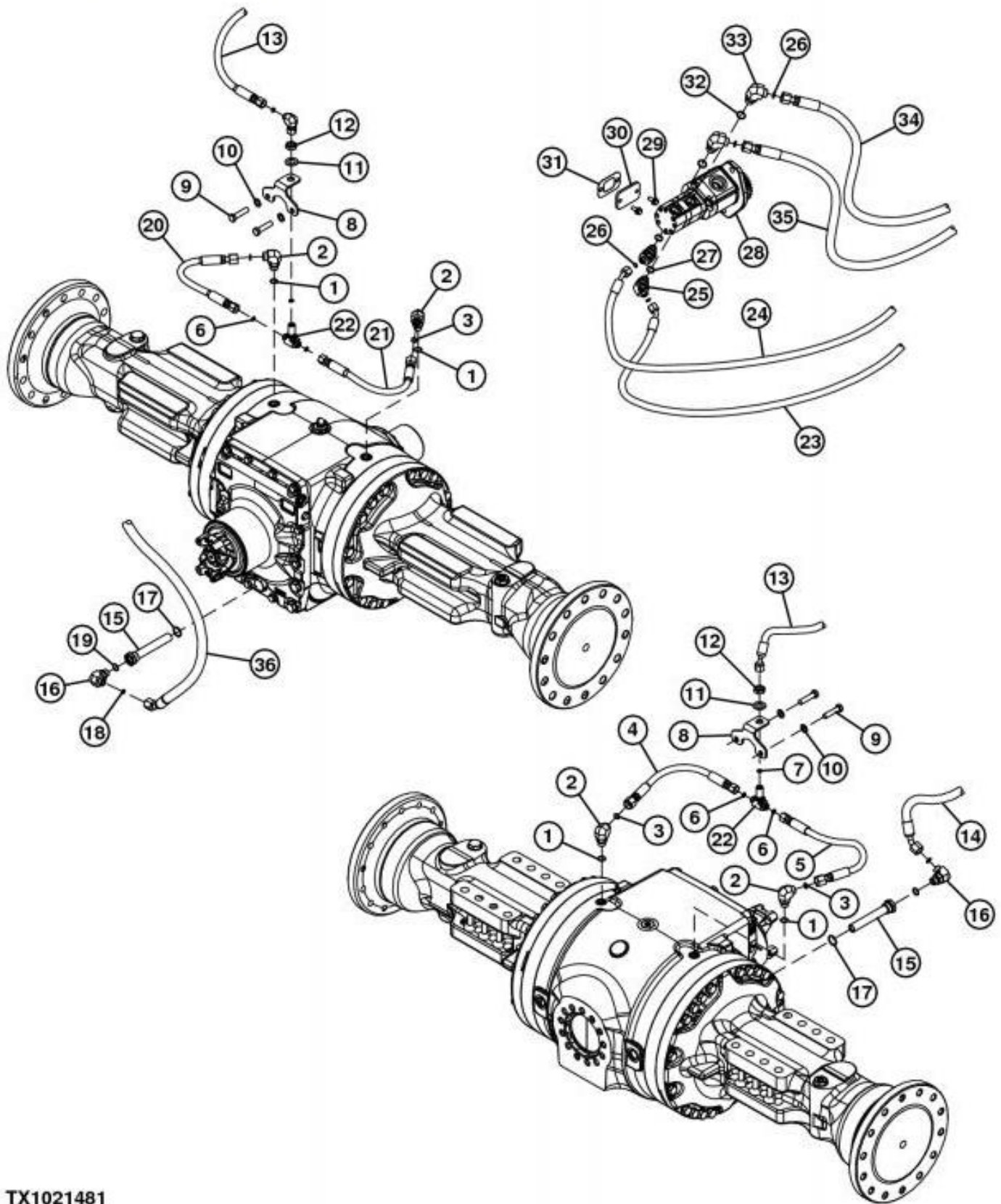

TX1021481

Axle Circulation System

LEGEND:

- | | |
|---|------------------------|
| 1 | O-Ring (4 used) |
| 2 | Elbow Fitting (4 used) |
| 3 | O-Ring (4 used) |
| 4 | Hydraulic Hose |



Thank you very much
for your reading.
Please click here
to get more information.