

John Deere 3028EN, 3036E, 3036EN (1PY) Compact Utility Tractors All Inclusive Technical Manual (TM902119)

3028EN, 3036E, 3036EN
Compact Utility Tractors
Diagnostic and Repair (July
2015)



TECHNICAL MANUAL

3028EN, 3036E, 3036EN Tractors (Asia)

TM902119 12 AUG 15 (ENGLISH)



John Deere Agriculture
Printed by Belgreen



Covers: 3028EN,3036E,3036EN

Type: Service Manual

Language: English

Pages: 779

Format: PDF

Features: Bookmarked, searchable, printable

Compatibility: Windows/Mac/Tablet/Mobile

This service manual contains important information for the maintenance, troubleshooting and servicing of the **John Deere 3028EN, 3036E, 3036EN (1PY) Compact Utility Tractors All Inclusive Technical Manual (TM902119)**

In this manual you will find detailed specifications, illustrations, schematics, diagrams and step-by-step procedures to properly service and diagnose the machine to the manufacturer's standards.

Contents:

- General Information
- Specifications
- Serial Number Location
- Engine Specifications
- Engine Diagnostics
- Engine Tests and Adjustments
- Engine Repair
- Power Train
- Transmission
- Axles
- Differential
- PTO
- Hydraulic System
- Electrical System
- Electrical Tests and Diagnostics
- Wiring Diagram / Schematic
- Ignition and Charging
- Steering
- Brakes
- Wheels
- Operator's Platform
- Body Panels
- Disassembly and Assembly
- Diagnostics, Tests and Adjustments
- Troubleshooting
- and much more...

Please note this manual is in **downloadable PDF format only**. If you have any questions about this product or would like to request sample pages, please contact us and reference the product name or SKU.

Group 15 - Theory of Operation

Brake System Operation

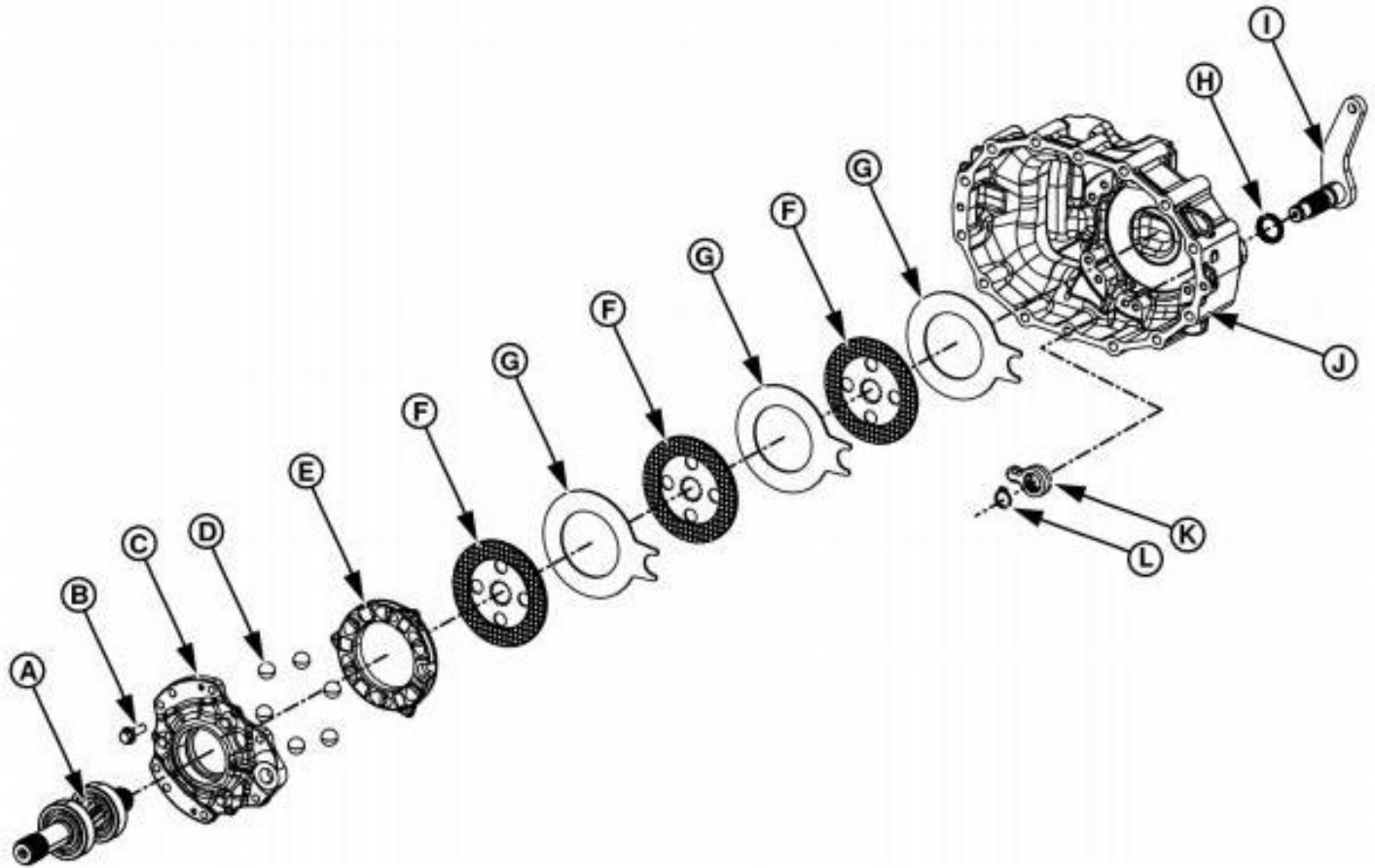

Left-hand side Brake Assembly Shown; Right-hand Side Brake Assembly is Similar

LEGEND:

- A Pinion Shaft, Final Drive
- B Cap Screw (8 used each side of brake assembly)
- C Brake Retainer
- D Steel Ball (6 used each side of brake assembly)
- E Brake Actuating Disk/Actuator
- F Brake Disks/Friction Disk(3 used each side of brake assembly)
- G Brake Separator Disk (3 used each side of axle)
- H Oil Seal
- I Brake Lever, Left-hand Side
- J Rear Axle Housing, Left-hand Side
- K Cam, Brake Actuation
- L Snap Ring

FUNCTION:

To provide a means of stopping the tractor and assist the operator when maneuvering the tractor through tight turns. Park brake engagement locks the brake pedals to provide for safe parking of tractor.

MAJOR COMPONENTS:

- Brake Retainer/Housing
- Brake Actuating Disk
- Steel Balls
- Brake Cam
- Brake Separator Disk
- Brake Disks
- Brake Leve
- Rear Axle Housing

THEORY OF OPERATION:



Thank you very much
for your reading.
Please click here
to get more information.