

John Deere 457s, 467s Silage Special; 447, 457, 467, 547, 557, 567 Round Balers Repair Manual TM2203

**Combines W540,
W550, W650,
W660, T550,
T560, T660, T670,
C670 Diagnostics**

OPERATION AND TEST MANUAL

**Combines models C670, T550, T560, T660, T670, W540, W550, W650,
W660**

TM401619 11 MAR 08 (ENGLISH)

For complete service information also see:

W540, W550, W650, W660, T550, T560, T660, T670 and C670 Including HillMaster Combines Repair (European Edition)	TM401519
Alternators and Starting Motors	CTM77
CTM441 - Machine Connection Information	CTM441
PowerTech 9.0 L Diesel Engine Base Engine Repair	
PowerTech 9.0 L Diesel Engine Electronic Fuel System W	
PowerTech Plus 4.5L and 6.8L Engines Level 14 Electronic Fuel Injection With Denso HPCR	CTM320
PowerTech 4.5L & 6.8L Diesel Engines Tier 1/Stage I, Tier 2/Stage II, Tier 3/Stage IIIA, Tier 3/Stage IIA Tier 3/Stage III, (Base Engine)	CTM104



DOWNLOAD



John Deere Agriculture

Covers: 300001);,447,457,457S,467,467S,547,557,567

Type: Service Manual

Language: English

Pages: 887

Format: PDF

Features: Bookmarked, searchable, printable

Compatibility: Windows/Mac/Tablet/Mobile

This service manual contains important information for the maintenance, troubleshooting and servicing of the **John Deere 457s, 467s Silage Special; 447, 457, 467, 547, 557, 567 Round Balers Repair Manual TM2203**

In this manual you will find detailed specifications, illustrations, schematics, diagrams and step-by-step procedures to properly service and diagnose the machine to the manufacturer's standards.

Contents:

- General Information
- Specifications
- Serial Number Location
- Engine Specifications
- Engine Diagnostics
- Engine Tests and Adjustments
- Engine Repair
- Power Train
- Transmission
- Axles
- Differential
- PTO
- Hydraulic System
- Electrical System
- Electrical Tests and Diagnostics
- Wiring Diagram / Schematic
- Ignition and Charging
- Steering
- Brakes
- Wheels
- Operator's Platform
- Body Panels
- Disassembly and Assembly
- Diagnostics, Tests and Adjustments
- Troubleshooting
- and much more...

Please note this manual is in **downloadable PDF format only**. If you have any questions about this product or would like to request sample pages, please contact us and reference the product name or SKU.

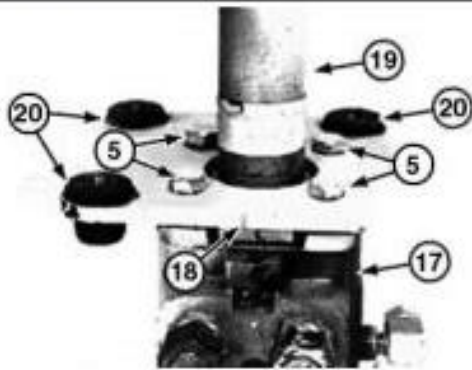
**LEGEND:**

- 6 Nut and Washer (3 used)
- 7 Cap Screw (3 used)
- 8 Dual Mode Steering Solenoid Valve-to-Steering Valve Pressure Hose
- 9 Port LS-to-Priority Valve Port LS Line
- 15 Mounting Plate (Dual Mode Steering)
- 16 Adapter Plate
- 17 Steering Valve
- 18 Mounting Plate (Standard Steering)
- 19 Lower Steering Column
- 20 Rubber Isolators (3 Used)

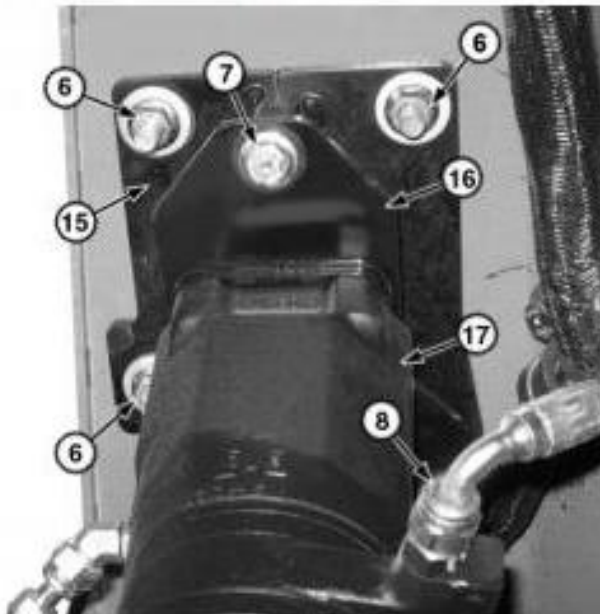
Steering Valve Mounting—Standard Steering**Steering Valve Mounting—Dual Mode Steering**

Remove nuts and washers (6) and remove steering valve (17) lower steering column, mounting plate (15), and adapter plate (16) (Dual Mode Steering machines only). Seal may come with the valve or remain stuck to the platform.

[8] - For machines equipped with standard steering, remove cap screws (5) and separate steering valve from mounting plate (18) and lower steering column.

For machine equipped with dual mode steering, remove cap screws (7) and separate adapter plate (16) from mounting plate (15). Remove cap screws (5) and separate adapter plate (16) and lower steering column from steering valve.

[9] - For machines equipped with standard steering, inspect and repair parts as necessary. [See Steering Valve Disassemble and Assemble](#). (Group 0960.)

For machines equipped with dual mode steering, inspect and replace parts as necessary.

[10] -

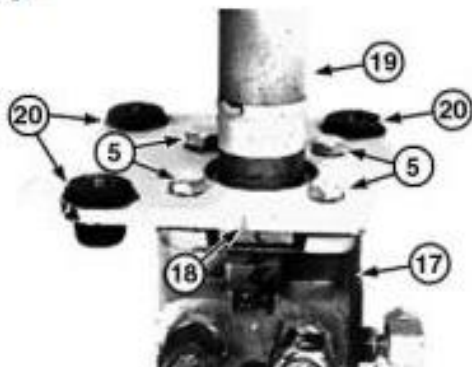
**LEGEND:**

- 5 Cap Screw (4 used)
- 17 Steering Valve
- 18 Mounting Plate (Standard Steering)
- 19 Lower Steering Column
- 20 Rubber Isolators (3 Used)

Lower Steering Column Installation (standard steering shown)



Thank you very much
for your reading.
Please click here
to get more information.