

John Deere 5076E,5076EL, 5082E, 5090E, 5090EL,5090EH Tractors Diagnostic Technical Manual (TM609519)

5090R, 5100R, 5115R,
5115RH and 5125R (FT4/
Stage IIIB) Tractors
Diagnostic



JOHN HARE



COLLECTION

DIAGNOSTIC TECHNICAL MANUAL 5R Series Tractors

TM143419 01DEC18 (ENGLISH)



John Deere Augusta Works

Covers: 2016);,5076E,5076EL,5082E,5090E,5090EL,5090EH

Type: Service Manual

Language: English

Pages: 736

Format: PDF

Features: Bookmarked, searchable, printable

Compatibility: Windows/Mac/Tablet/Mobile

This service manual contains important information for the maintenance, troubleshooting and servicing of the **John Deere 5076E,5076EL, 5082E, 5090E, 5090EL,5090EH Tractors Diagnostic Technical Manual (TM609519)**

In this manual you will find detailed specifications, illustrations, schematics, diagrams and step-by-step procedures to properly service and diagnose the machine to the manufacturer's standards.

Contents:

- General Information
- Specifications
- Serial Number Location
- Engine Specifications
- Engine Diagnostics
- Engine Tests and Adjustments
- Engine Repair
- Power Train
- Transmission
- Axles
- Differential
- PTO
- Hydraulic System
- Electrical System
- Electrical Tests and Diagnostics
- Wiring Diagram / Schematic
- Ignition and Charging
- Steering
- Brakes
- Wheels
- Operator's Platform
- Body Panels
- Disassembly and Assembly
- Diagnostics, Tests and Adjustments
- Troubleshooting
- and much more...

Please note this manual is in **downloadable PDF format only**. If you have any questions about this product or would like to request sample pages, please contact us and reference the product name or SKU.

Brakes - Brake Pistons, Plates, and Disks Theory of Operation

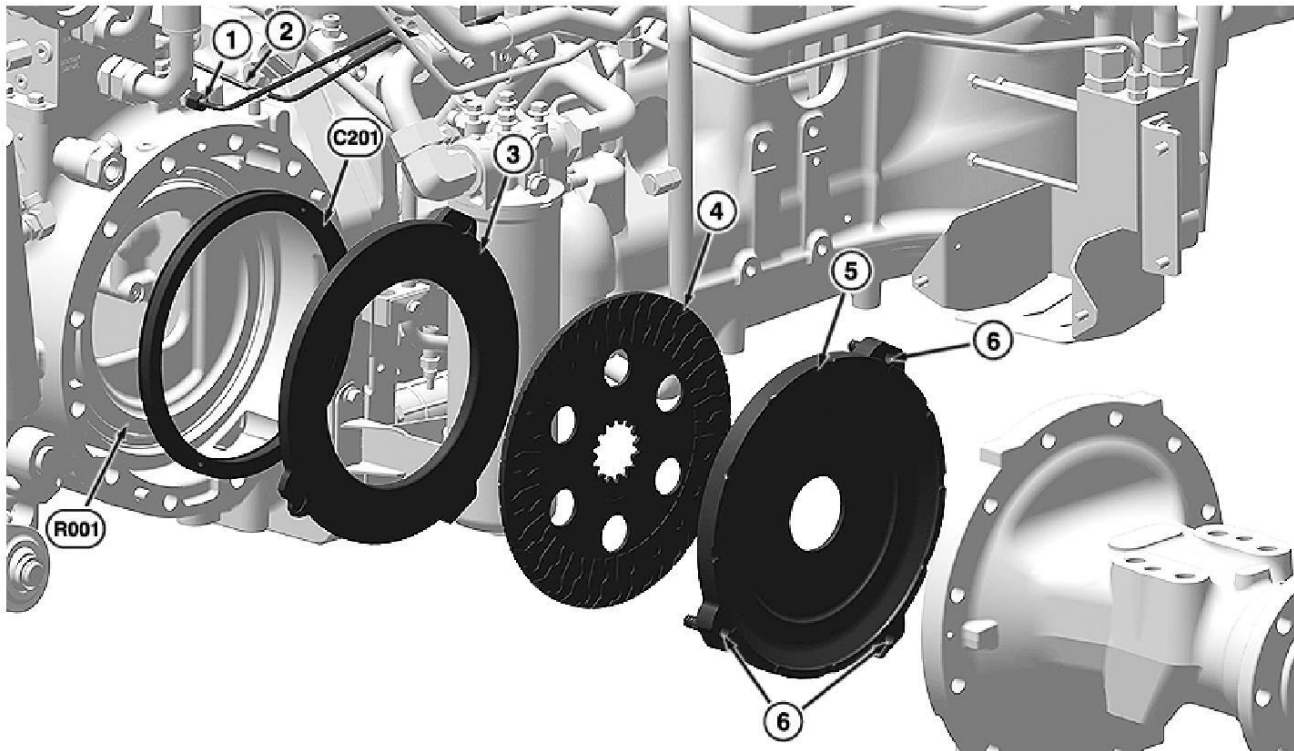

RXA0153369-UN: Rear Axle Brake Parts

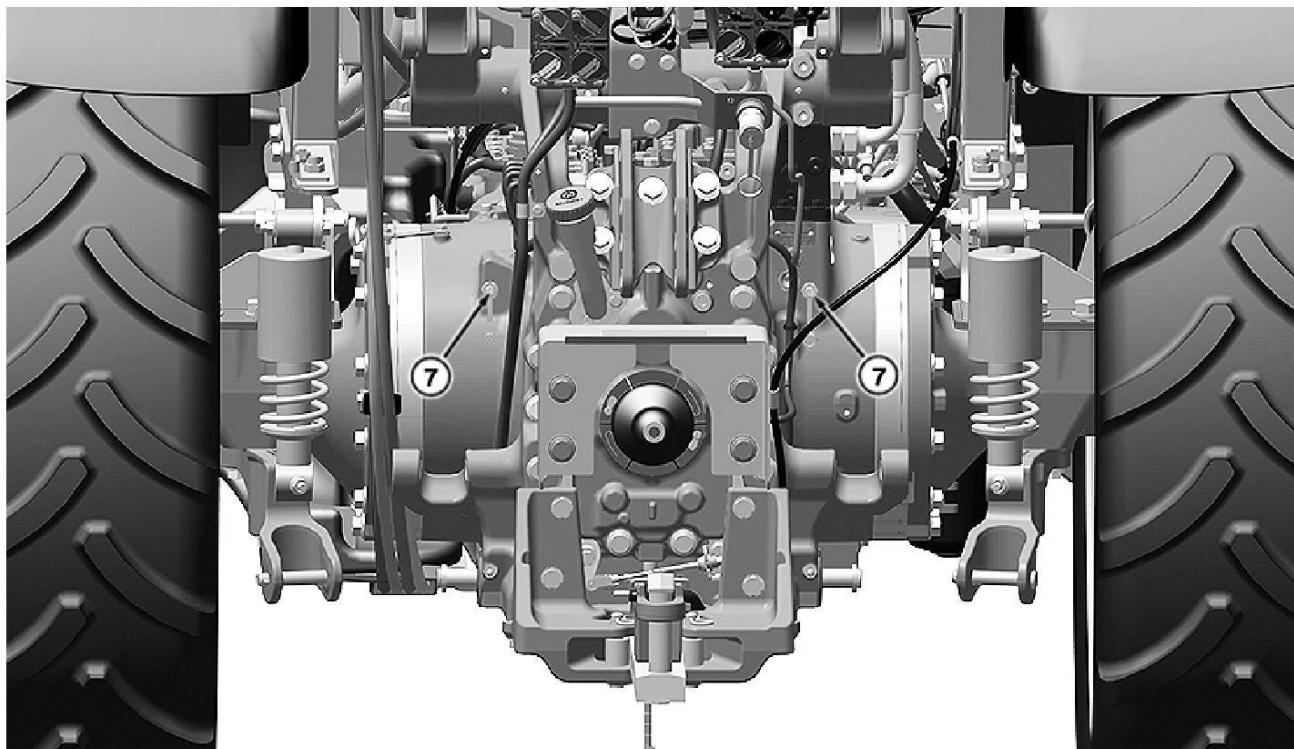

RXA0153390-UN: Brake Bleed Fittings

LEGEND:

C201-Right Brake Piston

R001-Differential Case

1-Right Brake Pressure Inlet

2-Left Brake Pressure Inlet

3-Inner Brake Backing Plate

4-Brake Disk

5-Outer Brake Backing Plate

6-Brake Retractor (3 used)

7-Brake Bleed Fitting (2 used)

Two brake assemblies are mounted on rear axle. Each brake assembly is located between final drive and differential case (R001). Brake disk (4) is splined to sun gear pinion shaft. Tabs on brake backing plates (3 and 5) prevent rotation.

Force applied to left brake pedal moves brake valve plunger, sending pressure oil to left brake pressure inlet (2). Force applied to right brake pedal moves brake valve plunger, sending pressure oil to right brake pressure inlet (1). Oil flows through inlet and oil passage in differential case to cavity behind piston. Piston moves out, squeezing disk against brake backing plate, stopping rotation of disk and sun gear pinion shaft.



Thank you very much
for your reading.
Please click here
to get more information.