

John Deere 5090R, 5100R, 5115R, 5115RH, 5125R Tractors Repair Technical Service Manual (TM143519)

653G Feller Buncher Repair
(SN. before 880059)



REPAIR TECHNICAL MANUAL
Track models 653G (SN.-880059)
TM1775 22 FEB 05 (ENGLISH)

For complete service information also see:

653G Feller Buncher (SN. before 880059) Diagnostic
Alternators and Starting Motors

TM1774

CTM77

PowerTech 4.5L & 6.8L Diesel Engines Tier 1/Stage I, Tier 2/Stage II, Tier 3/Stage
IIIA, Tier 3/Stage IIA Tier 3/Stage III, (Base Engine)

CTM104



John Deere Construction and Forestry
Printed by Belgreen



Covers: 5090R,5100R,5115R,5115RH,5125R

Type: Service Manual

Language: English

Pages: 553

Format: PDF

Features: Bookmarked, searchable, printable

Compatibility: Windows/Mac/Tablet/Mobile

This service manual contains important information for the maintenance, troubleshooting and servicing of the **John Deere 5090R, 5100R, 5115R, 5115RH, 5125R Tractors Repair Technical Service Manual (TM143519)**

In this manual you will find detailed specifications, illustrations, schematics, diagrams and step-by-step procedures to properly service and diagnose the machine to the manufacturer's standards.

Contents:

- General Information
- Specifications
- Serial Number Location
- Engine Specifications
- Engine Diagnostics
- Engine Tests and Adjustments
- Engine Repair
- Power Train
- Transmission
- Axles
- Differential
- PTO
- Hydraulic System
- Electrical System
- Electrical Tests and Diagnostics
- Wiring Diagram / Schematic
- Ignition and Charging
- Steering
- Brakes
- Wheels
- Operator's Platform
- Body Panels
- Disassembly and Assembly
- Diagnostics, Tests and Adjustments
- Troubleshooting
- and much more...

Please note this manual is in **downloadable PDF format only**. If you have any questions about this product or would like to request sample pages, please contact us and reference the product name or SKU.

Disassemble Propel Motor

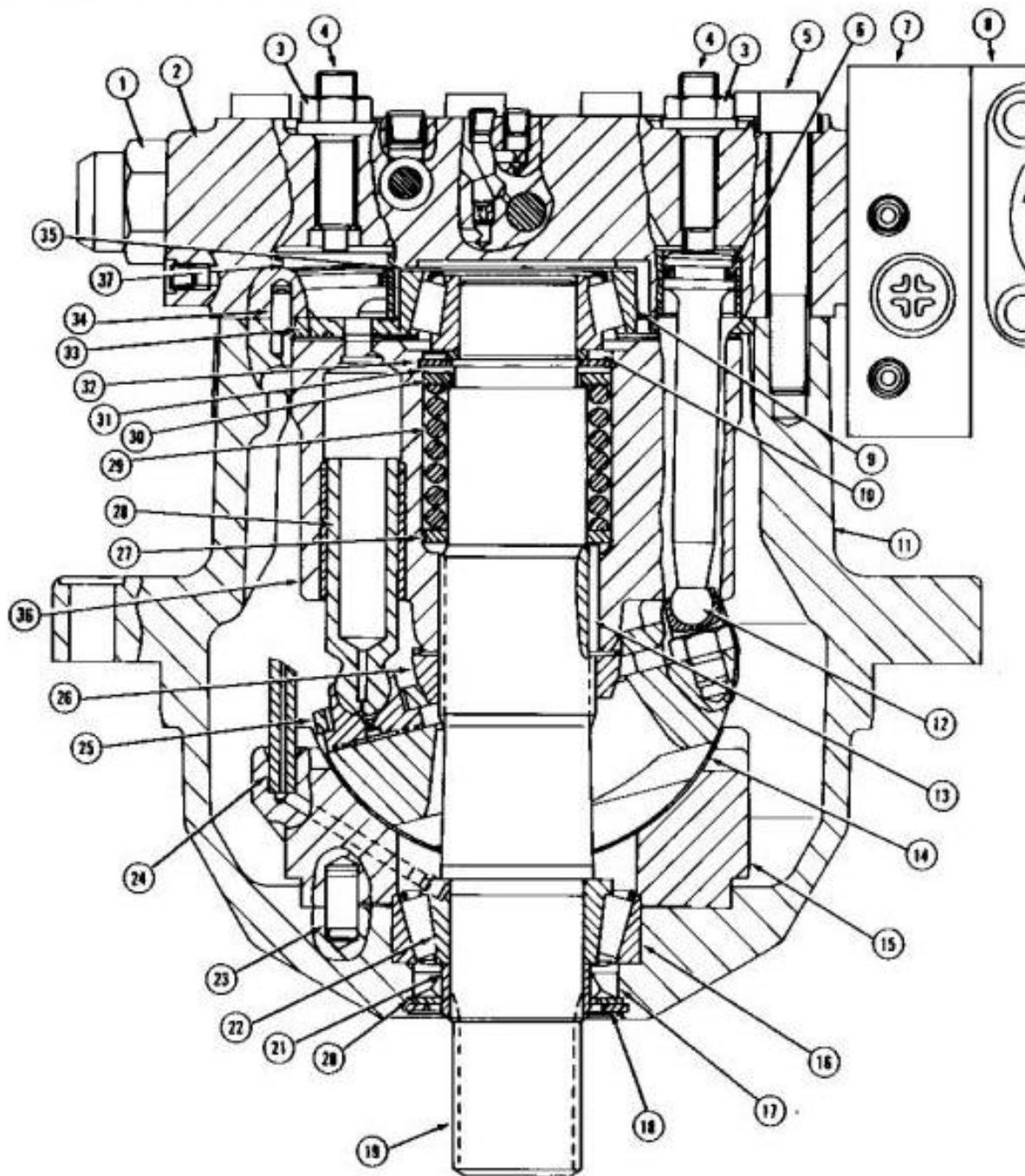

Assembly for Propel Motor

LEGEND:

- | | |
|----|---------------------------------|
| 1 | Crossover Relief Valve |
| 2 | Valve Housing and Cover |
| 3 | Seal Nut (do not remove) |
| 4 | Adjusting Screw (do not remove) |
| 5 | Cap Screw (9 used) |
| 6 | Piston Ring |
| 7 | Supply Shuttle Valve |
| 8 | Counterbalance Valve |
| 9 | Bearing Cup |
| 10 | Bearing Cone |
| 11 | Motor Housing |
| 12 | Minimum Displacement Piston |
| 13 | Needle Bearing (3 used) |
| 14 | Swash Plate |



Thank you very much
for your reading.
Please click here
to get more information.