

John Deere 5215F, 5315F, 5515F, 5615F, 5215V, 5315V, 5515V, 5615V Tractor Technical Service Manual TM4861

**5215F/V, 5315F/V,
5515F/V, 5615F/V
Tractor
(Diagnostics)**

TECHNICAL MANUAL

5215F, 5315F, 5615F, 5515F, 5215V, 5315V, 561/V, 5515V

TM4861 27JUL10 (ENGLISH)

For complete service information also see:

Alternators and Starting Motors	CTM77
00.16, 20.09, 20.09C, 20.11, 20.16, G20.16 and G20.09 Front Wheel Drive Axles	CTM4870
PowerTech 4.5L and 6.8L Diesel Engines Mechanical Fuel Systems	CTM207
PowerTech 2.9L Diesel Engines	CTM125
PowerTech 4.5L Tier 1/Stage I, T IIIA, Tier 3/Stage Engine)	

PDF



DOWNLOAD



John Deere Agriculture

Covers: 5215F,5315F,5515F,5615F,5215V,5315V,5515V,5615V

Type: Service Manual

Language: English

Pages: 2242

Format: PDF

Features: Bookmarked, searchable, printable

Compatibility: Windows/Mac/Tablet/Mobile

This service manual contains important information for the maintenance, troubleshooting and servicing of the **John Deere 5215F, 5315F, 5515F, 5615F, 5215V, 5315V, 5515V, 5615V Tractor Technical Service Manual TM4861**

In this manual you will find detailed specifications, illustrations, schematics, diagrams and step-by-step procedures to properly service and diagnose the machine to the manufacturer's standards.

Contents:

- General Information
- Specifications
- Serial Number Location
- Engine Specifications
- Engine Diagnostics
- Engine Tests and Adjustments
- Engine Repair
- Power Train
- Transmission
- Axles
- Differential
- PTO
- Hydraulic System
- Electrical System
- Electrical Tests and Diagnostics
- Wiring Diagram / Schematic
- Ignition and Charging
- Steering
- Brakes
- Wheels
- Operator's Platform
- Body Panels
- Disassembly and Assembly
- Diagnostics, Tests and Adjustments
- Troubleshooting
- and much more...

Please note this manual is in **downloadable PDF format only**. If you have any questions about this product or would like to request sample pages, please contact us and reference the product name or SKU.

Inspect and Replace Hydraulic Suction Lines

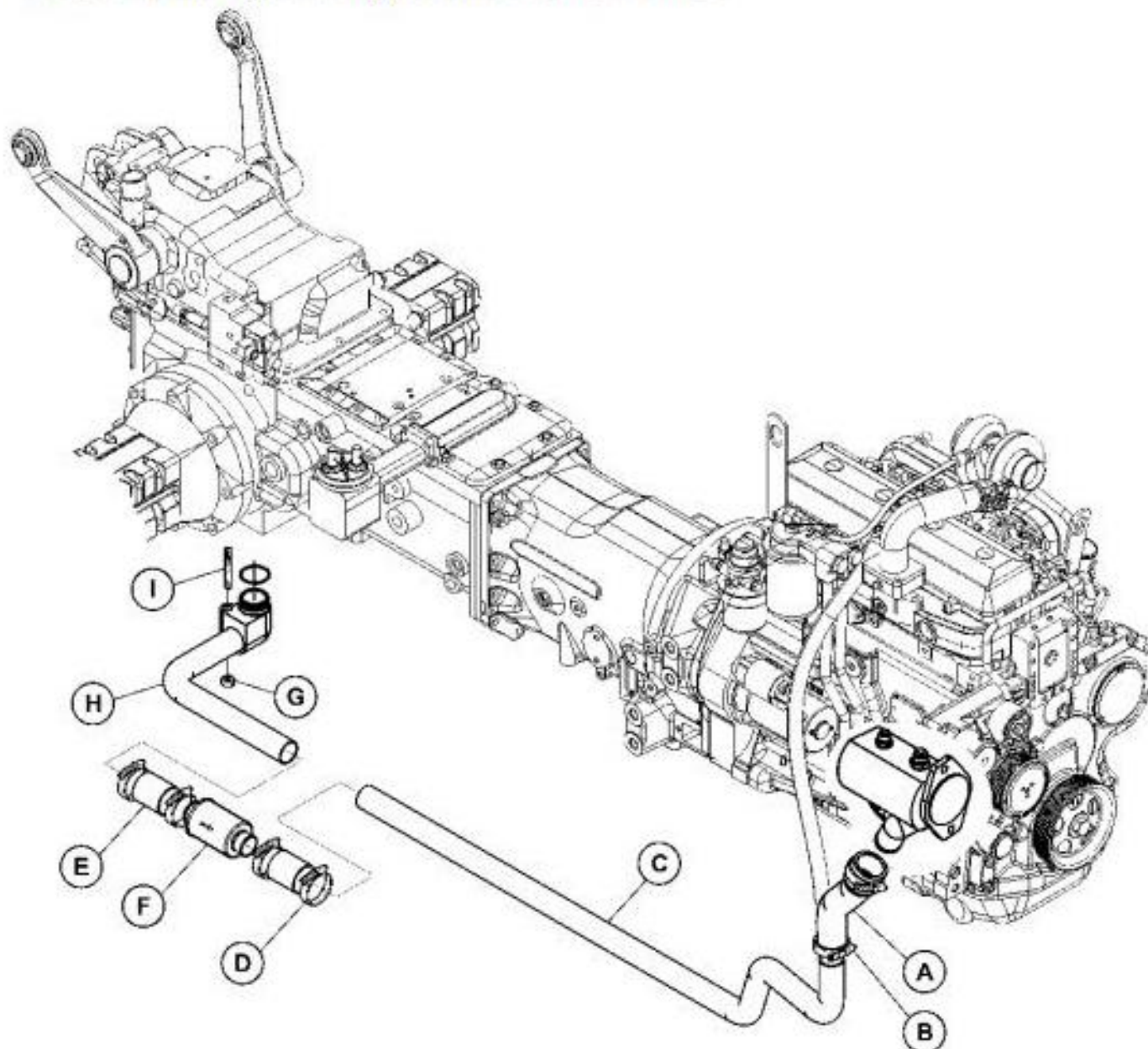

AT15135

Hydraulic suction lines

LEGEND:

A	Hose
B	Clamp (2 used)
C	Suction line
D	Clamp (4 used)
E	Hose (2 used)
F	Filter
G	Nut
H	Suction line
I	Stud

Inspect hydraulic lines and hoses for wear or damage. Replace as necessary.



Thank you very much
for your reading.
Please click here
to get more information.