

John Deere 670G, 670GP, 672G, 672GP Motor Grader (SN.656729-) Diagnostic Service Manual (TM13065X19)



17 Series Twin Row Planter
Diagnosis and Tests

JOHN HARE

COLLECTION

DIAGNOSIS AND TESTS MANUAL
Twin Row Planter models 1700, 1705, 1720, 1725, 1700, 1720
TM111319 23 JAN 15 (ENGLISH)

For complete service information also see:

1700 Series Drawn and Integral Planters (SN.-740100) Repair	TM1721
1705 Series Planter Frame Repair	TM131319
MaxEmerge 5 & ExactEmerge Row Unit Repair	TM131219
1700 Series Drawn and Integral Planters (SN.740101-) Repair	TM124719
Machine Connect	CTM441
120 Series Hydraulic System	
100 Series Hydraulic System	

  **DOWNLOAD**

John Deere Agriculture
Printed by Belgreen

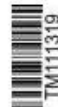
Covers: 670G,1DW670G***C656729-;,1DW670G***D656729-),670GP,1DW6

Type: Service Manual

Language: English

Pages: 1660

Format: PDF

Features: Bookmarked, searchable, printable

Compatibility: Windows/Mac/Tablet/Mobile

This service manual contains important information for the maintenance, troubleshooting and servicing of the **John Deere 670G, 670GP, 672G, 672GP Motor Grader (SN.656729-) Diagnostic Service Manual (TM13065X19)**

In this manual you will find detailed specifications, illustrations, schematics, diagrams and step-by-step procedures to properly service and diagnose the machine to the manufacturer's standards.

Contents:

- General Information
- Specifications
- Serial Number Location
- Engine Specifications
- Engine Diagnostics
- Engine Tests and Adjustments
- Engine Repair
- Power Train
- Transmission
- Axles
- Differential
- PTO
- Hydraulic System
- Electrical System
- Electrical Tests and Diagnostics
- Wiring Diagram / Schematic
- Ignition and Charging
- Steering
- Brakes
- Wheels
- Operator's Platform
- Body Panels
- Disassembly and Assembly
- Diagnostics, Tests and Adjustments
- Troubleshooting
- and much more...

Please note this manual is in **downloadable PDF format only**. If you have any questions about this product or would like to request sample pages, please contact us and reference the product name or SKU.

Axle Circulation System

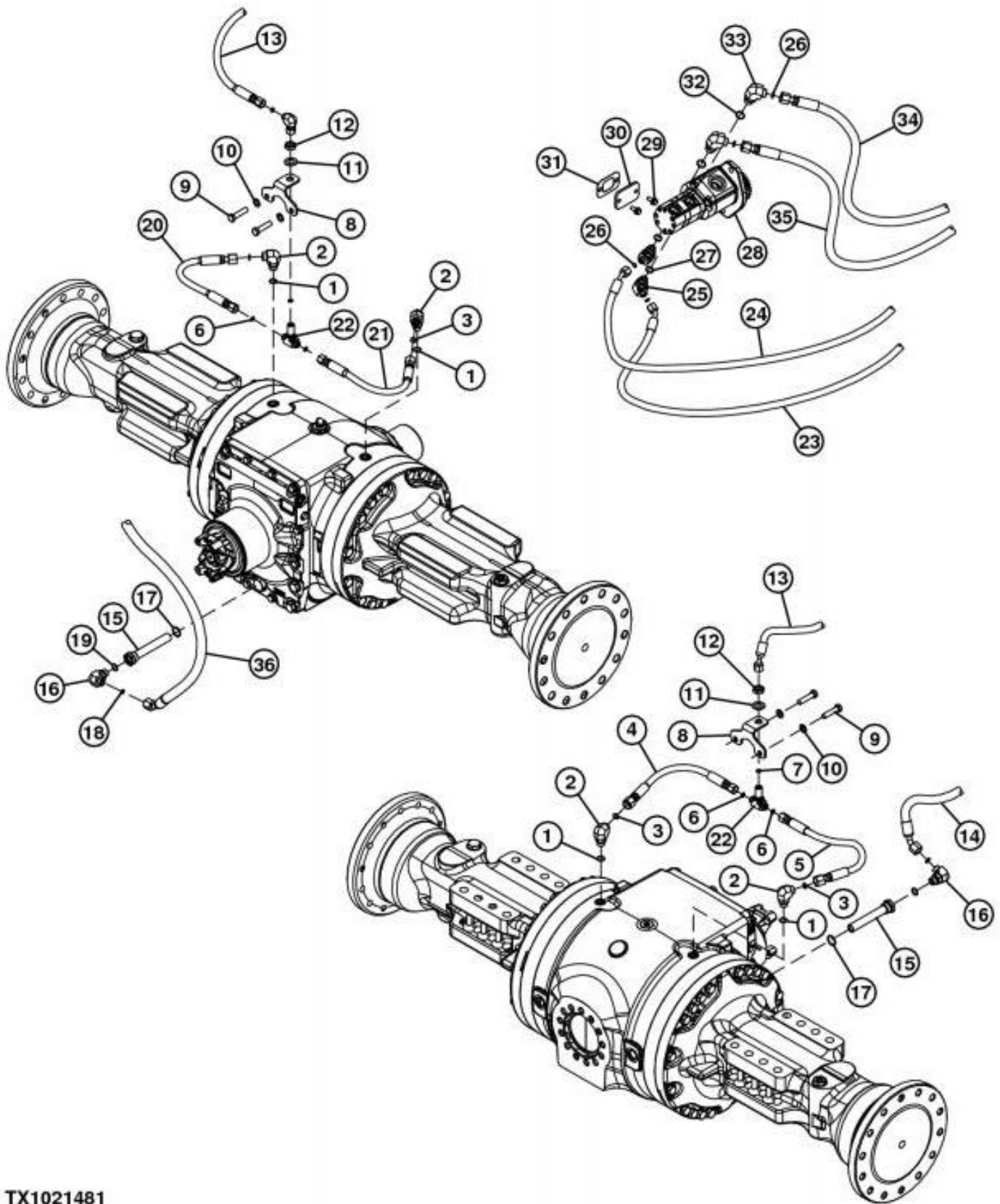

TX1021481

Axle Circulation System

LEGEND:

- | | |
|---|------------------------|
| 1 | O-Ring (4 used) |
| 2 | Elbow Fitting (4 used) |
| 3 | O-Ring (4 used) |
| 4 | Hydraulic Hose |



Thank you very much
for your reading.
Please click here
to get more information.