

John Deere 7200R, 7215R, 7230R, 7260R, 7280R Tractors Diagnosis and Tests Service Manual (TM110019)

**R4023 Self-Propelled
Sprayer Diagnosis and
Tests**
(SN. 180001—)



JOHN HARE



COLLECTION

DIAGNOSTIC TECHNICAL MANUAL
R4023 Self-Propelled Sprayer Diagnosis and Tests
(SN. 180001—)

TM146019 01DEC18 (ENGLISH)



John Deere Des Moines
Works

Covers: 000101-,15200);,7200R,7215R,7230R,7260R,7280R

Type: Service Manual

Language: English

Pages: 6433

Format: PDF

Features: Bookmarked, searchable, printable

Compatibility: Windows/Mac/Tablet/Mobile

This service manual contains important information for the maintenance, troubleshooting and servicing of the **John Deere 7200R, 7215R, 7230R, 7260R, 7280R Tractors Diagnosis and Tests Service Manual (TM110019)**

In this manual you will find detailed specifications, illustrations, schematics, diagrams and step-by-step procedures to properly service and diagnose the machine to the manufacturer's standards.

Contents:

- General Information
- Specifications
- Serial Number Location
- Engine Specifications
- Engine Diagnostics
- Engine Tests and Adjustments
- Engine Repair
- Power Train
- Transmission
- Axles
- Differential
- PTO
- Hydraulic System
- Electrical System
- Electrical Tests and Diagnostics
- Wiring Diagram / Schematic
- Ignition and Charging
- Steering
- Brakes
- Wheels
- Operator's Platform
- Body Panels
- Disassembly and Assembly
- Diagnostics, Tests and Adjustments
- Troubleshooting
- and much more...

Please note this manual is in **downloadable PDF format only**. If you have any questions about this product or would like to request sample pages, please contact us and reference the product name or SKU.

Solution System Configuration

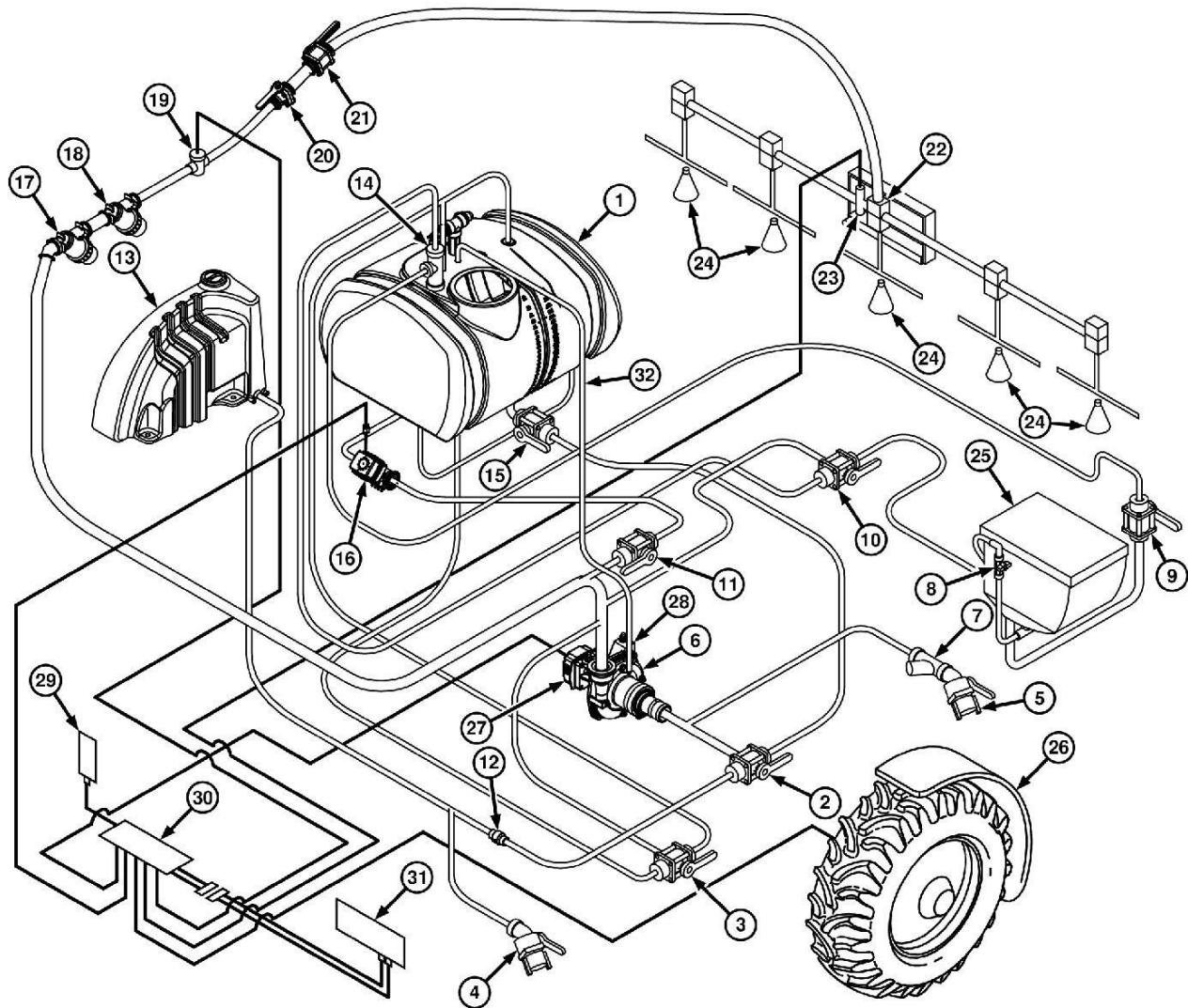

N81786-UN: Solution System Configuration

LEGEND:

- | | | |
|------------------------------------|---|---|
| 1-Solution Tank | 13-Rinse Tank | 23-Pressure Transducer |
| 2-Suction Valve | 14-Eductor Venturi | 24-Spray Nozzles |
| 3-Bypass/Rinse Valve | 15-Shutoff Solution Outlet Valve | 25-Eductor Hopper |
| 4-Rinse Tank Quik-Fill Valve | 16-Agitation Solenoid Valve | 26-Wheel Speed Sensor (Left Rear Wheel) |
| 5-Solution System Quik-Fill Valve | 17-Boom Supply Line Strainer (50 Mesh Standard) | 27-Hydraulic Motor |
| 6-Centrifugal Pump | 18-Boom Supply Line Strainer (80 Mesh Optional) | 28-Proportional Valve |
| 7-Fill Strainer (30 Mesh Optional) | 19-Solution Flowmeter | 29-Radar |
| 8-Eductor Hopper Rinse Valve | 20-Orifice Valve | 30-CCU/SRC |
| 9-Eductor Hopper Valve | 21-Boom Shutoff Valve | 31-GreenStar Display |
| 10-Eductor Flow Rate Valve | 22-Boom Section Shutoff Valves | 32-Pump Bleed Line |
| 11-Agitation Flow Rate Valve | | |
| 12-Check Valve | | |

MC91421,000816C-19-20150326



Thank you very much
for your reading.
Please click here
to get more information.