

# John Deere 724K 4WD Loader (SN.C642718-658064;D642722-658064) Service Repair Technical Manual (TM12112)

724K 4WD Loaders with  
Engines 6090HDW03 (T3),  
6090HDW09 (S2) Repair



## REPAIR TECHNICAL MANUAL

4WD Loaders models 724K (PIN: 1DW724KZ\*\*C642718-658064;  
1DW724KZ\*\*D642722-658064)

TM12112 16 FEB 16 (ENGLISH)

### For complete service information also see:

724K 4WD Loaders with Engines 6090HDW03, 6090HDW09 Diagnostic	TM12110
JDLINK (MTG) Technical Manual	TM114519
Alternators and Starting Motors	CTM77
TM1V1200 - 1400	CTM442
PowerTech 9.0L Certified Base Engine	
PowerTech 6090 Diesel Engine High Pressure Common Rail	
120 Series Hydraulic Cylinders	CTM120519
185 Series Hydraulic Cylinders	CTM114919
120 Series Hydraulic Cylinders	CTM114319
125 Series Hydraulic Cylinders	CTM109319
COOLANT HEATER SERVICE MANUAL	CTM10090X19



John Deere Construction and Forestry  
Printed by Belgreen



**Covers:** 724K,1DW724KZ\*\*C642718-658064;;1DW724KZ\*\*D642722-658064

**Type:** Service Manual

**Language:** English

**Pages:** 469

**Format:** PDF

**Features:** Bookmarked, searchable, printable

**Compatibility:** Windows/Mac/Tablet/Mobile

This service manual contains important information for the maintenance, troubleshooting and servicing of the **John Deere 724K 4WD Loader (SN.C642718-658064;D642722-658064) Service Repair Technical Manual (TM12112)**

In this manual you will find detailed specifications, illustrations, schematics, diagrams and step-by-step procedures to properly service and diagnose the machine to the manufacturer's standards.

**Contents:**

- General Information
- Specifications
- Serial Number Location
- Engine Specifications
- Engine Diagnostics
- Engine Tests and Adjustments
- Engine Repair
- Power Train
- Transmission
- Axles
- Differential
- PTO
- Hydraulic System
- Electrical System
- Electrical Tests and Diagnostics
- Wiring Diagram / Schematic
- Ignition and Charging
- Steering
- Brakes
- Wheels
- Operator's Platform
- Body Panels
- Disassembly and Assembly
- Diagnostics, Tests and Adjustments
- Troubleshooting
- and much more...

Please note this manual is in **downloadable PDF format only**. If you have any questions about this product or would like to request sample pages, please contact us and reference the product name or SKU.

## Axle Circulation System Remove and Install—If Equipped

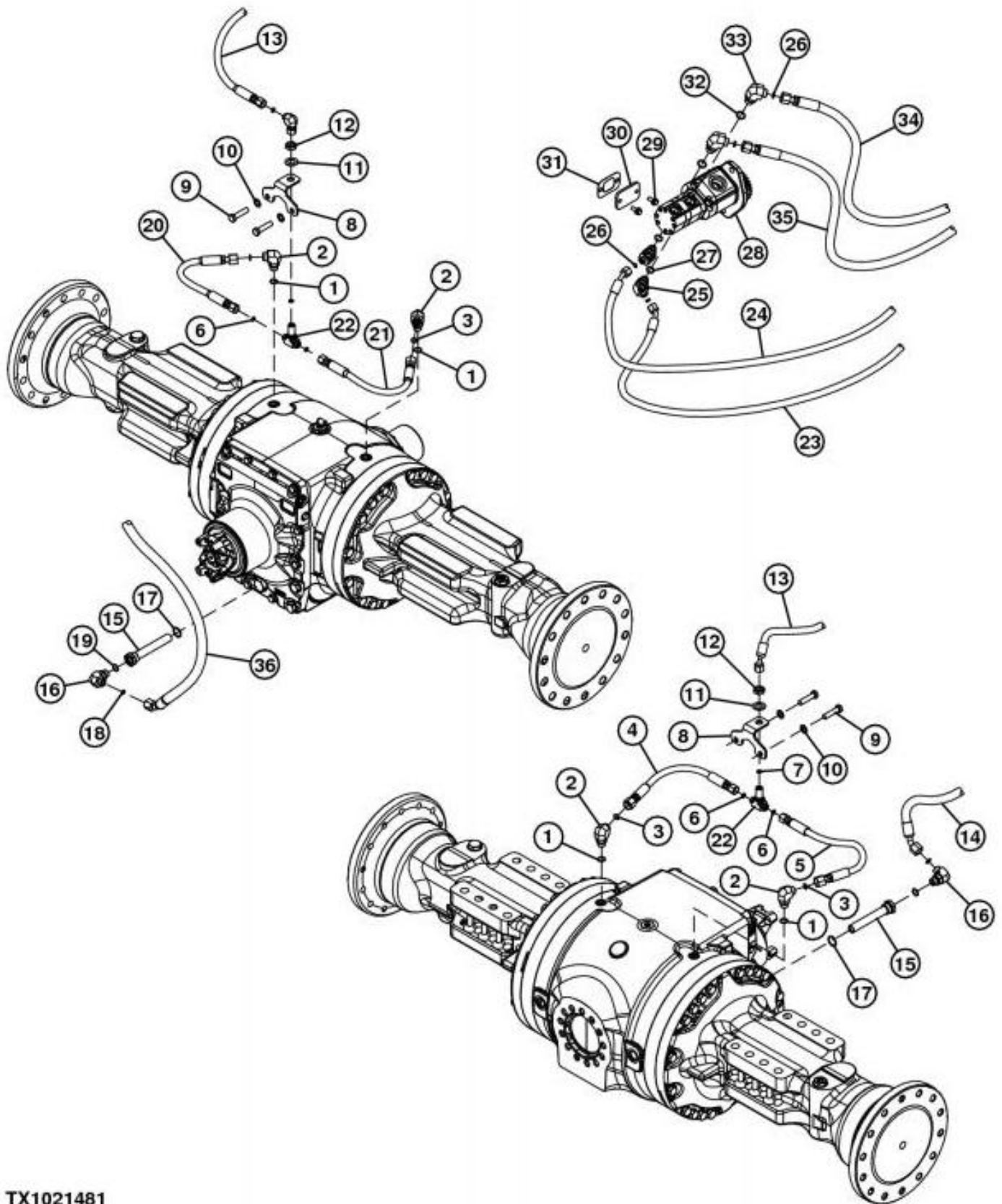

TX1021481

### Axle Circulation System

#### LEGEND:

- |   |                        |
|---|------------------------|
| 1 | O-Ring (4 used)        |
| 2 | Elbow Fitting (4 used) |
| 3 | O-Ring (4 used)        |
| 4 | Hydraulic Hose         |



Thank you very much  
for your reading.  
Please click here  
to get more information.