

John Deere 848L, 948L (SN.F666893◆◆◆◆◆◆◆◆690813) Skidder Service Repair Technical Manual (TM13138X19)

848L and 948L Skidders
(SN. F666893—690813)
Repair

JOHN HARE

COLLECTION

REPAIR TECHNICAL MANUAL

models 848L (PIN: 1DW848L*F666893—690813); 948L (PIN:
1DW948L***F666893—690813)**

TM13138X19 05 OCT 15 (ENGLISH)

For complete service information also see:

848L and 948L Skidders (SN. F666893—690813) Diagnostic	TM13137X19
JDLink (MTG) Technical Manual	TM114519
PowerTech 6090 Diesel Engine Level 1 & 2 Electronic Fuel System with the Denso High Pressure Common Rail Injection System	CTM385
40 and 4000 Winches	
TEAMMATE V 1700	
120 Series Hydraulic Cylinders	
6090 PowerTech™ OEM Diesel	

John Deere Construction and Forestry
Printed by Belgroot

TM13138X19

Covers: 848L,1DW848L***F666893◆◆◆◆◆◆◆◆690813),948L,1DW948L***F66

Type: Service Manual

Language: English

Pages: 480

Format: PDF

Features: Bookmarked, searchable, printable

Compatibility: Windows/Mac/Tablet/Mobile

This service manual contains important information for the maintenance, troubleshooting and servicing of the **John Deere 848L, 948L (SN.F666893◆◆◆◆◆◆690813) Skidder Service Repair Technical Manual (TM13138X19)**

In this manual you will find detailed specifications, illustrations, schematics, diagrams and step-by-step procedures to properly service and diagnose the machine to the manufacturer's standards.

Contents:

- General Information
- Specifications
- Serial Number Location
- Engine Specifications
- Engine Diagnostics
- Engine Tests and Adjustments
- Engine Repair
- Power Train
- Transmission
- Axles
- Differential
- PTO
- Hydraulic System
- Electrical System
- Electrical Tests and Diagnostics
- Wiring Diagram / Schematic
- Ignition and Charging
- Steering
- Brakes
- Wheels
- Operator's Platform
- Body Panels
- Disassembly and Assembly
- Diagnostics, Tests and Adjustments
- Troubleshooting
- and much more...

Please note this manual is in **downloadable PDF format only**. If you have any questions about this product or would like to request sample pages, please contact us and reference the product name or SKU.

Group 1160 - Hydraulic System

Park Brake Solenoid Valve Remove and Install

REMOVAL

[1] - Park and prepare machine for service. [See Park and Prepare for Service Safely](#). (Group 0001.)

[2] -



CAUTION:

To avoid injury from escaping fluid under pressure, stop engine and relieve the pressure in the system before disconnecting or connecting hydraulic or other lines. Tighten all connections before applying pressure.

Release hydraulic pressure. [See Hydraulic System Pressure Release](#). (Group 9025-25.)

[3] - Turn battery disconnect switch to OFF position.

[4] - Apply vacuum or drain hydraulic reservoir. [See D15032NU Vacuum Pump Kit Installation](#). (Group 9025-25.) Or [see Drain and Refill Hydraulic System Oil](#). (Operator's Manual.)

[5] - Tilt cab to obtain access to top of equipment frame. [See Hydraulic Cab Tilt Procedure](#). (Operator's Manual.)

[6] -

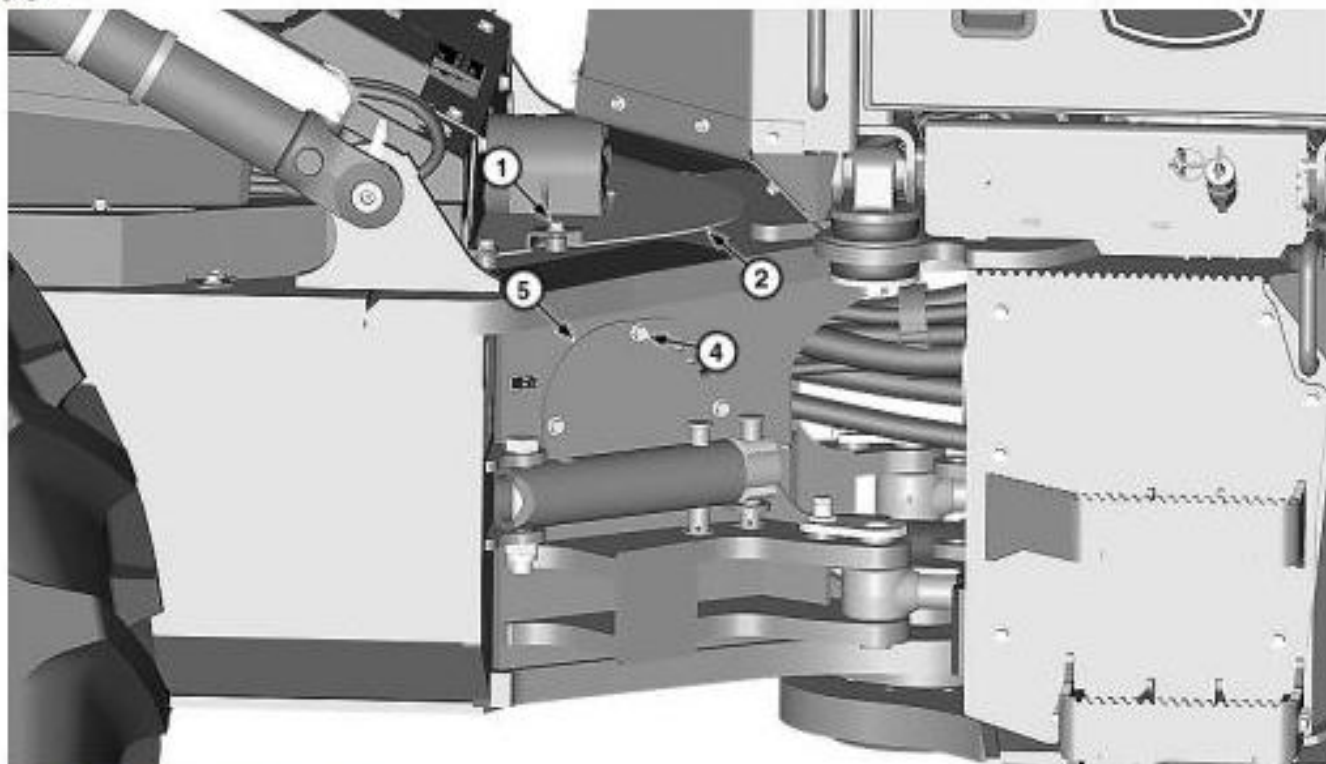

Equipment Frame (right side)

LEGEND:

- | | |
|---|--------------------|
| 1 | Cap Screw (4 used) |
| 2 | Winch Motor Guard |
| 4 | Cap Screw (4 used) |
| 5 | Cover |

Remove cap screws (1) and winch motor guard (2).

[7] - Remove cap screws (4) and cover (5).

[8] -



Thank you very much
for your reading.
Please click here
to get more information.