

John Deere Sabre 1438, 1542, 15542, 1642, 1646 (GS, HS, HV) Lawn Tractors () Technical Manual (tmgx10238)

SABRE LAWN TRACTOR

| | | |
|---------|------------------|------------------|
| MODELS: | 1438 Gear | 15.542 Automatic |
| | 1542 Gear | 1642 Gear |
| | 15.538 Gear | 1642 Automatic |
| | 15.538 Automatic | 1646 Automatic |
| | 1542 Automatic | 1642 Auto V-Twin |
| | 15.542 Gear | 1646 Auto V-Twin |



JOHN HARE



COLLECTION

John Deere
Worldwide Commercial and
Consumer Equipment Division

TM-GX10238 (01Apr98)

Litho in U.S.A.

Covers: 1438GS,1542GS,1542HS,15542HS,15542GS,1642GS,1642HV,1646

Type: Service Manual

Language: English

Pages: 161

Format: PDF

Features: Bookmarked, searchable, printable

Compatibility: Windows/Mac/Tablet/Mobile

This service manual contains important information for the maintenance, troubleshooting and servicing of the **John Deere Sabre 1438, 1542, 15542, 1642, 1646 (GS, HS, HV) Lawn Tractors () Technical Manual (tmgx10238)**

In this manual you will find detailed specifications, illustrations, schematics, diagrams and step-by-step procedures to properly service and diagnose the machine to the manufacturer's standards.

Contents:

- General Information
- Specifications
- Serial Number Location
- Engine Specifications
- Engine Diagnostics
- Engine Tests and Adjustments
- Engine Repair
- Power Train
- Transmission
- Axles
- Differential
- PTO
- Hydraulic System
- Electrical System
- Electrical Tests and Diagnostics
- Wiring Diagram / Schematic
- Ignition and Charging
- Steering
- Brakes
- Wheels
- Operator's Platform
- Body Panels
- Disassembly and Assembly
- Diagnostics, Tests and Adjustments
- Troubleshooting
- and much more...

Please note this manual is in **downloadable PDF format only**. If you have any questions about this product or would like to request sample pages, please contact us and reference the product name or SKU.

TRACTION DRIVE SYSTEM COMPONENT LOCATION

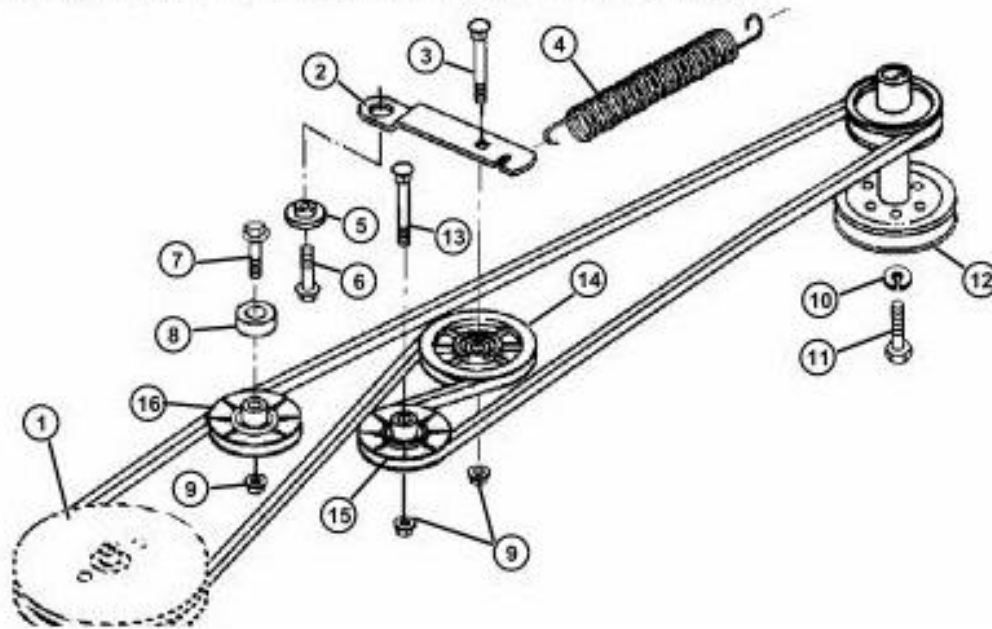

- 1. Transaxle Drive Sheave
- 2. Arm
- 3. Bolt M8 x 45
- 4. Spring
- 5. Bushing

- 6. Cap Screw
- 7. Bolt
- 8. Spacer
- 9. Flange Nut M8
- 10. Lock Washer

- 11. Cap Screw
- 12. Sheave, Engine
- 13. Bolt M8 x 45
- 14. Idler
- 15. Idler
- 16. Idler

PEDAL LINKAGE ASSEMBLY COMPONENT LOCATION

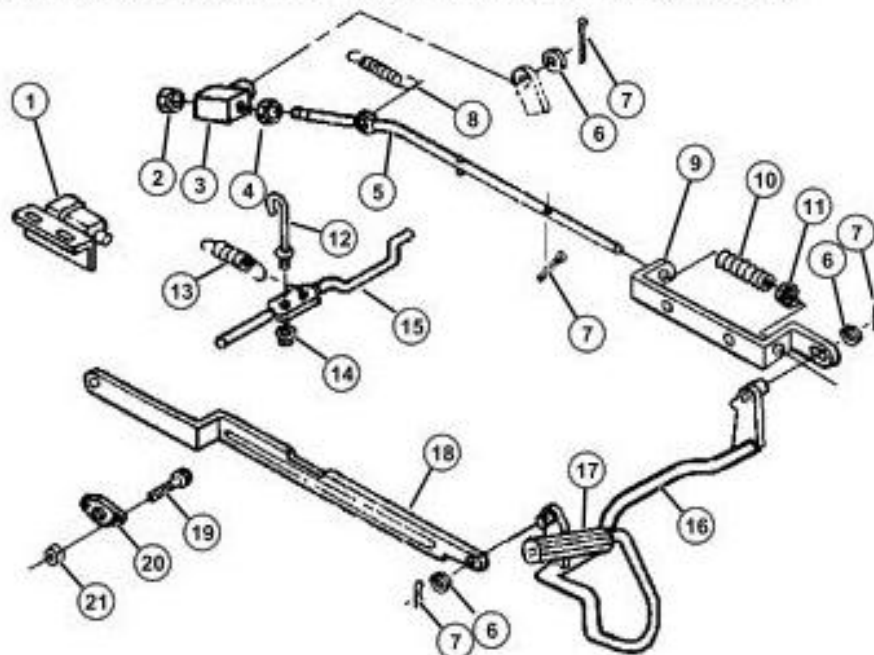

- 1. Neutral Switch
- 2. Lock Nut, 9.525 mm
- 3. Pivot
- 4. Nut, 3/8 in.
- 5. Rod
- 6. Washer
- 7. Cotter Pin

- 8. Brake Rod Return Spring
- 9. Brake Spring Strap
- 10. Brake Compression Spring
- 11. Washer
- 12. Park Brake Lever
- 13. Extension Spring
- 14. Flange Nut

- 15. Rod, Parking Brake
- 16. Shaft, Brake
- 17. Pad
- 18. Strap, Return to Neutral
- 19. Screw, M8x20
- 20. Bracket
- 21. Lock Nut, M8



Thank you very much
for your reading.
Please click here
to get more information.