

# PARTS CATALOG

T9.615 / T9.670  
4WD Tractor



BestManuals.net

The ABSOLUTE BestManuals on the web



**NEW HOLLAND**

AGRICULTURE

# PARTS CATALOG

**T9.615 / T9.670**  
**4WD Tractor**

Print No. 84368005  
9/2011



**NEW HOLLAND**

**AGRICULTURE**



# GENERAL INFORMATION

1. Whenever the terms left and right are used, it should be understood to mean from a position facing in direction of travel.
2. Throughout this manual you may find common hardware not illustrated, but listed in the description column. The service part immediately preceding a hardware listing is the part using these particular items for mounting purposes. This hardware is not included with the service part or assembly when ordered as a replacement.
3. The illustrations show typical assemblies plus individual parts but in all cases may not show the exact shape or detail of parts required. However, the purpose for the illustrations is to identify parts performing like functions. Whenever possible illustrations are located at the beginning of each section or immediately adjacent to the applicable text.
4. CNH America LLC is continually striving to improve its products. We must, therefore, reserve the right to make improvements or changes when it becomes practical and possible to do so, without incurring any obligation to make changes or additions to the equipment sold previously.

CNH America LLC, Racine, WI 53404 U.S.A.

# How to Use Your Parts Catalog

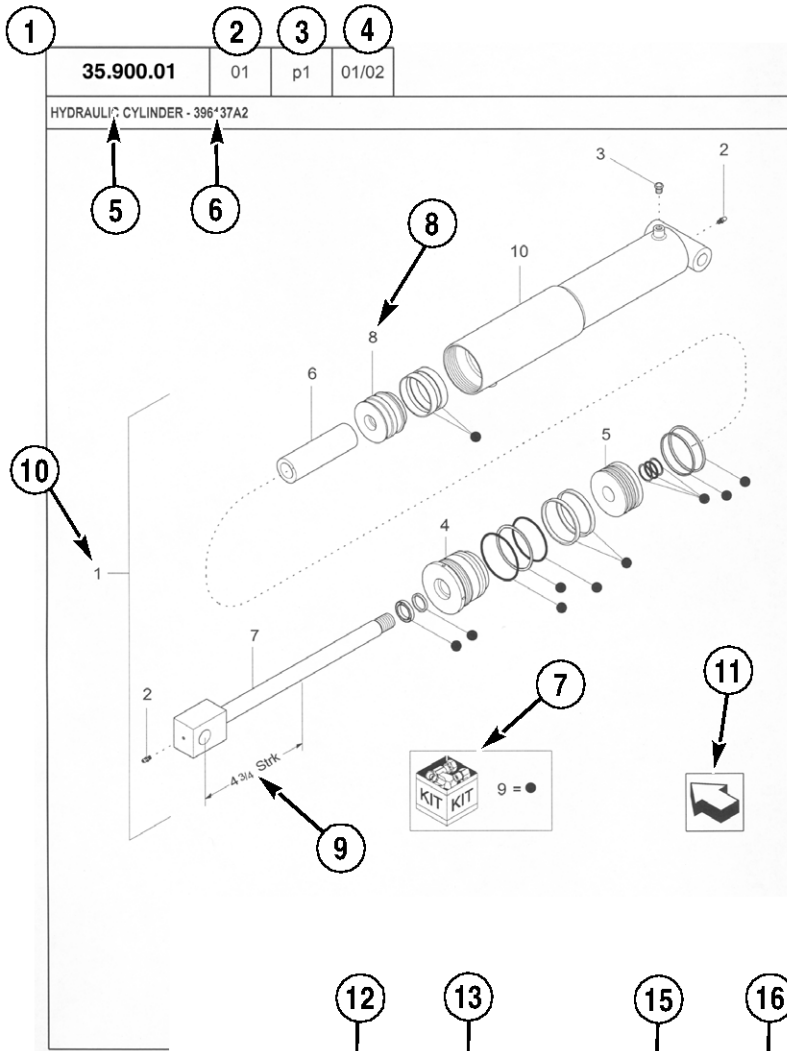

| 1                             | 2  | 3  | 4             |
|-------------------------------|----|----|---------------|
| 35.900.01                     | 01 | p1 | 01/02         |
| HYDRAULIC CYLINDER - 396137A2 |    |    |               |
| 10                            | 1  | 2  | 4-3/4 Strk    |
| 7                             | 7  | 9  | KIT KIT 9 = ● |
| 11                            |    |    |               |

| 1                             | 2   | 3     | 4           |                   |     |  |
|-------------------------------|-----|-------|-------------|-------------------|-----|--|
| 35.900.01                     | 01  | p1    | 01/02       |                   |     |  |
| HYDRAULIC CYLINDER - 396137A2 |     |       |             |                   |     |  |
| 8                             | REF | FN    | PART NUMBER | YR/SN             | QTY | DESCRIPTION                            |
|                               | 1   |       | 396137A2    | BTW 01/85 & 02/02 | 1   | CYLINDER ASSY. 4-3/4 in strk, Inc 2-10 |
|                               | 2   |       | 31-95       | Before 01/85      | 2   | FITTING                                |
|                               | 2   |       | 219-8       | From 01/85        | 2   | NIPPLE, LUBE Grease, 1/4 tpr x 17/32   |
|                               | 3   |       | {402475A2}  |                   | 1   | BREATHER                               |
|                               | 4   |       | 402474A1    |                   | 1   | CAP CYLINDER END                       |
|                               | 5   |       | 402468A1    | BSN JJC0189200    | 1   | PISTON ROD/GLAND                       |
|                               | 5   |       | 145221C3    | ASN JJC0189200    | 1   | PISTON                                 |
|                               | 6   |       | 402471A1    |                   | 1   | SPACER                                 |
|                               | 7   |       | 402473A1    |                   | 1   | ROD, PISTON                            |
|                               | 8   |       | 402469A1    |                   | 1   | PISTON ROD/GLAND                       |
|                               | 9   |       | 402476A1    |                   | 1   | PACKAGE, SEALS                         |
|                               | 10  |       | NSS         |                   | 1   | NOT SERVICED SEPARAT CASE ASSEMBLY     |
| 12                            | (1) | 08-20 |             |                   |     |  |
| STANDARD                      |     |       | MODELS      |                   |     |  |



Thank you very much  
for your reading.  
Please click here  
to get more information.