

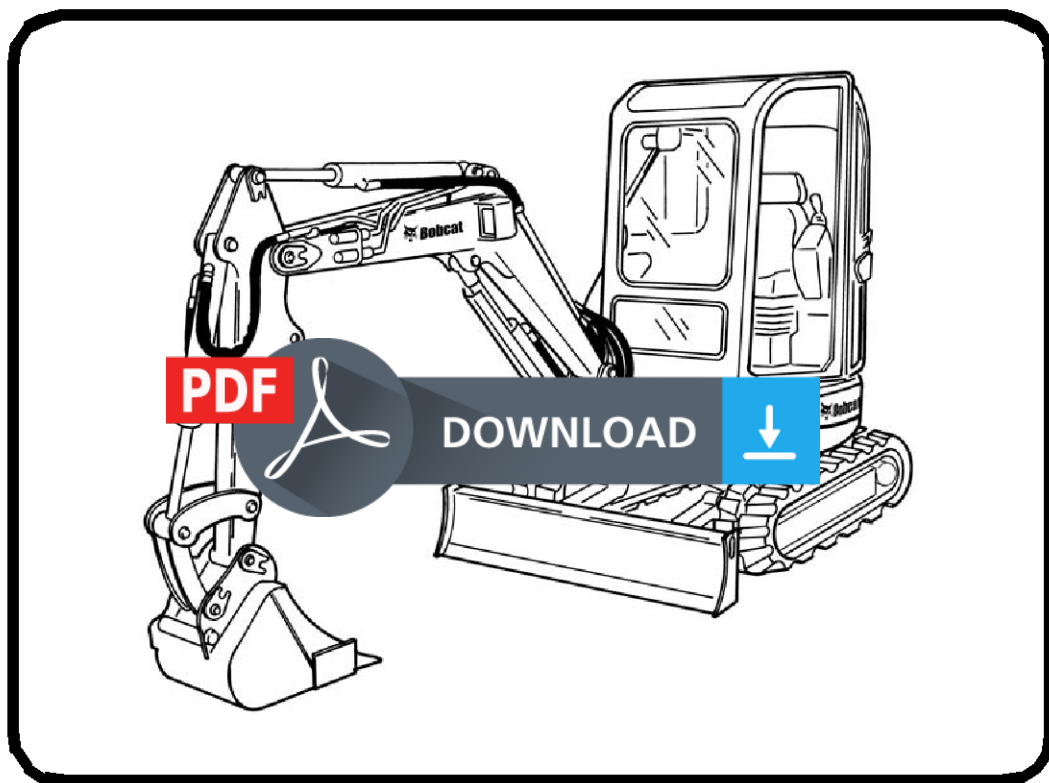

Bobcat®

Service Manual 425 Compact Excavator

S/N A1HW11001 & Above



Dealer Copy -- Not for Resale



MAINTENANCE SAFETY



WARNING

Instructions are necessary before operating or servicing machine. Read and understand the Operation & Maintenance Manual, Operator's Handbook and signs (decals) on machine. Follow warnings and instructions in the manuals when making repairs, adjustments or servicing. Check for correct function after adjustments, repairs or service. Untrained operators and failure to follow instructions can cause injury or death.

W-2003-0903



Safety Alert Symbol: This symbol with a warning statement, means: "Warning, be alert! Your safety is involved!" Carefully read the message that follows.

CORRECT



B-10731A

- Never service the Bobcat Compact Excavator without instructions.

CORRECT



B-19964

- Use the correct procedure to lift and support the excavator.

CORRECT

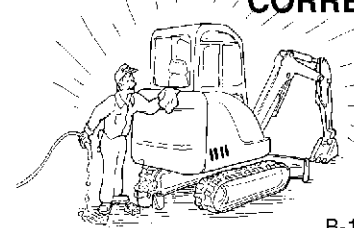

B-19959

- Cleaning and maintenance are required daily.

WRONG

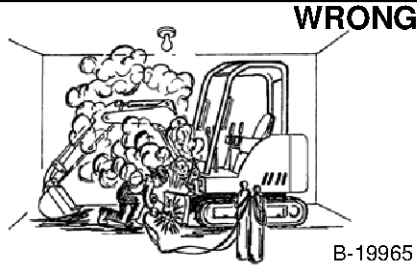

B-19965

- Have good ventilation when welding or grinding painted parts.
- Wear dust mask when grinding painted parts. Toxic dust and gas can be produced.

WRONG

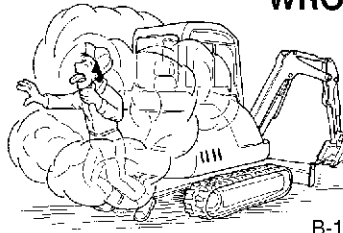

B-19960

- Vent exhaust to outside when engine must be run for service.
- Exhaust system must be tightly sealed. Exhaust fumes can kill without warning.

WRONG

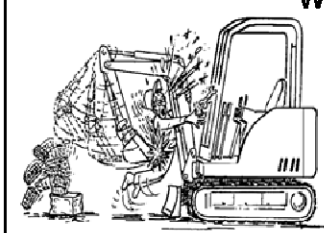

B-19966

- Always lower the bucket and blade to the ground before doing any maintenance.
- Never modify equipment or add attachments not approved by Bobcat Company.

WRONG

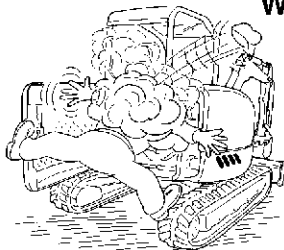

B-19962

- Stop, cool and clean engine of flammable materials before checking fluids.
- Never service or adjust machine with the engine running unless instructed to do so in the manual.
- Avoid contact with leaking hydraulic fluid or diesel fuel under pressure. It can penetrate the skin or eyes.
- Never fill fuel tank with engine running, while smoking, or when near open flame.

WRONG

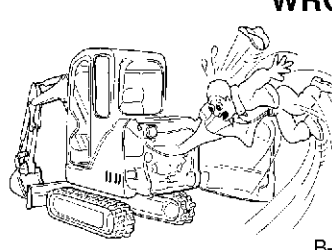

B-19958

- Keep body, jewelry and clothing away from moving parts, electrical contact, hot parts and exhaust.
- Wear eye protection to guard from battery acid, compressed springs, fluids under pressure and flying debris when engines are running or tools are used. Use eye protections approved for type of welding.
- Keep rear door closed except for service. Close and latch door before operating the excavator.

WRONG



B-19798

- Lead-acid batteries produce flammable and explosive gases.
- Keep arcs, sparks, flames and lighted tobacco away from batteries.
- Batteries contain acid which burns eyes or skin on contact.
- Wear protective clothing. If acid contacts body, flush well with water. For eye contact flush well and get immediate medical attention.

Maintenance procedures which are given in the Operation & Maintenance Manual can be performed by the owner/operator without any specific technical training. Maintenance procedures which are **not** in the Operation & Maintenance Manual must be performed **ONLY BY QUALIFIED BOBCAT SERVICE PERSONNEL**. Always use genuine Bobcat replacement parts. The Service Safety Training Course is available from your Bobcat dealer.

MSW28-0805

Dealer Copy -- Not for Resale



Bobcat®

ALPHABETICAL INDEX

AIR CLEANER	60-01	HEATER COIL.....	70-01
AIR CLEANER SERVICE	10-01	HEATER SYSTEM.....	70-01
ALTERNATOR	50-01	HEATER UNIT.....	70-01
ALTERNATOR BELT	10-01	HEATER VALVE	70-01
ARM	40-01	HORN	40-01
ARM CYLINDER	20-01	HYDRAULIC CONTROL VALVE	20-01
		HYDRAULIC CONNECTION SPECS	SPEC-01
BATTERY.....	50-01	HYDRAULIC FLUID SPECIFICATIONS.....	SPEC-01
BLADE	30-01	HYDRAULIC FILTER.....	20-01
BLADE CONTROL.....	40-01	HYDRAULIC PUMP	20-01
BLADE CYLINDER	20-01	HYDRAULIC RESERVOIR.....	20-01
BLOWER FAN	70-01	HYDRAULIC SYSTEM	10-01
BOOM	40-01	HYDRAULIC SYSTEM INFORMATION	20-01
BOOM CYLINDER.....	20-01	HYDRAULIC X-CHANGE VALVE.....	20-01
BOOM SWING CYLINDER.....	20-01		
BOOM SWING PEDAL	40-01	LEFT CONTROL LEVER (JOYSTICK)	20-01
BUCKET	40-01	LEFT CONSOLE	40-01
BUCKET CYLINDER	20-01	LEFT SIDE COVER.....	40-01
		LIFTING AND BLOCKING THE EXCAVATOR	10-01
CAB.....	40-01	LIFTING THE EXCAVATOR	10-01
CAMSHAFT AND TIMING GEARS.....	60-01	LIGHTS.....	50-01
CANOPY.....	40-01	LUBRICATION SYSTEM.....	60-01
CASE DRAIN FILTER	20-01	LUBRICATING THE EXCAVATOR	10-01
CONVERSIONS	SPEC-01		
CONTROL PATTERN SELECTOR VALVE	20-01	MAGNETIC LOCKOUT SENSOR	50-01
COUNTERWEIGHT	40-01	MAIN RELIEF VALVE	20-01
CRANKSHAFT AND PISTONS	60-01	MANIFOLD ASSEMBLY / ACCUMULATOR	20-01
CROSSPORT RELIEF VALVES	20-01		
CYLINDER HEAD.....	60-01	NON-PRESSURIZED ACCUMULATOR	20-01
DIAGNOSTICS SERVICE CODES.....	50-01	OIL COOLER.....	20-01
DIRECT TO TANK VALVE	20-01	OPERATOR CAB (ROPS/TOPS)	10-01
ELECTRICAL SYSTEM INFORMATION	50-01	PIVOT PINS	10-01
ENGINE COOLING SYSTEM.....	10-01, 60-01	PORT RELIEF VALVES.....	20-01
ENGINE INFORMATION	60-01	PRESSURE REDUCING VALVE.....	20-01
ENGINE LUBRICATION SYSTEM.....	10-01		
ENGINE SPEED CONTROL	60-01	REGULAR MAINTENANCE	70-01
EXCAVATOR SPECIFICATIONS	SPEC-01	RIGHT CONTROL LEVER (JOYSTICK)	20-01
EXCAVATOR STORAGE AND RETURN TO SERVICE	10-01	RIGHT CONSOLE.....	40-01
		RIGHT SIDE COVER	10-01, 40-01
FLOOR MAT AND FLOOR PANELS	40-01		
FLYWHEEL AND HOUSING.....	60-01		
FUEL LEVEL SENDER.....	50-01		
FUEL SYSTEM.....	10-01, 60-01		
FUEL TANK.....	40-01		

Dealer Copy -- Not for Resale

Continued On Next Page



Thank you very much
for your reading.
Please click here
to get more information.