

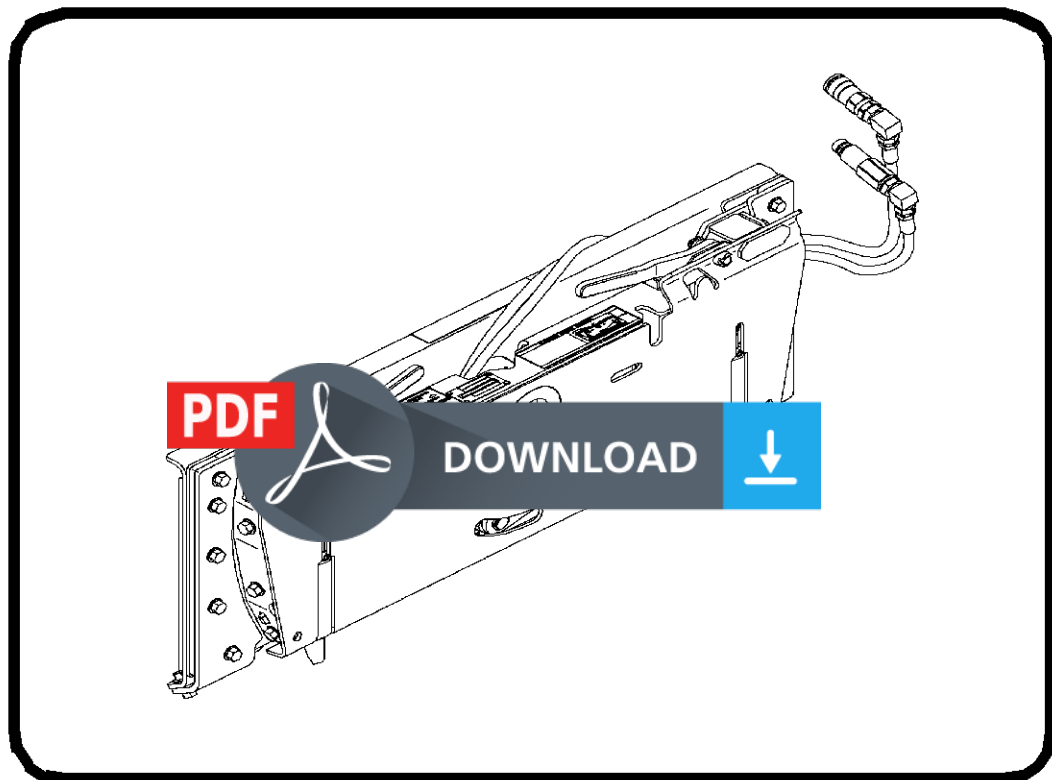

Bobcat®

Operation & Maintenance Manual Tilt-Tatch™

(Tilt-Tatch) S/N 224100101 & Above



CONTENTS

FOREWORD	3
SAFETY AND TRAINING RESOURCES	11
OPERATING INSTRUCTIONS	19
PREVENTIVE MAINTENANCE	95
MACHINE SIGN TRANSLATIONS	105
SPECIFICATIONS	109
WARRANTY	113
ALPHABETICAL INDEX	117

REFERENCE INFORMATION

Write the correct information for YOUR Bobcat attachment in the spaces below. Always use these numbers when referring to your Bobcat attachment.

Attachment Serial Number _____

NOTES:

YOUR BOBCAT DEALER:

ADDRESS: _____

PHONE: _____

Bobcat Company
P.O. Box 128
Gwinner, ND 58040-0128
UNITED STATES OF AMERICA

Doosan Benelux SA
Drève Richelle 167
B-1410 Waterloo
BELGIUM



Bobcat®

FOREWORD

This Operation & Maintenance Manual was written to give the owner / operator instructions on the safe operation and maintenance of the attachment. **READ AND UNDERSTAND THIS OPERATION & MAINTENANCE MANUAL BEFORE OPERATING YOUR ATTACHMENT.** If you have any questions, see your Bobcat dealer. This manual may illustrate options and accessories not installed on your attachment.

BOBCAT COMPANY IS ISO 9001 CERTIFIED	5
SERIAL NUMBER LOCATION	7
Attachment Serial Number	7
DELIVERY REPORT	7
ATTACHMENT IDENTIFICATION	8
FEATURES AND ACCESSORIES	9
Standard Items	9



Thank you very much
for your reading.
Please click here
to get more information.