

# 1990-1996 Honda VFR750F Motorcycle Service Repair Workshop Manual



PDF



DOWNLOAD



# HONDA

## SERVICE MANUAL

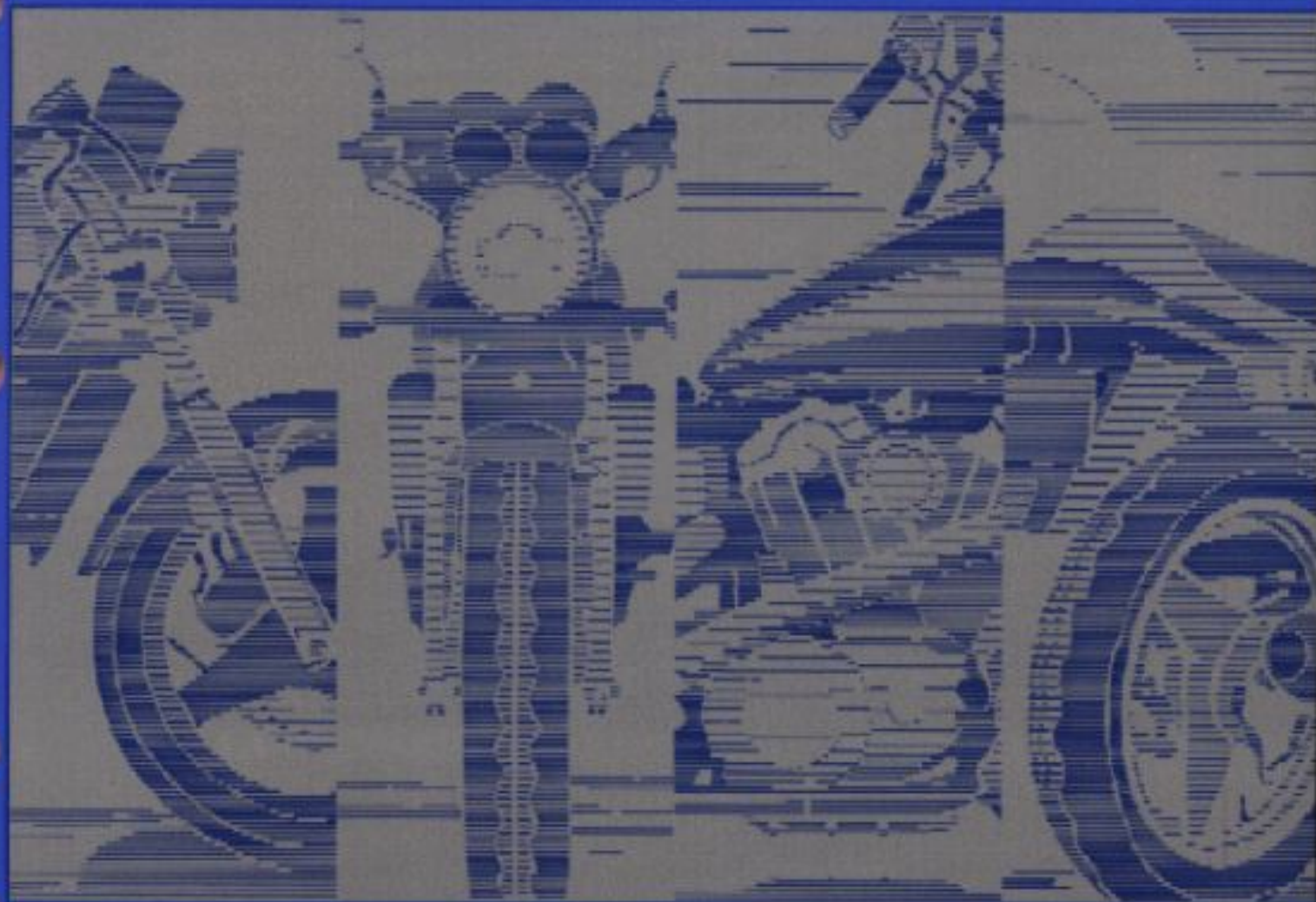

**90-96**  
**VFR750F**

61MT406

© HONDA MOTOR CO., LTD. 1994

## Introduction

This service manual describes the service procedures for the VFR750F.

This Model Specific Manual includes every service procedure that is of a specific nature to this particular model. Basic service procedures that are common to other Honda Motorcycles/Motor Scooters/ATVs are covered in the Common Service Manual. This Model Specific Service Manual should be used together with the Common Service Manual in order to provide complete service information on all aspects of this motorcycle.

Follow the Maintenance Schedule (Section 3) recommendations to ensure that the vehicle is in peak operating condition and the emission levels are within the standards set by the U.S. Environmental Protection Agency and the California Air Resources Board.

Performing the first scheduled maintenance is very important. It helps compensate for the initial wear that occurs during the break-in period.

Sections 1 through 3 apply to the whole motorcycle, while sections 4 through 19 describe parts of the motorcycle, grouped according to locations.

Find the section you want on this page, then turn to the table of contents on the first page of that section.

Most sections describe the service procedures through a system illustration. Refer to the next page for details on how to use this manual.

If you don't know the source of the trouble, go to section 20 TROUBLESHOOTING.

All information, illustrations, directions and specifications included in this publication are based on the latest product information available at the time of approval for printing. Honda Motor Co., Ltd. reserves the right to make changes at any time without notice and without incurring any obligation whatever. No part of this publication may be reproduced without written permission. This manual is written for persons who have acquired basic knowledge of maintenance on Honda motorcycles.

## Contents

|                               |   |  |
|-------------------------------|---|--|
|                               | <b>General Information</b>                      | <b>1</b>                               |
|                               | <b>Body Panels/Exhaust System<br/>Sub Frame</b> | <b>2</b>                               |
|                               | <b>Maintenance</b>                              | <b>3</b>                               |
| <b>Engine and Drive Train</b> | <b>Lubrication</b>                              | <b>4</b>                               |
|                               | <b>Cooling System</b>                           | <b>5</b>                               |
|                               | <b>Fuel System</b>                              | <b>6</b>                               |
|                               | <b>Engine Removal/Installation</b>              | <b>7</b>                               |
|                               | <b>Cylinder Head/Valves</b>                     | <b>8</b>                               |
|                               | <b>Clutch System</b>                            | <b>9</b>                               |
|                               | <b>Gearshift Linkage</b>                        | <b>10</b>                              |
|                               | <b>Crankshaft/Piston/Transmission</b>           | <b>11</b>                              |
|                               | <b>Chassis</b>                                  | <b>Front Wheel/Suspension/Steering</b> |
| <b>Rear Wheel/Suspension</b>  |   | <b>13</b>                              |
| <b>Brakes</b>                 |   | <b>14</b>                              |
| <b>Electrical</b>             | <b>Charging System/Alternator</b>               | <b>15</b>                              |
|                               | <b>Ignition System</b>                          | <b>16</b>                              |
|                               | <b>Electric Starter/Starter Clutch</b>          | <b>17</b>                              |
|                               | <b>Lights/Meters/Switches</b>                   | <b>18</b>                              |
|                               | <b>Wiring Diagram</b>                           | <b>19</b>                              |
|                               | <b>Troubleshooting</b>                          | <b>20</b>                              |
|                               | <b>Index</b>                                    | <b>21</b>                              |

**HONDA MOTOR CO., LTD.  
SERVICE PUBLICATIONS OFFICE**

## Shock Absorber Removal/Installation

'90-'93:

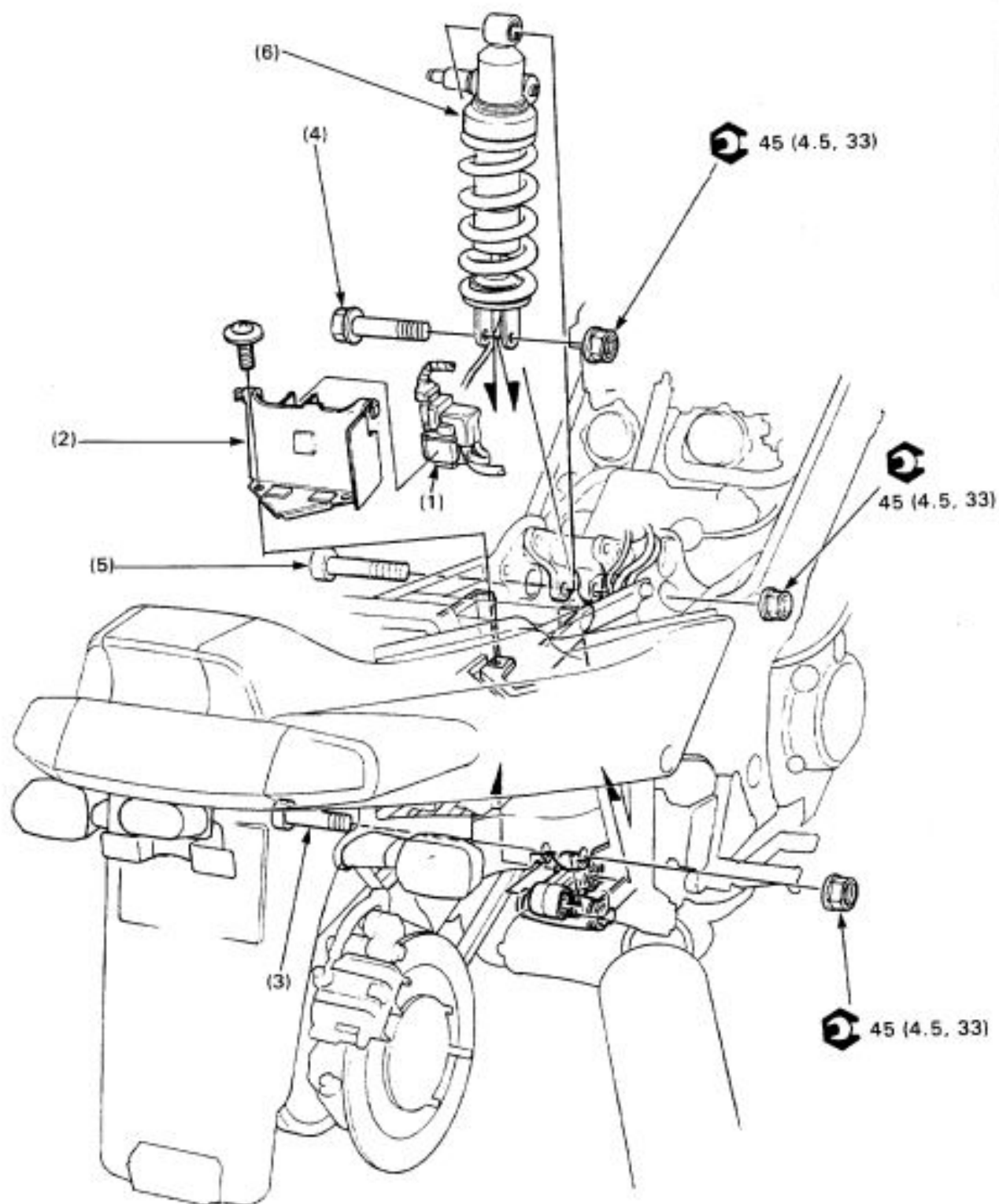



Thank you very much  
for your reading.  
Please click here  
to get more information.