

# 2001 Yamaha FZS1000(N) Motorcycle Service Repair Workshop Manual













**FZS1000(N) 2001**  
5LV1-AE1

**SERVICE MANUAL**

# TABLE OF CONTENTS

GENERAL INFORMATION		
	GEN INFO	<b>1</b>
SPECIFICATIONS		
	SPEC	<b>2</b>
PERIODIC CHECKS AND ADJUSTMENTS		
	CHK ADJ	<b>3</b>
CHASSIS		
	CHAS	<b>4</b>
ENGINE		
	ENG	<b>5</b>
COOLING SYSTEM		
	COOL	<b>6</b>
CARBURETORS		
	CARB	<b>7</b>
ELECTRICAL SYSTEM		
	ELEC	<b>8</b>
TROUBLESHOOTING		
	TRBL SHTG	<b>9</b>





- ① Starter cable
- ② Clutch cable
- ③ Handlebar switch lead (left)
- ④ Main switch lead
- ⑤ EXUP servo motor
- ⑥ Starting circuit cutoff relay
- ⑦ Starter motor lead
- ⑧ Fan motor relay
- ⑨ Air cleaner case drain hose
- ⑩ Sidestand switch lead
- ⑪ oil level switch lead
- ⑫ ACgenerator lead
- ⑬ Water-head pipe
- ⑭ Water-carburetor hose
- ⑮ Throttle cable 2
- ⑯ Throttle cable 1
- ⑰ EXUP cable

- A Fasten the main switch lead and handlebar switch lead with a plastic guide.
- B Fasten the water-head hose and water-carburetor hose with a plastic band.
- C Fasten the clutch cable with a plastic band.
- D Fasten the clutch cable with a steel clamp.
- E Fasten the wire harness with a plastic band.
- F To the fuel sender.
- G Route the fuel sender lead inside the seat rail.
- H Route the battery negative lead forward the frame stay.
- I Route the main harness inside the rear fender groove.
- J Fasten the wire harness, sidestand switch lead, oil level switch and flame with a plastic band. Do not fasten the ACgenerator lead (white).
- K Route the starter motor lead and battery negative lead inside the plastic band.
- L Route the all hoses outside the fuel hose.
- M Route the fuel hose through the steel guide.

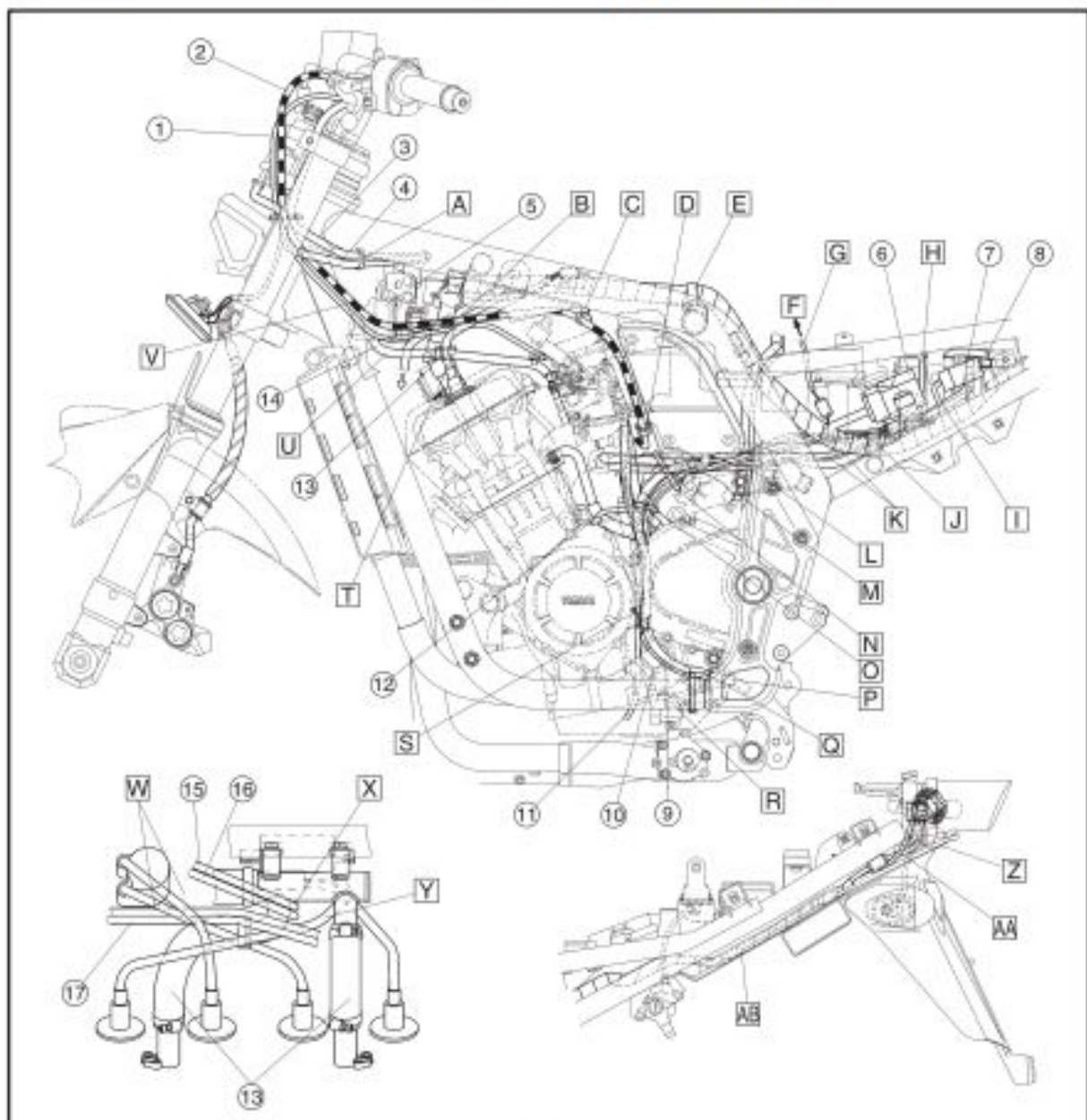



Thank you very much  
for your reading.  
Please click here  
to get more information.