

2003 Yamaha YZ250FR Motorcycle Service Repair Workshop Manual











OWNER'S SERVICE MANUAL

YZ250FR

LIT-11626-16-39

5UL-28199-10

INDEX

GENERAL INFORMATION	
	GEN INFO 1
SPECIFICATIONS	
	SPEC 2
REGULAR INSPECTION AND ADJUSTMENTS	
	INSP ADJ 3
ENGINE	
	ENG 4
CHASSIS	
	CHAS 5
ELECTRICAL	
	ELEC 6
TUNING	
	TUN 7



- L** Make sure that the throttle position sensor lead coupler does not go outside the chassis.
- M** Fasten the throttle position sensor lead.
- N** Fasten the neutral switch lead on the oil hose with a plastic locking tie and cut off the tie end.
- O** Fasten the neutral switch lead.
- P** Fasten the neutral switch lead and CDI magneto lead.
- Q** Pass the neutral switch lead, CDI magneto lead and radiator breather hose between the radiator and frame.
- R** Pass the carburetor breather hoses and overflow hose so that all these hoses do not contact the rear shock absorber.

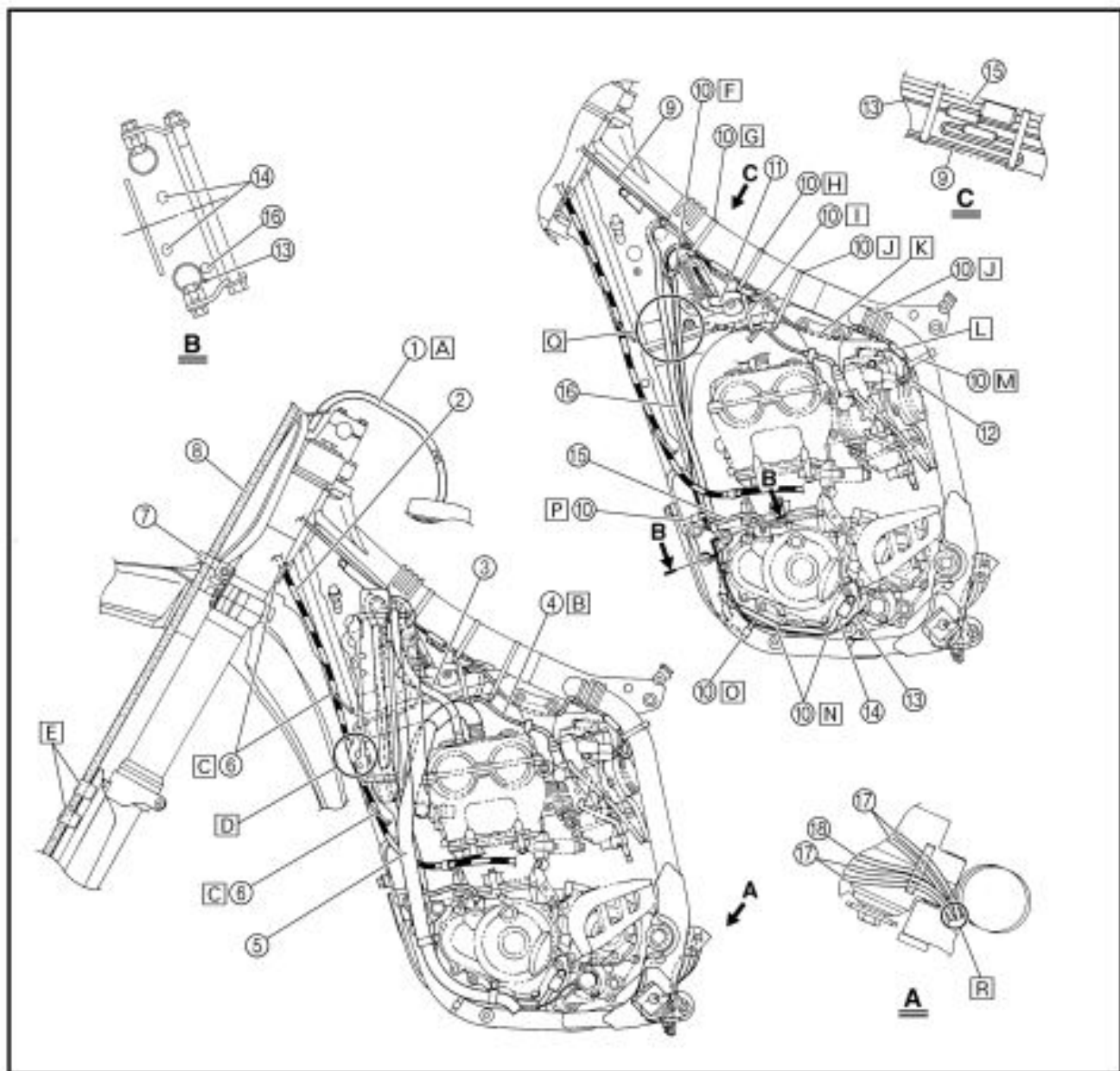



Thank you very much
for your reading.
Please click here
to get more information.