

Case WX145,WX165,WX185 Wheeled Excavators Service Repair Workshop Manual



WX145

WX165

WX185

HYDRAULIC EXCAVATOR

Service manual

Print No. 9-91221 English



THIS ALERT SYMBOL SIGNALS IMPORTANT MESSAGES INVOLVING YOUR SAFETY.

Read and heed carefully the safety instructions listed and follow the precautions recommended to avoid potential risks and to safeguard your health and your safety.

You will find this symbol in the text of this Manual referred to the following key words:

WARNING - Cautions directed to avoid improper repair interventions involving potential consequences for the safety of the personnel performing the repairs.

DANGER - These warnings qualify specifically potential dangers for the safety of the operator or other persons directly or indirectly involved.

IMPORTANT NOTICE

All maintenance and repair interventions explained in this Manual must be performed exclusively by the Service Organisation of the Manufacturer, observing strictly the instructions explained using, whenever necessary, the recommended specific tools.

Whoever performs the operations reported without following exactly the precautions is responsible on his own, for the damages that may result.

Neither the Factory nor any Organisations in its Distribution Network, including but not limited to national, regional or local distributors, are responsible for any liability arising from any damage resulting from defects caused by parts and/or components not approved by the Factory for use in maintaining and/or repairing products manufactured or merchandised by the Factory.

In any case, no warranty of any kind is made or shall be imposed with respect to products manufactured or merchandised by the Factory, when failures are caused by the use of parts and/or components not approved by the Factory.

SUMMARY

4000701.00-en

SAFETY INSTRUCTIONS	SECTION 1
TECHNICAL DATA AND SPECIAL TOOLS	SECTION 2
MACHINE STRUCTURE	SECTION 3
ELECTRICAL SYSTEM	SECTION 4
ELECTRONICS	SECTION 5
HYDRAULICS	SECTION 6
TROUBLESHOOTING AND REPAIR	SECTION 7
REPAIR INSTRUCTIONS	SECTION 8

Warning and instruction signs (boom adjusting equipment) (Page 1 of 2)

10000527.00-en

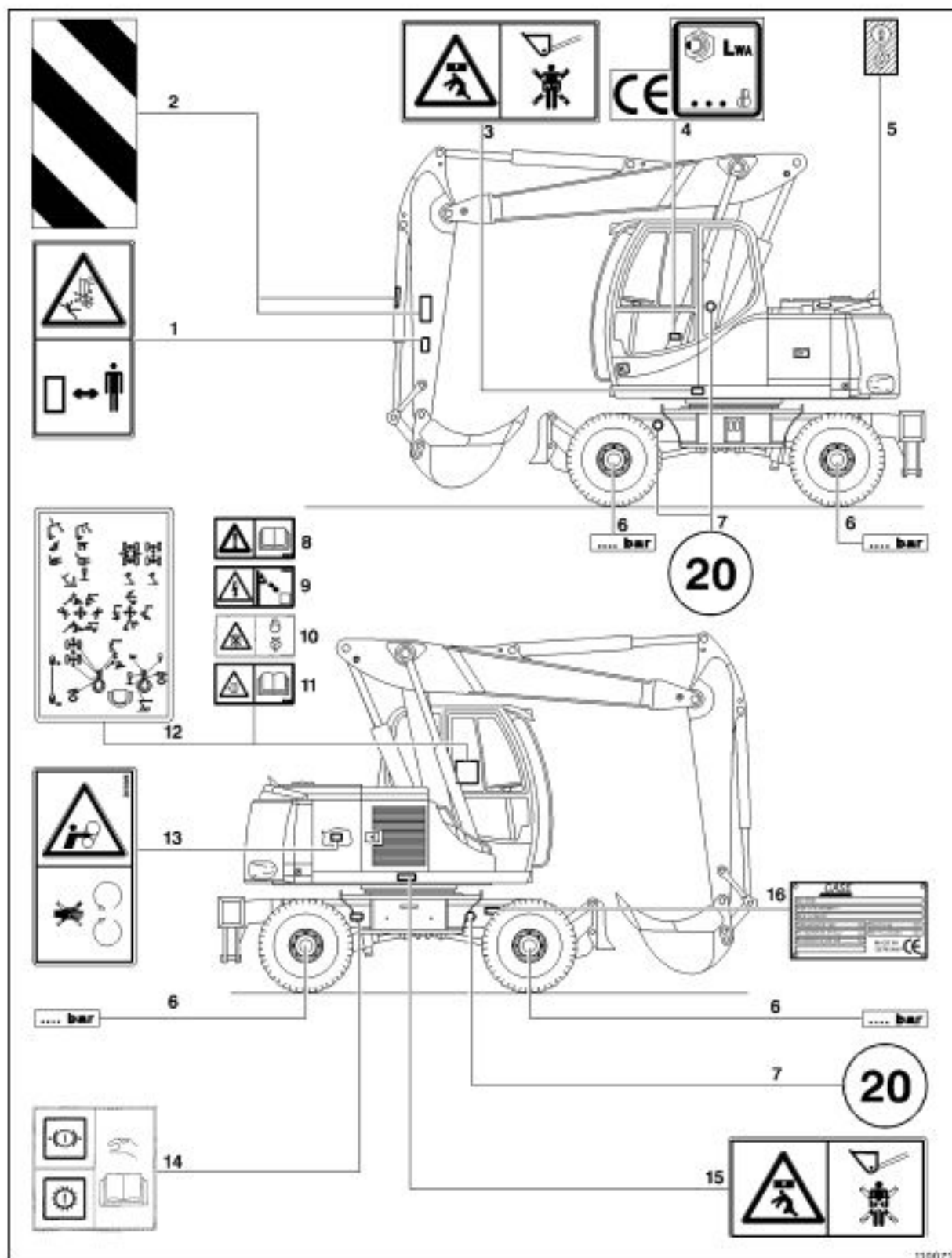

Fig. 1





Thank you very much
for your reading.
Please click here
to get more information.