

John Deere 1050K (SN. C318802-) Crawler Dozer Service Repair Technical Manual (TM14350X19)

1050K Crawler Dozer Repair

(PIN: 1T01050K_
_C318802—)



JOHN HARE



COLLECTION

REPAIR TECHNICAL MANUAL

1050K Crawler Dozer (PIN: 1T01050K__C318802—)

TM14350X19 01DEC18 (ENGLISH)

For complete service information also see:

1050K Crawler Dozer.....	omt312939x19
1050K Crawler Dozer Operation and Test.....	TM14348X19
Hydraulic Cylinders.....	ctm120519
PowerTech™ 13.5L OEM Diesel Engines Base Engine Repair.....	
PowerTech 6135 Diesel Engine Systems With Delphi EUIs.....	



Worldwide Construction and
Forestry Division

Covers: 1050K,1T01050K__,_C318802(???)

Type: Service Manual

Language: English

Pages: 418

Format: PDF

Features: Bookmarked, searchable, printable

Compatibility: Windows/Mac/Tablet/Mobile

This service manual contains important information for the maintenance, troubleshooting and servicing of the **John Deere 1050K (SN. C318802-) Crawler Dozer Service Repair Technical Manual (TM14350X19)**

In this manual you will find detailed specifications, illustrations, schematics, diagrams and step-by-step procedures to properly service and diagnose the machine to the manufacturer's standards.

Contents:

- General Information
- Specifications
- Serial Number Location
- Engine Specifications
- Engine Diagnostics
- Engine Tests and Adjustments
- Engine Repair
- Power Train
- Transmission
- Axles
- Differential
- PTO
- Hydraulic System
- Electrical System
- Electrical Tests and Diagnostics
- Wiring Diagram / Schematic
- Ignition and Charging
- Steering
- Brakes
- Wheels
- Operator's Platform
- Body Panels
- Disassembly and Assembly
- Diagnostics, Tests and Adjustments
- Troubleshooting
- and much more...

Please note this manual is in **downloadable PDF format only**. If you have any questions about this product or would like to request sample pages, please contact us and reference the product name or SKU.

3.  **CAUTION:**

Prevent possible injury from crushing. Heavy component, use appropriate lifting device.

Item	Measurement	Specification
Front Track Guide	Weight	36.5 kg 80 lb.

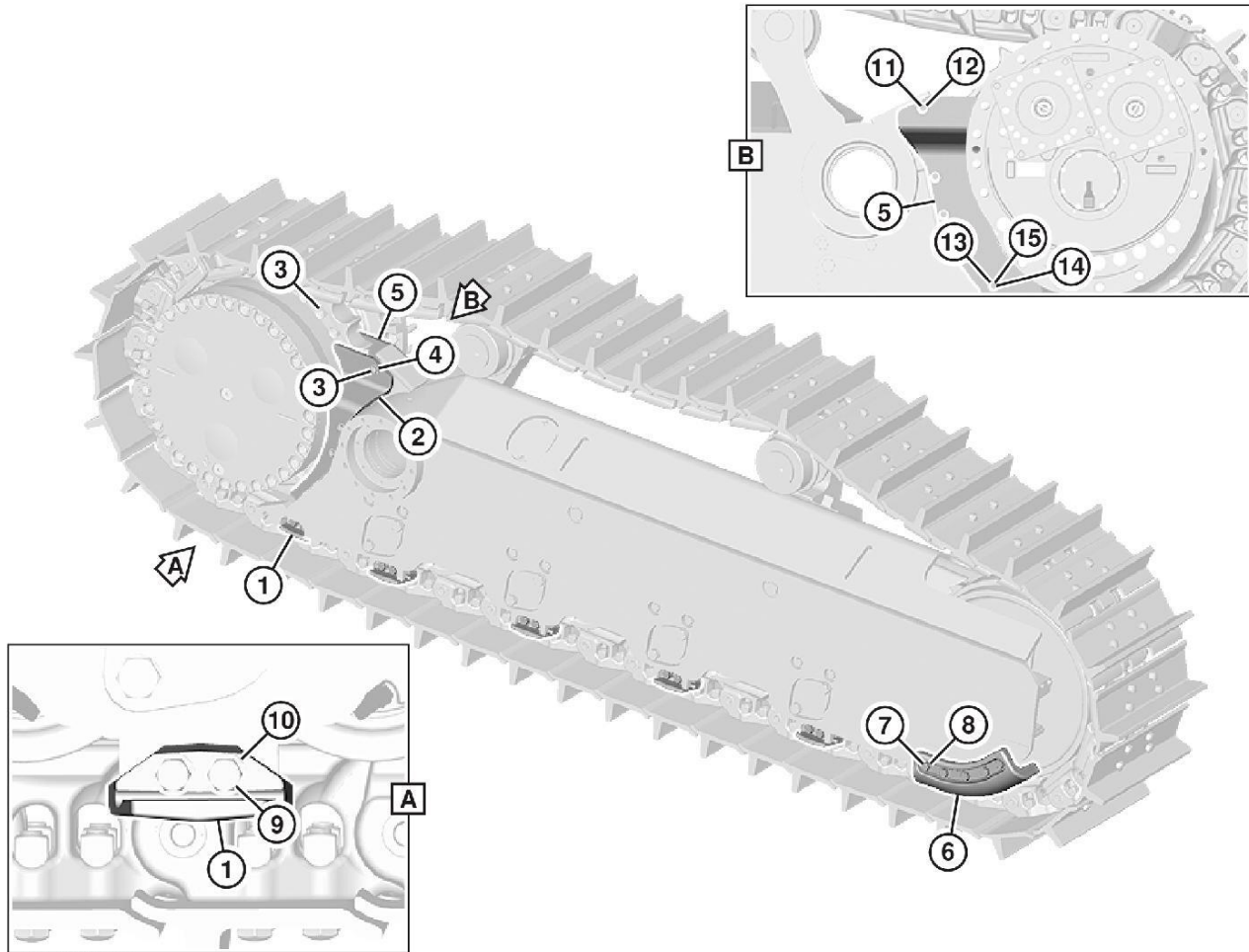

TX1189984

TX1189984-UN: Track Guides (right track shown)

LEGEND:

1-Bogie Guide (20 used)

2-Outer Sprocket Guard (2 used)

3-Cap Screw (6 used)

4-Washer (6 used)

5-Inner Sprocket Guard (2 used)

6-Front Track Guide (4 used)

7-Cap Screw (20 used)

8-Washer (20 used)

9-Cap Screw (40 used)

10-Washer (40 used)

11-Cap Screw (6 used)

12-Washer (6 used)

13-Washer (2 used)

14-Cap Screw (2 used)

15-Nut (2 used)

Using appropriate lifting device, remove front track guides (6).

4. Remove bogie guides (1).
5. Remove outer sprocket guards (2).
6. Remove inner sprocket guards (5).
7. Repair or replace as necessary.



Thank you very much
for your reading.
Please click here
to get more information.