

John Deere 850L PL Pipelayer Ready Crawler Dozer Repair Technical Manual - TM14356X19

850L PL Pipelayer Ready Crawler Dozer Repair

PIN: 1T0850LP__F352989—



JOHN HARE



COLLECTION

REPAIR TECHNICAL MANUAL 850L PL Pipelayer Ready Crawler Dozer

(PIN: 1T0850LP__F352989—)

TM14356X19 30NOV19 (ENGLISH)

For complete service information also see:

6090 PowerTech™ OEM Diesel Engines (Final Tier 4/Stage IV platform).....	ctm117719
850L PL Pipelayer Ready Crawler Dozer Operation and Test.....	TM14355X19
Connectors Repair.....	704219



Worldwide Construction and
Forestry Division

Covers: 850L,1T0850LP__,_F352989(???)

Type: Service Manual

Language: English

Pages: 318

Format: PDF

Features: Bookmarked, searchable, printable

Compatibility: Windows/Mac/Tablet/Mobile

This service manual contains important information for the maintenance, troubleshooting and servicing of the **John Deere 850L PL Pipelayer Ready Crawler Dozer Repair Technical Manual - TM14356X19**

In this manual you will find detailed specifications, illustrations, schematics, diagrams and step-by-step procedures to properly service and diagnose the machine to the manufacturer's standards.

Contents:

- General Information
- Specifications
- Serial Number Location
- Engine Specifications
- Engine Diagnostics
- Engine Tests and Adjustments
- Engine Repair
- Power Train
- Transmission
- Axles
- Differential
- PTO
- Hydraulic System
- Electrical System
- Electrical Tests and Diagnostics
- Wiring Diagram / Schematic
- Ignition and Charging
- Steering
- Brakes
- Wheels
- Operator's Platform
- Body Panels
- Disassembly and Assembly
- Diagnostics, Tests and Adjustments
- Troubleshooting
- and much more...

Please note this manual is in **downloadable PDF format only**. If you have any questions about this product or would like to request sample pages, please contact us and reference the product name or SKU.



25. T96276-UN: Track Chain Lubricant
Apply track chain lubricant to bushing ends before next set of links are installed.



29. T96279-UN: Aviation Sealant
Apply Aviation Sealant or an equivalent to the link bore. The sealant prevents loss of vacuum or lubricant leakage through the pin to link joint.

IMPORTANT:

26. Pins must be installed so cross-drilled (15) hole is toward link wear surface or they may break when chain is used. To make assembly easier, install all pins so holes in the end are toward the same side of chain.

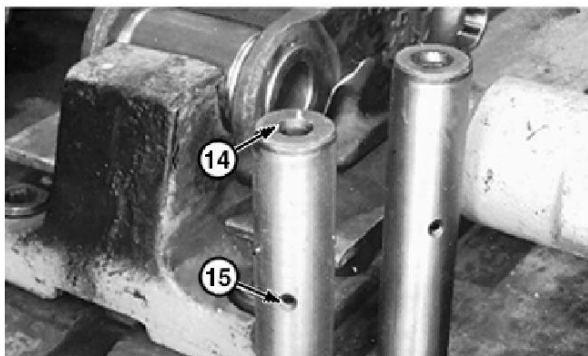

TX1195118A-UN: Cross-Drilled Hole

LEGEND:

- 14-End Hole
- 15-Cross-Drilled Hole

Install pin in bushing so the cross-drilled hole is toward the link wear surface. Install all pins so end hole (14) is toward the same side of chain, either left or right.

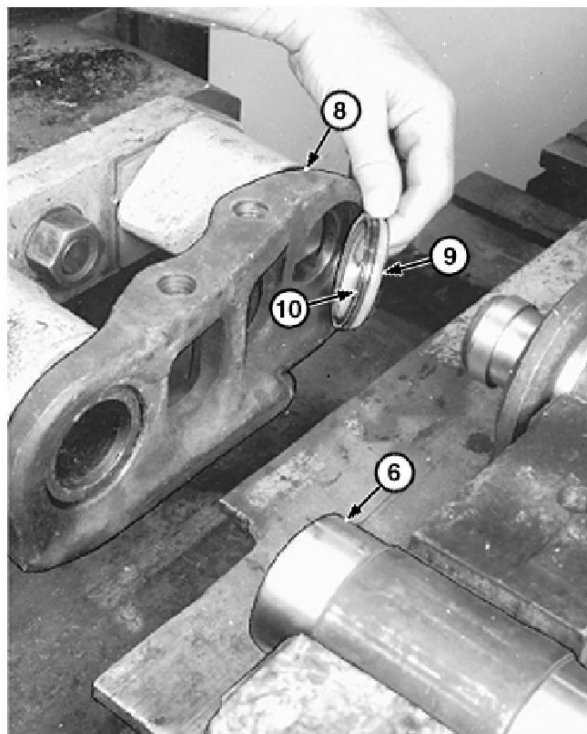

30. TX1195119A-UN: Bushing in Front Saddle

LEGEND:

- 6-Bushing
- 8-Left Link
- 9-Seal Ring
- 10-Load Ring

Install bushing in front saddle seat. Install left link and right link on ram plungers.

Assemble the load ring and seal ring. Install the assembly into link counterbore so pointed lip of seal ring is toward bushing.



27. T96278-UN: Thrust Ring
Install a thrust ring on each end of pin.
28. Move completed split link assembly to rear seat of saddle.

Track Roller Disassemble and Assemble

NOTE:

Service parts are not available for the track roller. This procedure is for inspection only.

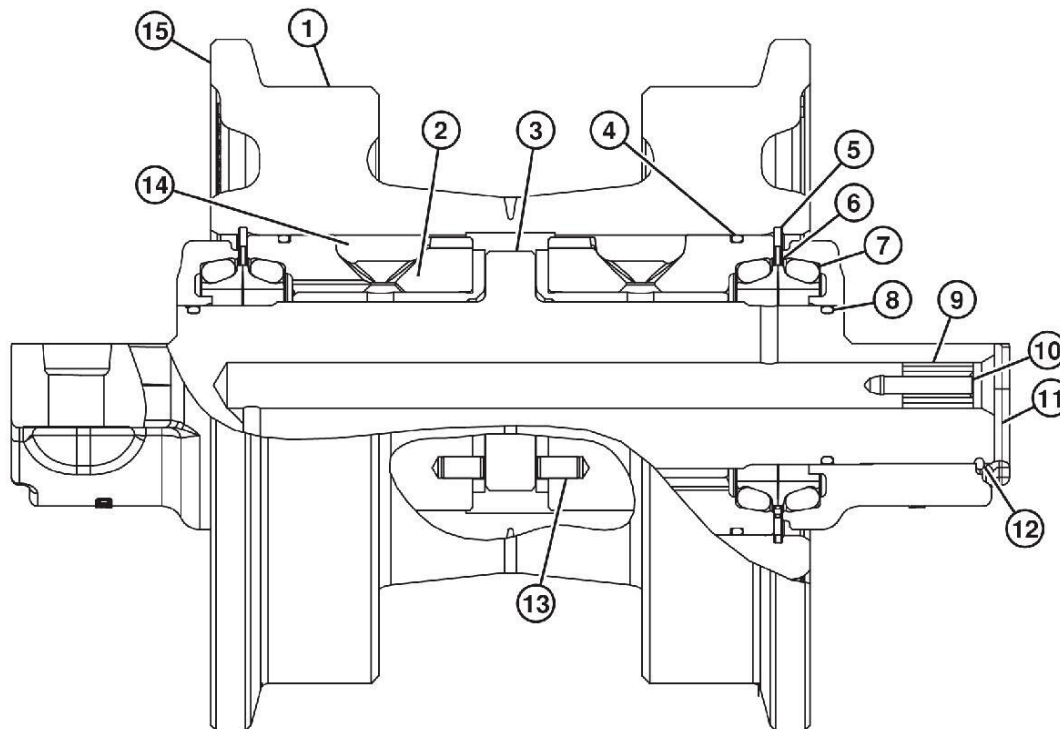
**TX1280236**

TX1280236-UN: Track Roller

LEGEND:

1-Roller Shell**2-Bushing****3-Shaft****4-O-Ring****5-Snap Ring****6-Seal Ring****7-O-Ring****8-O-Ring****9-Plug****10-Plastic Plug****11-Bracket****12-Snap Ring****13-Pin****14-Hub****15-Track Roller**

For more information on track rollers, see Track Rollers - document SP326VOL1 - (SP326VOL1.)

TS50667,00001AC-19-20190627



Thank you very much
for your reading.
Please click here
to get more information.