

# 6135 PowerTech™ Engine Cutaway View

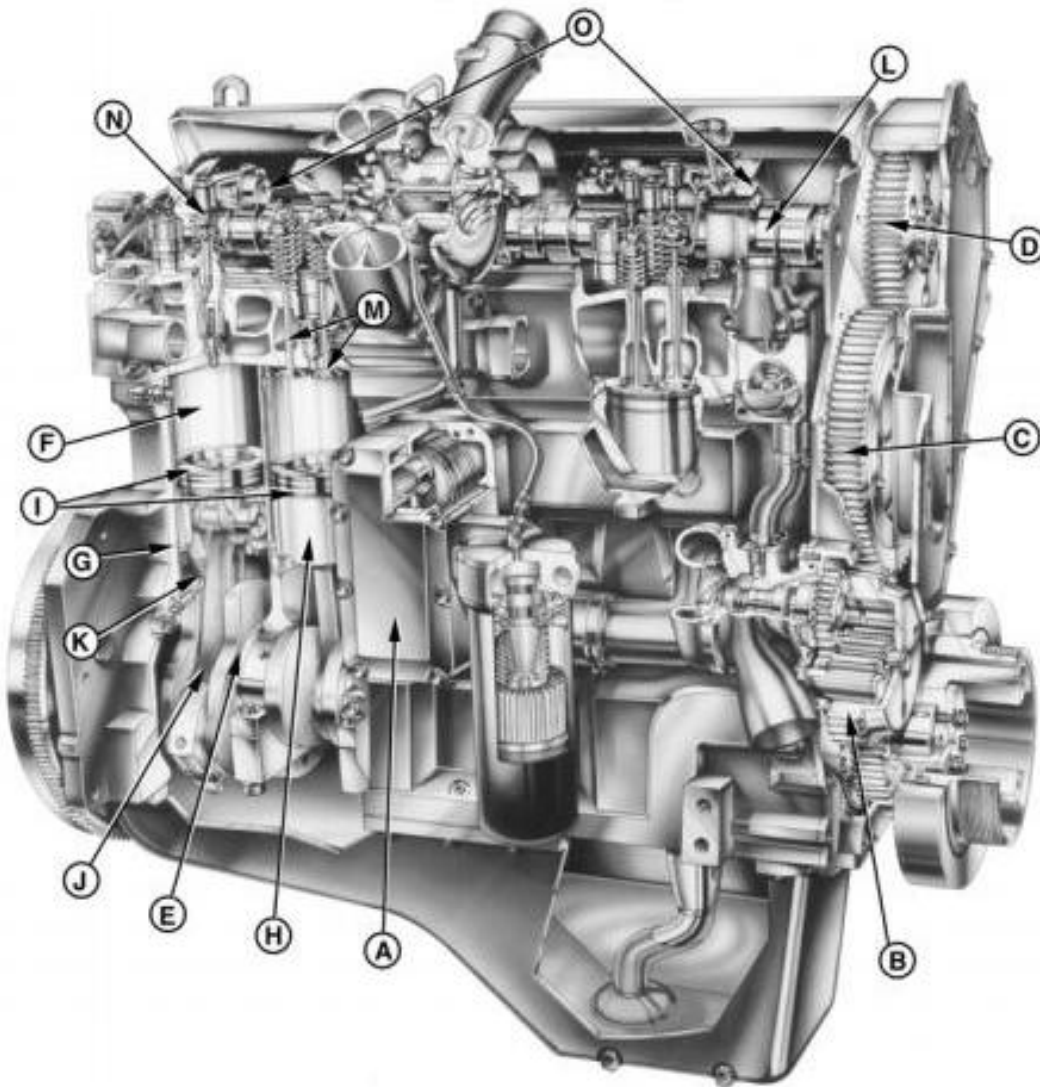

## Engine Cutaway View

### LEGEND:

A	Oil Cooler
B	Oil Pump Drive
C	Idle Gear
D	Camshaft Gear
E	Crankshaft
F	Cylinder Liner
G	Cylinder Liner O-Rings
H	Piston
I	Piston Rings
J	Connecting Rod
K	Oil Spray Jet
L	Camshaft
M	Valves
N	Electronic Unit Injector
O	Two-Piece Rocker Arm Shaft

PDF



DOWNLOAD



## Install Valves

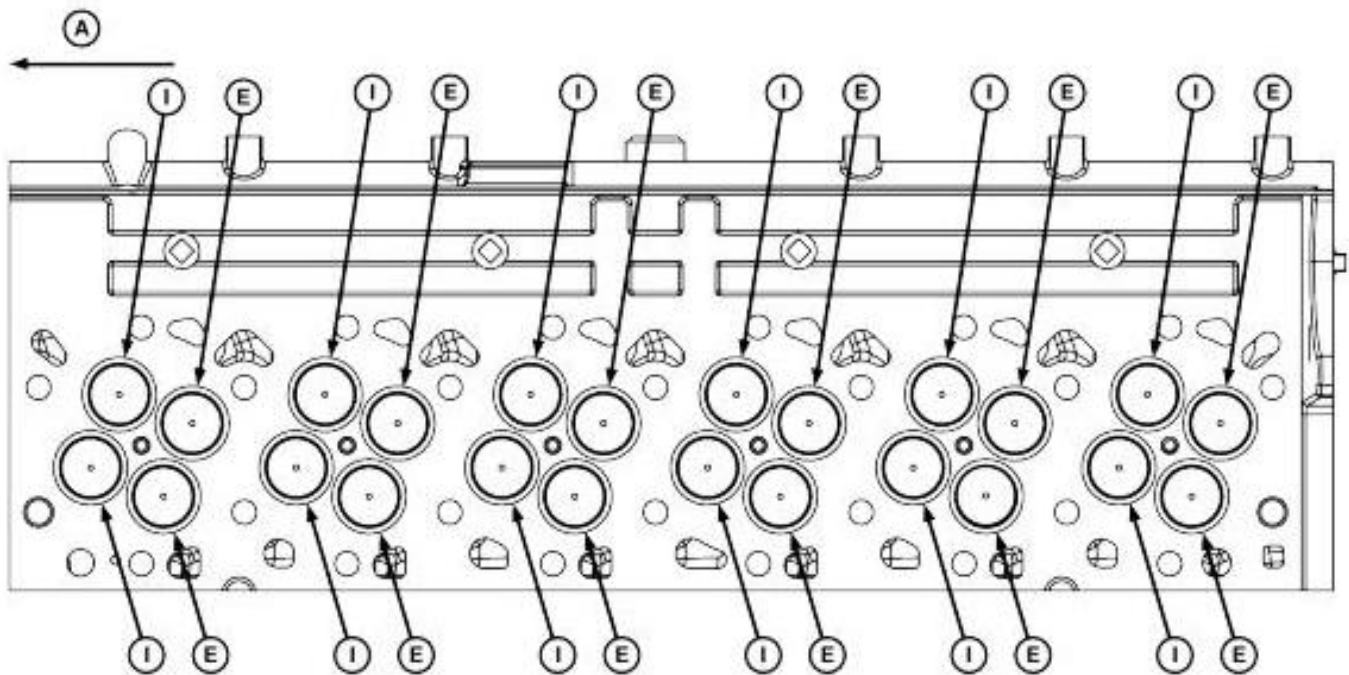

### Installing Valves

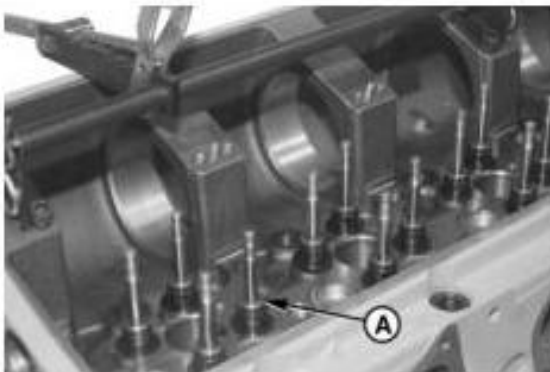

### Installing Valve Stem Seals

#### LEGEND:

A Valve Stem Seals

[1] - Lubricate valve stems and guides with AR44402 Valve Stem Lubricant or clean engine oil.

Number	Name	Use
• AR44402 (us)	Valve Stem Lubricant	Lubricate valve stems.

[2] -

#### →NOTE:

**Valve must move freely in guide and seat properly with inserts to form an effective seal.**

Insert valves in head (if valves are reused, install in same location from which removed).

## Install Engine Oil Pan

[1] -

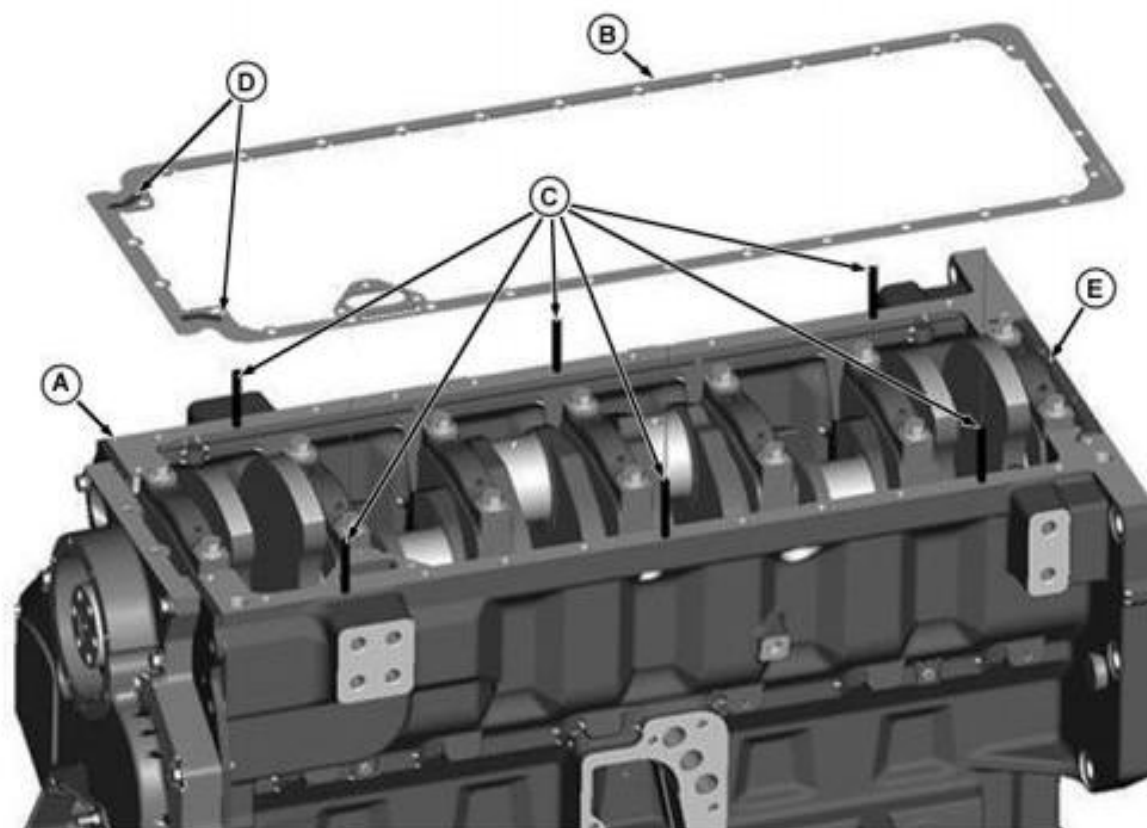

### Guide Pins and Oil Pan Gasket

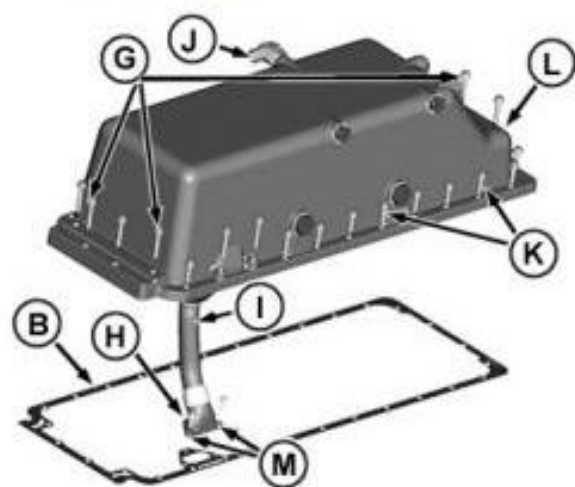

### Oil Pan

#### LEGEND:

A	Cylinder Block
B	Oil Pan Gasket
C	Guide Pins
D	Slotted Holes
E	Rear Oil Seal Housing T - Joints
G	Long Flanged Cap Screws
H	Serrated Head Cap Screw
I	Oil Pump Intake
J	Oil Pan Valve Assembly
K	Short Flanged Cap Screws



[4] - Bleed fuel system. See [BLEED THE FUEL SYSTEM](#) in Group 150.

## Repair Injection Pump Aneroid (Bosch and Nippondenso)—If Equipped

For aneroid repair and adjustment, have an authorized diesel repair station perform the work.

The aneroid controls fuel delivery to pump when intake manifold pressure is about 100 kPa (1.00 bar) (15 psi) or less. Therefore, all final adjustments are to be made on the test stand with aneroid mounted on injection pump.

### IMPORTANT:

*Correct aneroid adjustments are essential for satisfactory engine performance. Whenever aneroid has been disassembled or adjustments have been altered, injection pump (including aneroid) must be calibrated on test stand before releasing pump for service.*

## Remove Hydraulic Aneroid Activator (Bosch and Nippondenso)—If Equipped

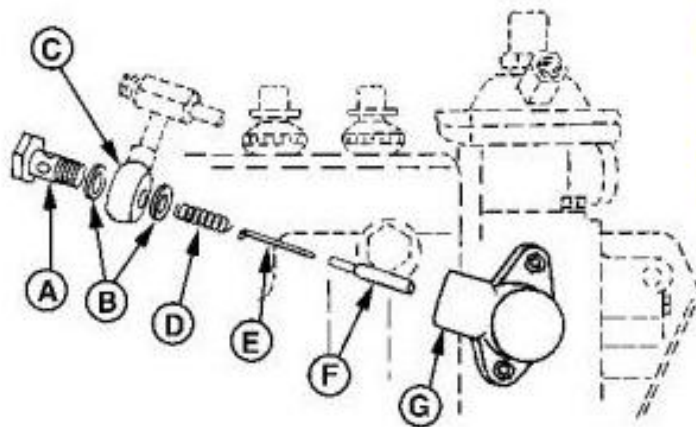

### LEGEND:

A	Special Screw
B	Copper Washer
C	Banjo Connector
D	Spring
E	Restrictor Wire
F	Capillary Valve
G	Activator Housing (2 Used)

### Removing Hydraulic Aneroid Activator

#### →NOTE:

The hydraulic aneroid activator is located on back side of pump governor housing next to cylinder block.

[1] - Remove injection pump as described later in this group.

[2] - Remove special screw (A), copper washers (B) and banjo connector (C). Discard copper washers.

[3] -

#### →NOTE:

Do not bend restrictor wire or other activator parts.

Remove spring (D), restrictor wire (E) and capillary valve (F) from activator housing (G). Remove activator housing.

## Disassemble, Clean, Assemble and Install Hydraulic Aneroid Activator

# CTM415 - John Deere PowerTech Plus & PowerTech E 6135 13.5L Diesel Engines Base Engine Diagnostic&Repair Manual

Illustrated Factory Component Technical Manual for PowerTech, PowerTech Plus & PowerTech E 13.5L Diesel Engines Base Engine (John Deere Diesel OEM Engines) This manual contains high quality images, diagrams, instructions to help you to operate, maintenance, diagnostic, and repair your truck. This document is printable, without restrictions, contains searchable text, bookmarks, crosslinks for easy navigation. Language: English Format: PDF, 531 pages Covered models: 6135AFM75, 6135AFM85 6135HDW01, 6135HDW03, 6135HDW13 6135HF475, 6135HF485 6135HFC46, 6135HFC48 6135HFG84 6135HH001, 6135HH002, 6135HH004 6135HN001, 6135HN003, 6135HN004 6135HRW01, 6135HRW02, 6135HRW04 6135HZ006, 6135HZ006A, 6135HZ006B, 6135HZ006C 6135HZ007A, 6135HZ007B, 6135HZ007C 6135HZ008 6135RW201, 6135RW203 6135SFM85



Thank you very much  
for your reading.  
Please click here  
to get more information.