

2008 Doosan DX60R Crawled Excavator Service Repair Workshop Manual



Solar 015 PLUS

Shop Manual

023-00038E

Serial Number 1001 and Up

Daewoo reserves the right to improve our products in a continuing process to provide the best possible product to the market place. These improvements can be implemented at any time with no obligation to change materials on previously sold products. It is recommended that consumers periodically contact their distributors for recent documentation on purchased equipment.

This documentation may include attachments and optional equipment that is not available in your machine's package. Please call your distributor for additional items that you may require.

Illustrations used throughout this manual are used only as a representation of the actual piece of equipment, and may vary from the actual item.

CYLINDER BLOCK

Construction

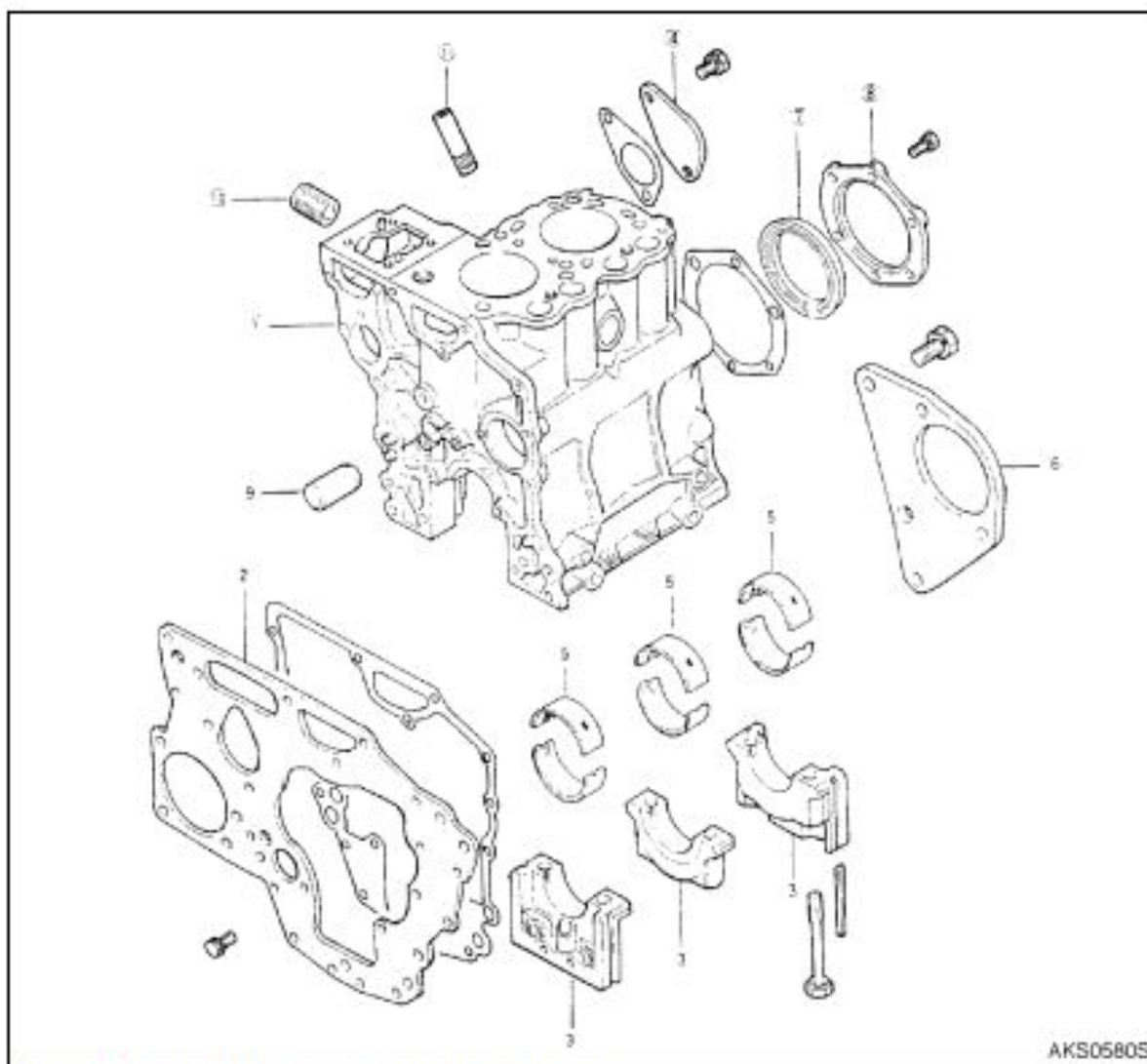

Figure 92 CYLINDER BLOCK COMPONENT PARTS

Reference Number	Description
1	Cylinder Block
2	Front Plate
3	Bearing Cap
4	Cover
5	Main Bearing
6	Starter Bracket

Reference Number	Description
7	Rear Oil Seal
8	Oil Seal Case
9	Idler Gear Shaft
10	Oil Filter Shaft
11	Oil Level Dipstick Guide

Adjustment

Adjust injection start pressure by increasing or decreasing thickness of shim washer to be insert.

Varying shim thickness by 0.10 mm (0.0039 in) causes injection start pressure to change 10.0 kg/cm² (142 psi).

Available shims:

10 kinds of shims available from 1.25 - 1.7 mm (0.0492 - 0.0669 in) in thickness, 0.050 mm (0.0020 in) increments.

Injection Start Pressure	
Standard	140 \pm ¹⁰ kg/cm ² (1,990 \pm ¹⁴² psi)
Allowable limit	130.0 kg/cm ² (1,850 psi) or less

Installation

1. Clean nozzle holder fitting surface of cylinder head. Install nozzle holder with a gasket interposed.

NOTE: Tightening torque 5.0 - 6.0 kg•m (36 - 43 ft lb).

2. Connect fuel return pipe and injection pipe.

NOTE: Tightening torque:

Injection pipe 2.5 - 3.5 kg•m (18 - 25 ft lb).

Fuel return pipe 2.5 - 3.0 kg•m (18 - 22 ft lb).

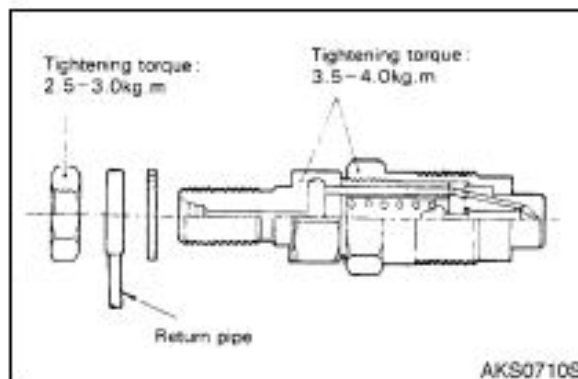

Figure 107 ASSEMBLING NOZZLE

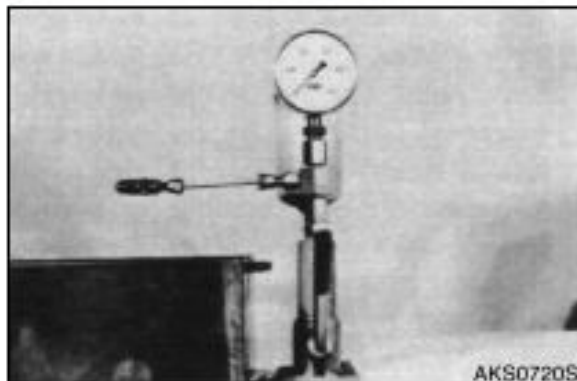

Figure 108 TESTING NOZZLE



Figure 109 INSTALLING NOZZLE

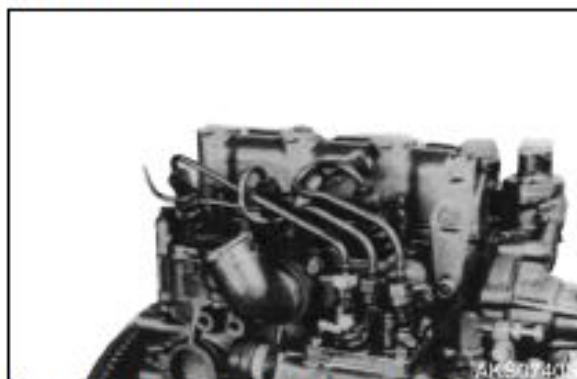

Figure 110 INSTALLING INJECTION PIPE



Thank you very much
for your reading.
Please click here
to get more information.