

2009 Doosan DX53W Wheeled Excavator Service Repair Workshop Manual



Solar 030 Plus / 035

Shop Manual

023-00046E

Serial Number 101 and Up

Serial Number 20001 and Up

Yanmar reserves the right to improve our products in a continuing process to provide the best possible product to the market place. These improvements can be implemented at any time with no obligation to change materials on previously sold products. It is recommended that consumers periodically contact their distributors for recent documentation on purchased equipment.

This documentation may include attachments and optional equipment that is not available in your machine's package. Please call your distributor for additional items that you may require.

Illustrations used throughout this manual are used only as a representation of the actual piece of equipment, and may vary from the actual item.

9.2. CONSTRUCTION

• SOLAR 030 Plus

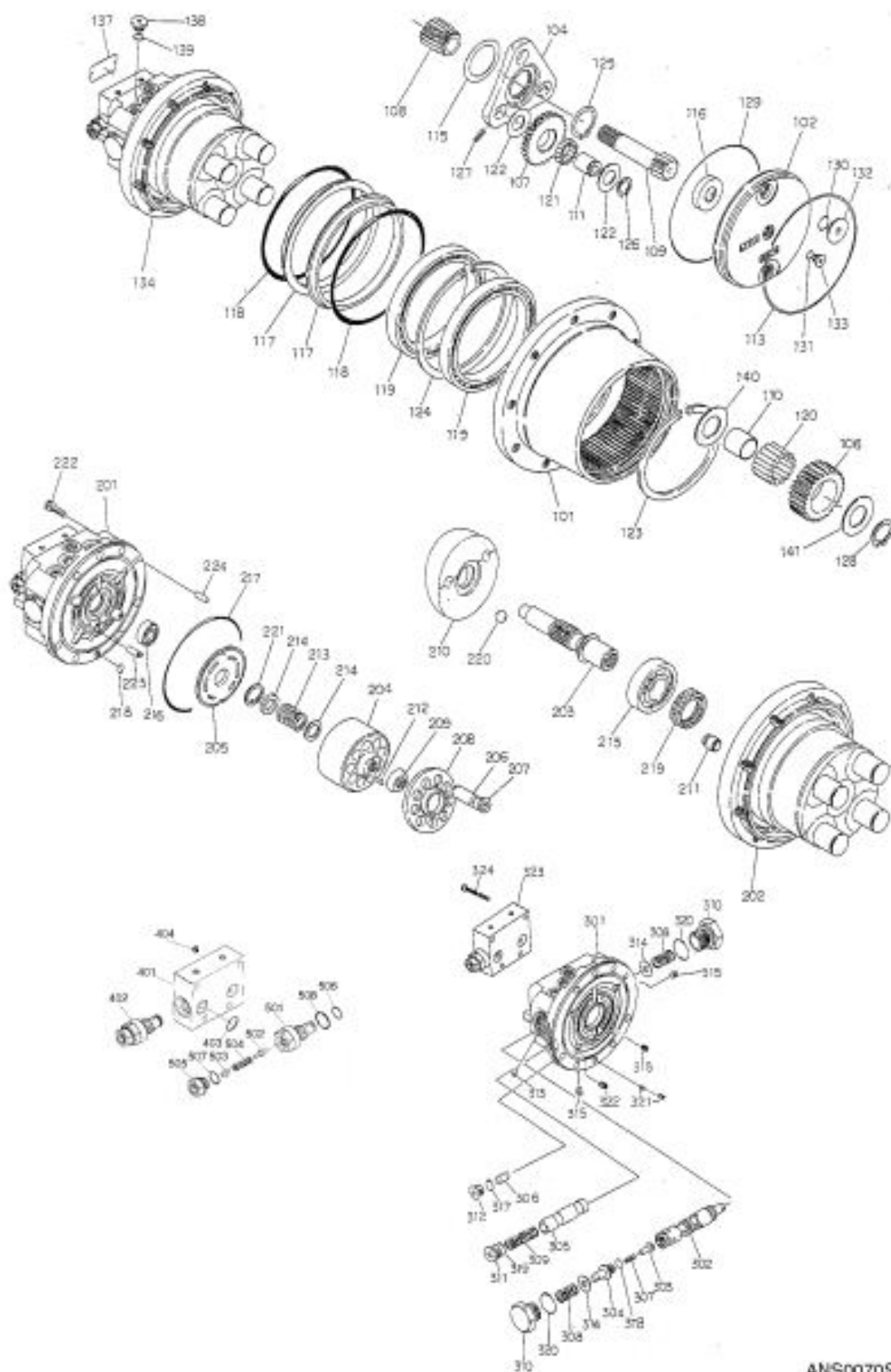

ANS0070S

MAINTENANCE

1. VALVE CLEARANCE AND ADJUSTMENT

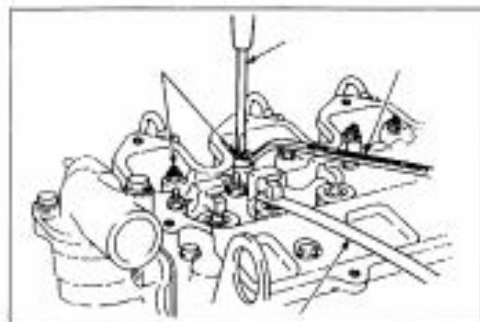

Fig. 20

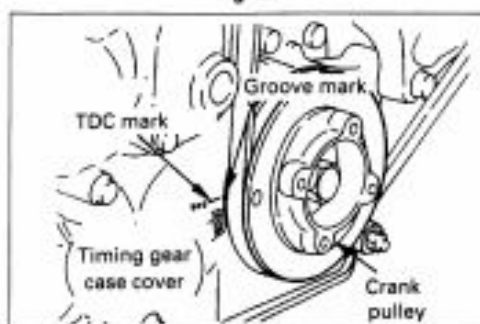

Fig. 21

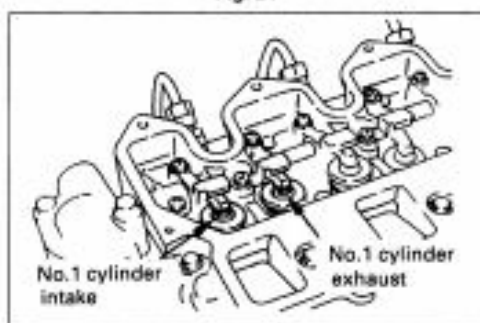

Fig. 22

Cylinder No.	1		2		3	
Valve arrangement	I	E	I	E	I	E
No. 1 cylinder TDC for compression	○	○	○			○
No. 1 cylinder TDC for exhaust				⊕	⊕	

I; Intake E; Exhaust

Fig. 23

Note:

The cylinder head bolts were previously tightened with the "Angular Tightening Method". Therefore, it is not necessary to retighten the cylinder head bolts before adjusting the valve clearance.



1. Bring the piston in either the No. 1 cylinder or the No. 3 cylinder to Top Dead Center on the compression stroke by turning the crankshaft until the TDC mark on the front cover aligns with the groove mark on the crankshaft pulley.

2. Check to see if there is play in the No. 1 intake and exhaust valve rocker arms.

If the No. 1 cylinder intake and exhaust valve rocker arms have play, the No. 1 piston is at TDC on the compression stroke.

If the No. 1 cylinder intake and exhaust valve rocker arms are depressed, the No. 3 piston is at TDC on the compression stroke.

Adjust the No. 1 or the No. 3 cylinder valve clearances while their respective cylinders are at TDC on the compression stroke.

mm (in.)

Intake and Exhaust Valve Clearance (cold)	0.20 ± 0.05 (0.008 ± 0.002)
---	-----------------------------



3. Loosen each valve clearance adjusting screw as shown in the illustration.
4. Insert a 0.20 mm (0.008 in) feeler gauge between the rocker arm and the valve stem end.
5. Turn the valve clearance adjusting screw until a slight drag can be felt on the feeler gauge.
6. Tighten the lock nut securely.
7. Rotate the crankshaft 360°.
Realign the crankshaft pulley.
8. Adjust the clearances for the remaining valves as shown in the illustration.



Thank you very much
for your reading.
Please click here
to get more information.