

# 2014 Doosan DX340LC-5/DX350LC-5 Crawled Excavator Service Repair Workshop Manual



PDF



DOWNLOAD





---

# Shop Manual

# **DX340LC-5/DX350LC-5**

# **Excavator**

---

**Serial Number 10001 and Up**

DOOSAN and the DOOSAN logo are registered trademarks of DOOSAN Corporation in the United States and various other countries around the world.



950106-01001E

April 2014

# REMOVAL

## WARNING

### AVOID DEATH OR SERIOUS INJURY

Death or serious injury can occur from a counterweight falling during removal or installation. Do not allow personnel under or around the counterweight during removal or installation.

Use certified cables and shackles of adequate load rating. Improper lifting can allow the load to shift and cause death or serious injury.

1. Park on firm and level ground.
2. Lower front attachment (bucket) to ground.
3. Stop engine.
4. Move safety lever to "UNLOCK" position.
5. Turn starter switch to "I" (ON) position.

## WARNING

### AVOID DEATH OR SERIOUS INJURY

If engine must be running while performing maintenance, use extreme care. Always have one person in the cabin at all times. Never leave the cabin with the engine running.

6. Fully stroke work levers (joysticks) in all directions to relieve any pressure from accumulators.
7. Move safety lever to "LOCK" position.
8. Turn key to "O" (OFF) position and remove from starter switch.
9. Attach a maintenance warning tag on controls.
10. Turn battery disconnect switch to "OFF" position.
11. Make sure all electrical and other items are disconnected.
12. Using a suitable lifting device capable of handling the weight of the counterweight, partially support counterweight from lifting holes (6, Figure 5), counterweight (1) before loosening four bolts (2). Stop lifting with assist crane as soon as lifting slings are taut.
13. Remove four bolts (2, Figure 5), washers (3) and shims (5) from counterweight (1).

- Tool: 60 mm ()
- Weight: 7,100 kg (15,650 lb)

**NOTE:** Heat bolts, if necessary, to free them.

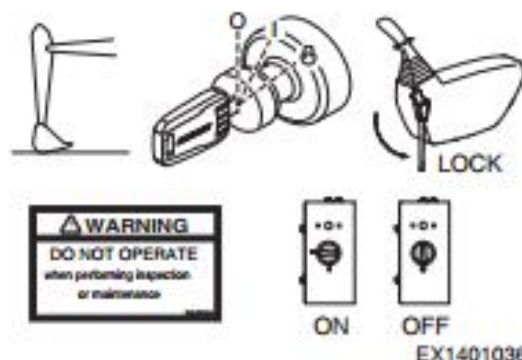

Figure 4

EX1401036

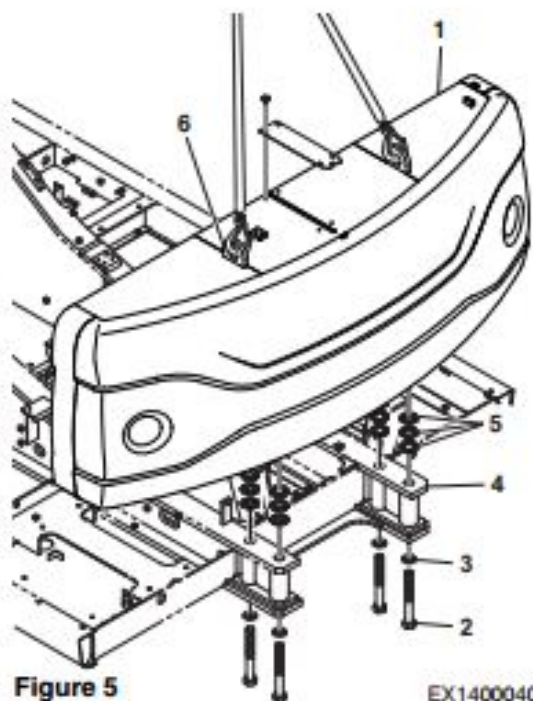
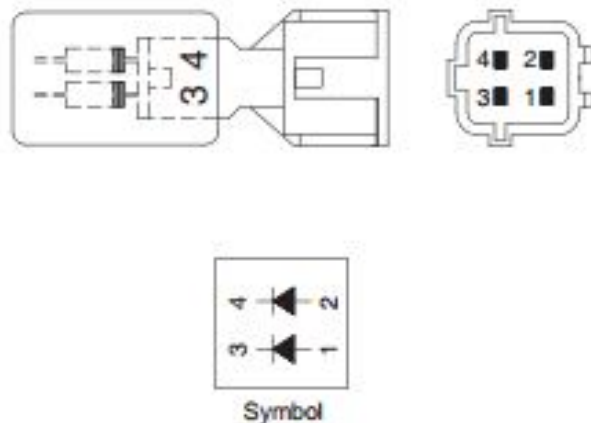

Figure 5

EX1400040



## DA1



Diode Array 1-1: ECU Switch Diode

Diode Array 1-2: Key Switch BR Terminal Switch Diode

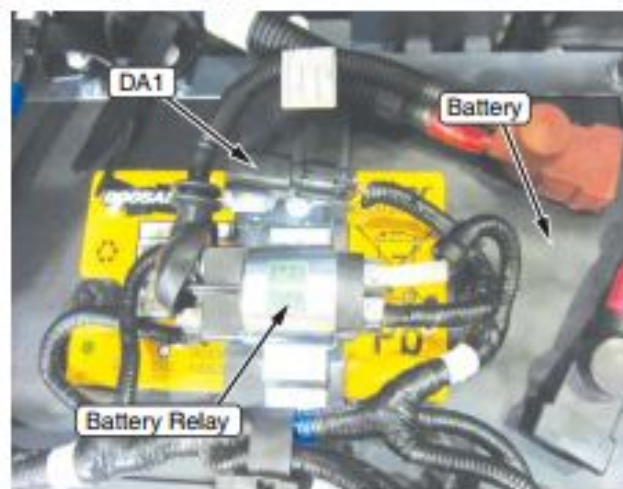

EX1502258

Figure 12

## D2

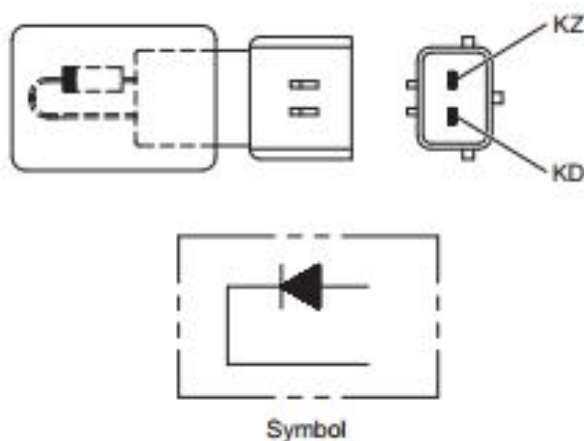

Diode 2: Quick Clamp Sol Valve Fly Wheeling Diode

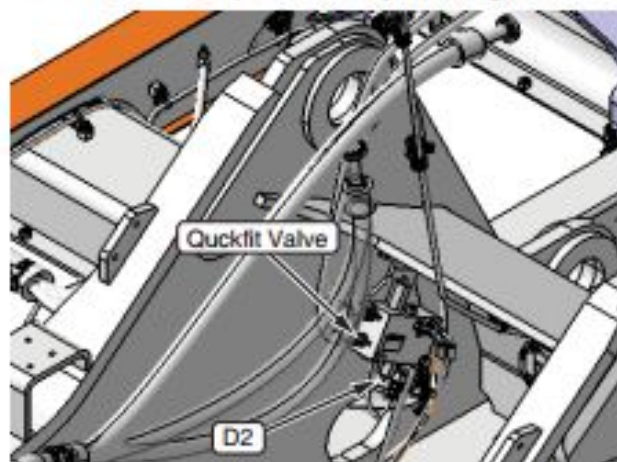

EX1502259

Figure 13



Thank you very much  
for your reading.  
Please click here  
to get more information.