

Allison Transmissions TS3989EN Engine Repair Manual

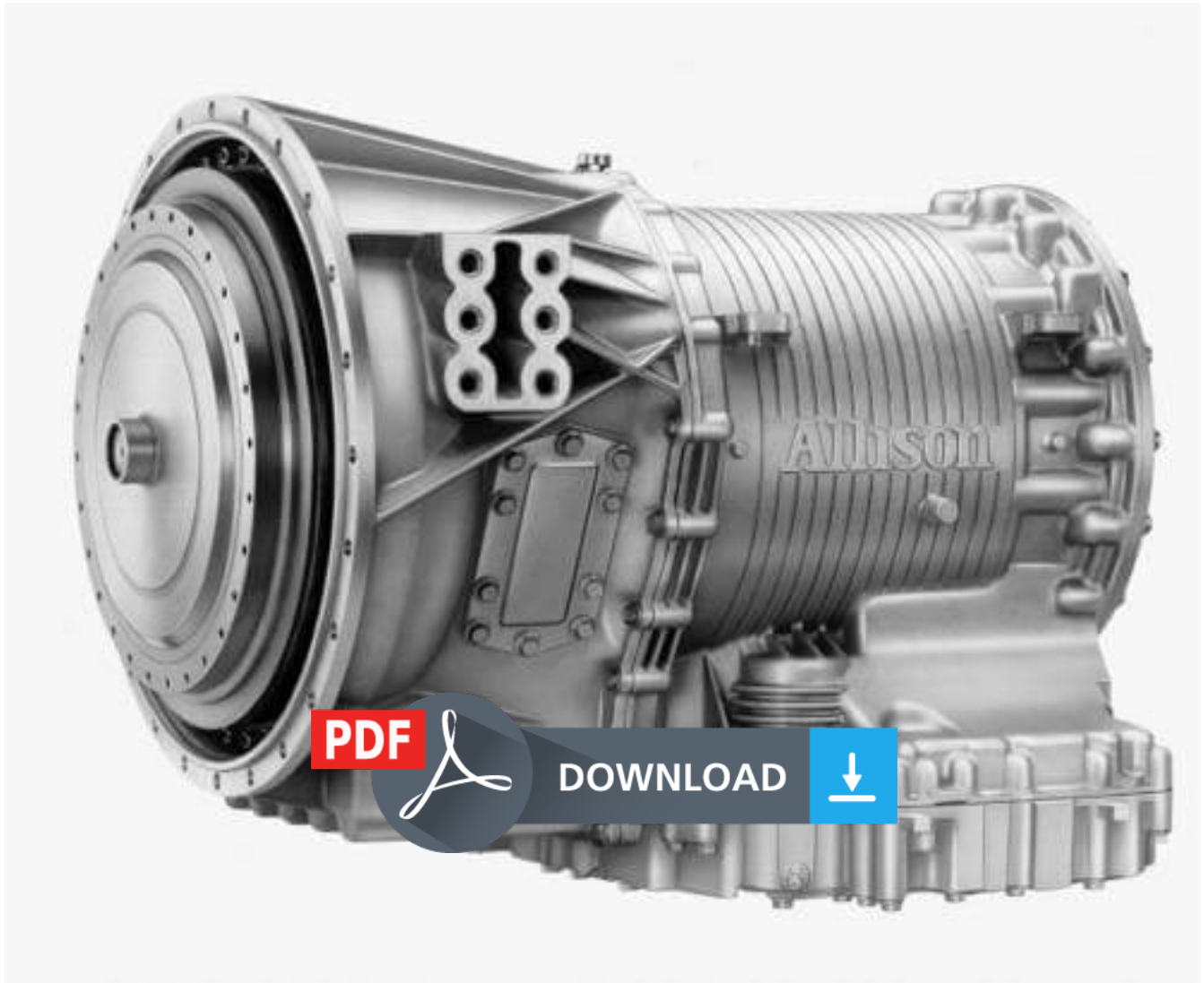

Troubleshooting Manual

2005 DECEMBER
REV. 1 2006 MARCH
REV. 2 2006 OCTOBER

TS3989EN

Allison Transmission

Open front screen

VOCATIONAL MODELS

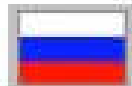

3000 VOCATIONAL MODELS

3000 HS	3500 RDS	B 300(P)(R)
3000 RDS	3500 EVS	B 400(P)(R)
3000 EVS		T 200
3000 MH		T 300
3000 PTS		
3000 TRV		
3200 SP	3500 SP	3700 SP
3200 TRV		

4000 VOCATIONAL MODELS

4000 EVS	4500 EVS	4700 EVS	4800 EVS	B 500
4000 HS	4500 HS	4700 RDS		B 500P
4000 MH	4500 RDS	4700 OFS		B 500R
4000 RDS	4500 SP			B 500PR
4000 TRV	4500 TRV			T 425
				T 450



Allison Transmission, Inc.
P.O. Box 894 Indianapolis, Indiana 46206-0894
www.allisontransmission.com

TABLE OF CONTENTS

	Page
Foreword	ii
SAFETY INFORMATION	
Important Safety Notice	III
Warnings, Cautions, and Notes	III
Trademarks Used in This Manual	IV
Shift Selector Terms and Display Indications	IV
SECTION 1. GENERAL DESCRIPTION	
1-1. TRANSMISSION	1-1
1-2. TRANSMISSION CONTROL MODULE (TCM)	1-3
1-3. SHIFT SELECTOR	1-4
A. Pushbutton Shift Selector	1-4
B. Lever Shift Selector	1-5
1-4. THROTTLE POSITION SENSOR	1-5
1-5. SPEED SENSORS	1-6
1-6. CONTROL MODULE	1-7
1-7. WIRING HARNESSSES	1-9
A. External Wiring Harness	1-9
B. Internal Wiring Harness	1-11
1-8. VEHICLE INTERFACE MODULE	1-12
1-9. AUTODETECT FEATURE	1-12
A. Retarder	1-13
B. Oil Level Sensor (OLS)	1-13
C. Throttle Source	1-13
D. Engine Coolant Temperature	1-14
1-10. TRANSID (TID)	1-14
SECTION 2. DEFINITIONS AND ABBREVIATIONS	
2-1. CHECK TRANS LIGHT	2-1
2-2. ALLISON TRANSMISSION DIAGNOSTIC TOOL	2-1
2-3. ABBREVIATIONS	2-3

GENERAL DESCRIPTION

B. Internal Wiring Harness (Figure 1-10)

The internal wiring harness provides connection between the following:

- External harness
- Pressure control and shift solenoids
- Oil level sensor
- Diagnostic pressure switch
- Temperature sensor
- Turbine speed sensor.

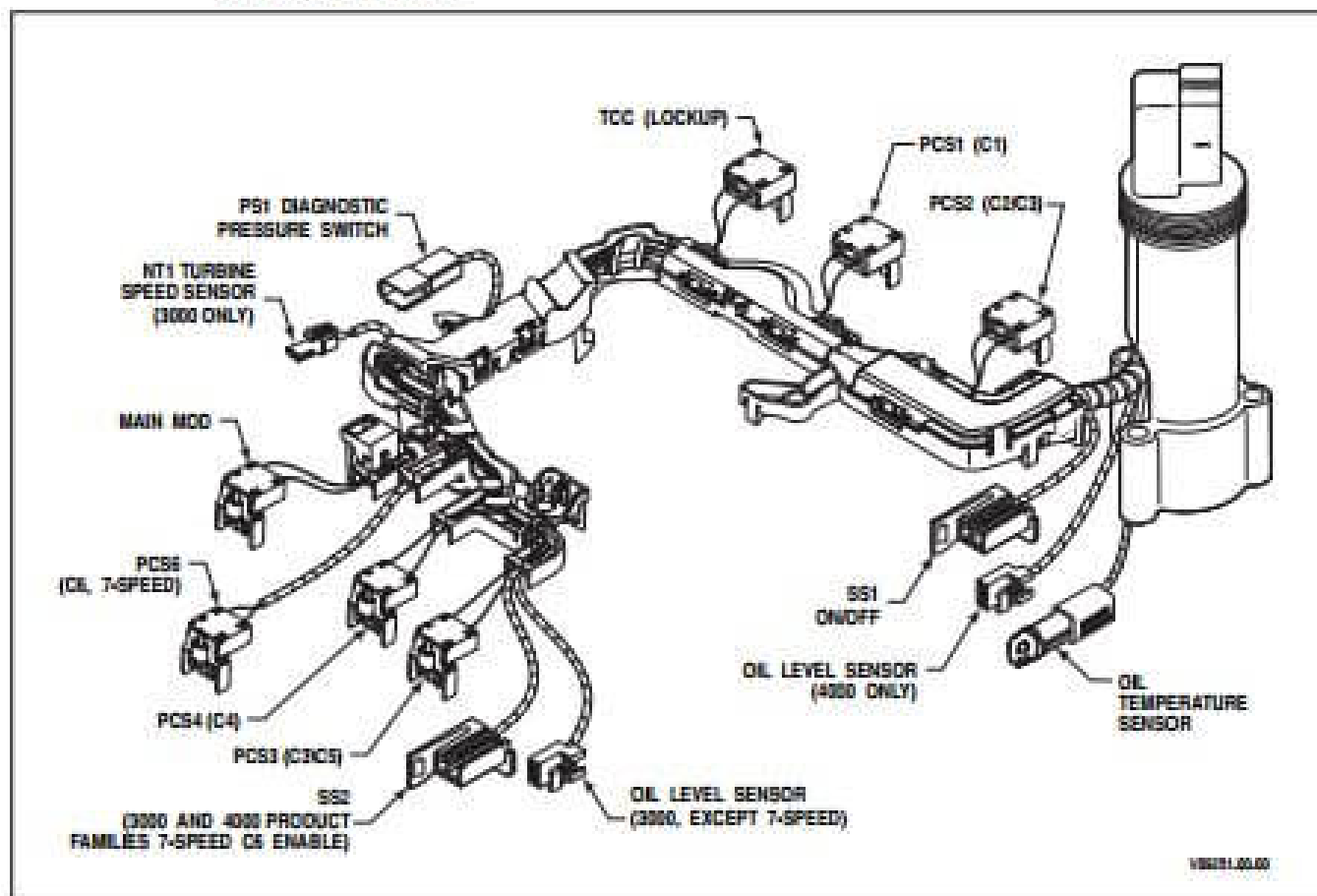

Figure 1-10. Allison 4th Generation Internal Wiring Harness



Thank you very much
for your reading.
Please click here
to get more information.