

BMW F650CS Motorcycle Service Repair Workshop Manual



Repair Manual



F 650 CS

BMW Motorrad
After Sales

Contents

Group / Chapter

00 Tightening torques, Operating fluids

00 Pre-delivery check

00 Maintenance

11 Engine

12 Engine electrics

13 Fuel preparation and control

16 Fuel tank and lines

17 Radiator

18 Exhaust system

21 Clutch

23 Gearbox

27 Chain/belt drive

31 Front forks

>> Continuation



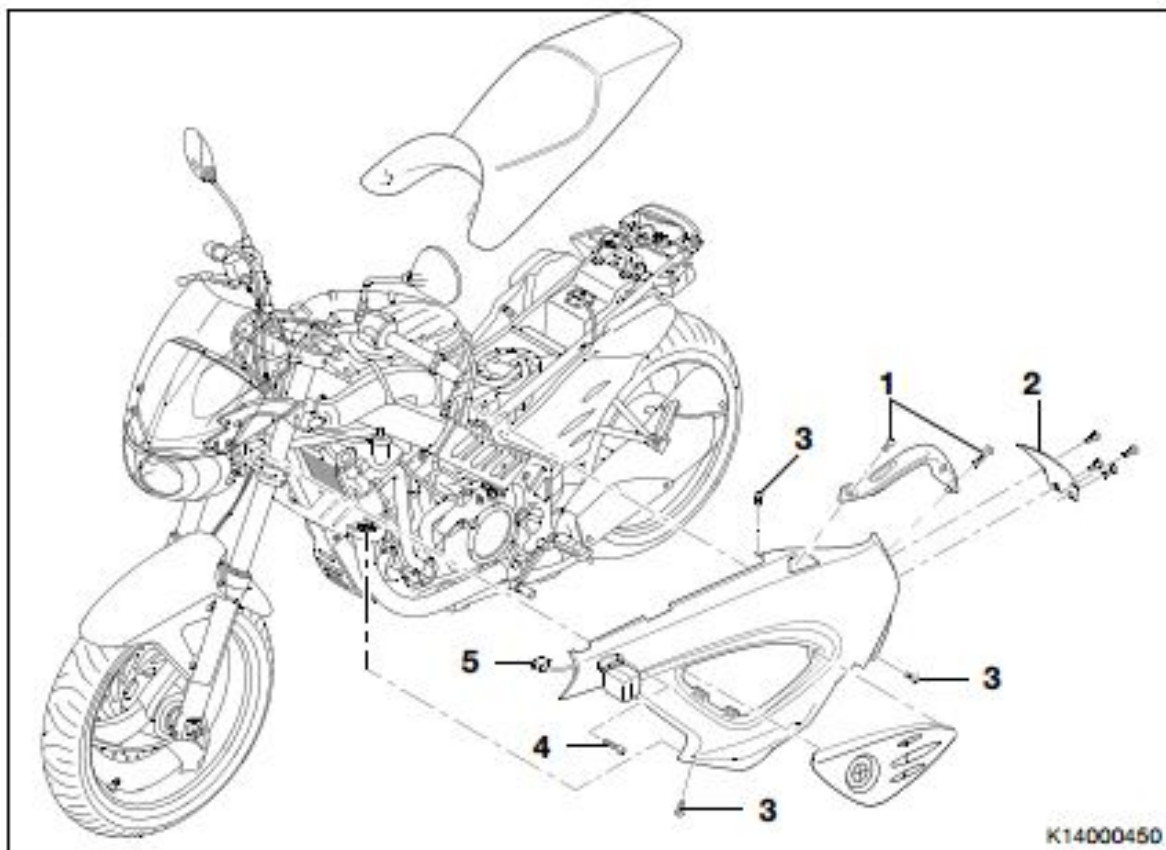

61 21 Filling and charging the battery

61 21 010 Removing the battery

- Place the motorcycle on the auxiliary stand, **BMW No. 00 1 620**.
- Remove seat.
- Remove securing screws for stowage-compartment rail (1) and remove left stowage-compartment rail; use wrench from toolkit if necessary.
- Remove fasteners of rear cover and remove rear cover (2).
- Disconnect the plug for flashing turn indicator (5).
- Remove securing screw for flashing turn indicator (4).
- Remove screws securing left cover (3).
- Remove the left cover.



Thank you very much
for your reading.
Please click here
to get more information.