

John Deere 1795 Planter (SN.760101-) with MaxEmerge 5 Row Units Diagnostic Service Manual (TM131719)



1795 Planter with
MaxEmerge 5 Row Units
(SN. from 760101)
Diagnostic

JOHN HARE

COLLECTION

DIAGNOSIS AND TESTS MANUAL
MaxEmerge 5 models 1795 (SN. 760101-)
TM131719 26 MAY 15 (ENGLISH)

For complete service information also see:

1705 Series Planter Frame Repair	TM131319
MaxEmerge 5 & ExactEmerge Row Unit Repair	TM131219
Machine Connection Information	CTM441
120 Series Hydraulic Cylinders	CTM120519

PDF  **DOWNLOAD** 

John Deere Agriculture
Printed by Belgreen



Covers: 1795,760101)

Type: Service Manual

Language: English

Pages: 1302

Format: PDF

Features: Bookmarked, searchable, printable

Compatibility: Windows/Mac/Tablet/Mobile

This service manual contains important information for the maintenance, troubleshooting and servicing of the **John Deere 1795 Planter (SN.760101-) with MaxEmerge 5 Row Units Diagnostic Service Manual (TM131719)**

In this manual you will find detailed specifications, illustrations, schematics, diagrams and step-by-step procedures to properly service and diagnose the machine to the manufacturer's standards.

Contents:

- General Information
- Specifications
- Serial Number Location
- Engine Specifications
- Engine Diagnostics
- Engine Tests and Adjustments
- Engine Repair
- Power Train
- Transmission
- Axles
- Differential
- PTO
- Hydraulic System
- Electrical System
- Electrical Tests and Diagnostics
- Wiring Diagram / Schematic
- Ignition and Charging
- Steering
- Brakes
- Wheels
- Operator's Platform
- Body Panels
- Disassembly and Assembly
- Diagnostics, Tests and Adjustments
- Troubleshooting
- and much more...

Please note this manual is in **downloadable PDF format only**. If you have any questions about this product or would like to request sample pages, please contact us and reference the product name or SKU.

Group 0225 - Axle Shafts and U-Joints

Universal Joint and Drive Shaft Remove and Install

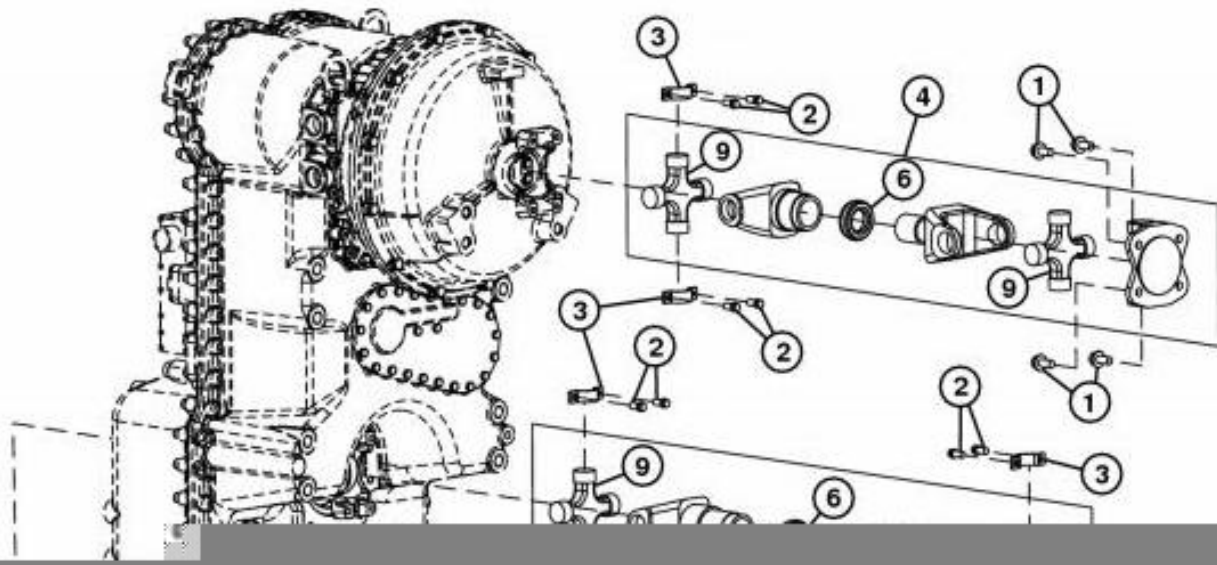

Group 10A - Accessing Diagnostic Trouble Codes

Accessing Diagnostic Trouble Codes

10:26 am

MESSAGE CENTER button (showing time)



MENU button

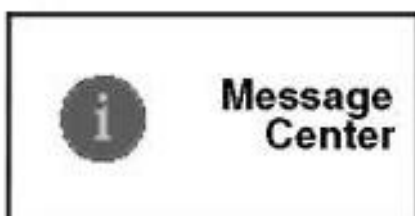

MESSAGE CENTER button (With Info Icon)

Message Center screen can be reached by pressing MESSAGE CENTER button (showing time) or MENU button then MESSAGE CENTER button (With Info Icon).



TROUBLE CODES soft-key (H)

Select Diagnostic Trouble Code icon (soft-key H)

Message center will display all active warning, alert messages and icons.

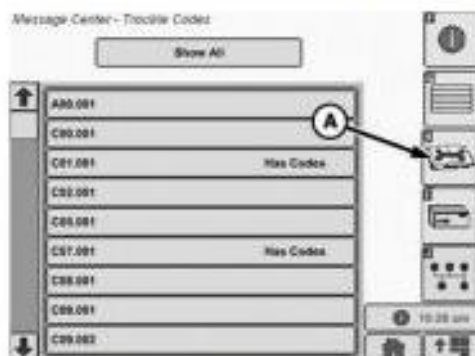

LEGEND:

A Troubles Codes icon (soft-key H)

Trouble Code Main Screen

Trouble Codes

Select TROUBLE CODES button (A), a list of controllers will appear and controllers with diagnostic codes are indicated.

Individual controllers can be accessed by scrolling to desired controller then selecting it, to view codes for that controller.



Thank you very much
for your reading.
Please click here
to get more information.