

# John Deere 225CLC RTS Excavator Diagnostic, Operation and Test Manual (TM2095)

## 490E Excavator Repair

### REPAIR TECHNICAL MANUAL

490E

TM1505 21FEB05 (ENGLISH)

For complete service information also see:

490E Excavator Diagnostic TM1504

North American 3029 , 4039, 4045, 6059  
and 6068 Diesel Engines CTM8

Alternators and Starting Motors CTM77

PowerTech 4.5L & 6.8L Diesel Engines Tier  
1/Stage I, Tier 2/Stage II, Tier 3/Stage IIIA,  
Tier 3/Stage IIA Tier 3/Stage III, (Base  
Engine) CTM104

PDF



DOWNLOAD



John Deere Construction and Forestry

**Type:** Service Manual

**Language:** English

**Pages:** 456

**Format:** PDF

**Features:** Bookmarked, searchable, printable

**Compatibility:** Windows/Mac/Tablet/Mobile

This service manual contains important information for the maintenance, troubleshooting and servicing of the **John Deere 225CLC RTS Excavator Diagnostic, Operation and Test Manual (TM2095)**

In this manual you will find detailed specifications, illustrations, schematics, diagrams and step-by-step procedures to properly service and diagnose the machine to the manufacturer's standards.

**Contents:**

- General Information
- Specifications
- Serial Number Location
- Engine Specifications
- Engine Diagnostics
- Engine Tests and Adjustments
- Engine Repair
- Power Train
- Transmission
- Axles
- Differential
- PTO
- Hydraulic System
- Electrical System
- Electrical Tests and Diagnostics
- Wiring Diagram / Schematic
- Ignition and Charging
- Steering
- Brakes
- Wheels
- Operator's Platform
- Body Panels
- Disassembly and Assembly
- Diagnostics, Tests and Adjustments
- Troubleshooting
- and much more...

Please note this manual is in **downloadable PDF format only**. If you have any questions about this product or would like to request sample pages, please contact us and reference the product name or SKU.

# Cab Electrical Component Identification

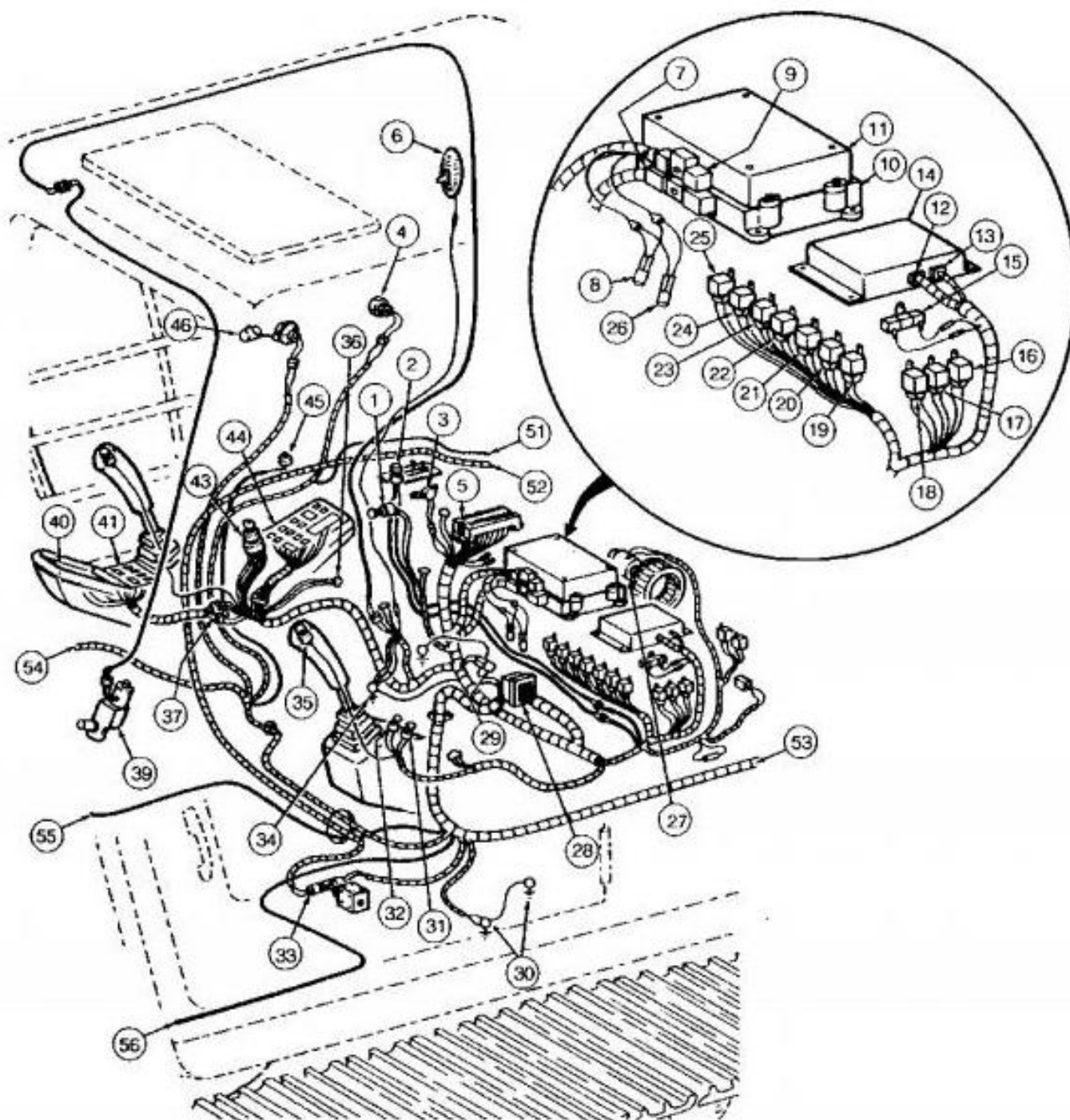

T7685GH (CV)

## Cab Electrical Components

### LEGEND:

- 1 (R2) Cigar Lighter (BRN, BLK)
- 2 (S31) Blower Motor Switch (BRN)
- 3 (B11) Monitor Buzzer (RED/BLK, GRN/BLU)

## Propel Pilot Controller Operation

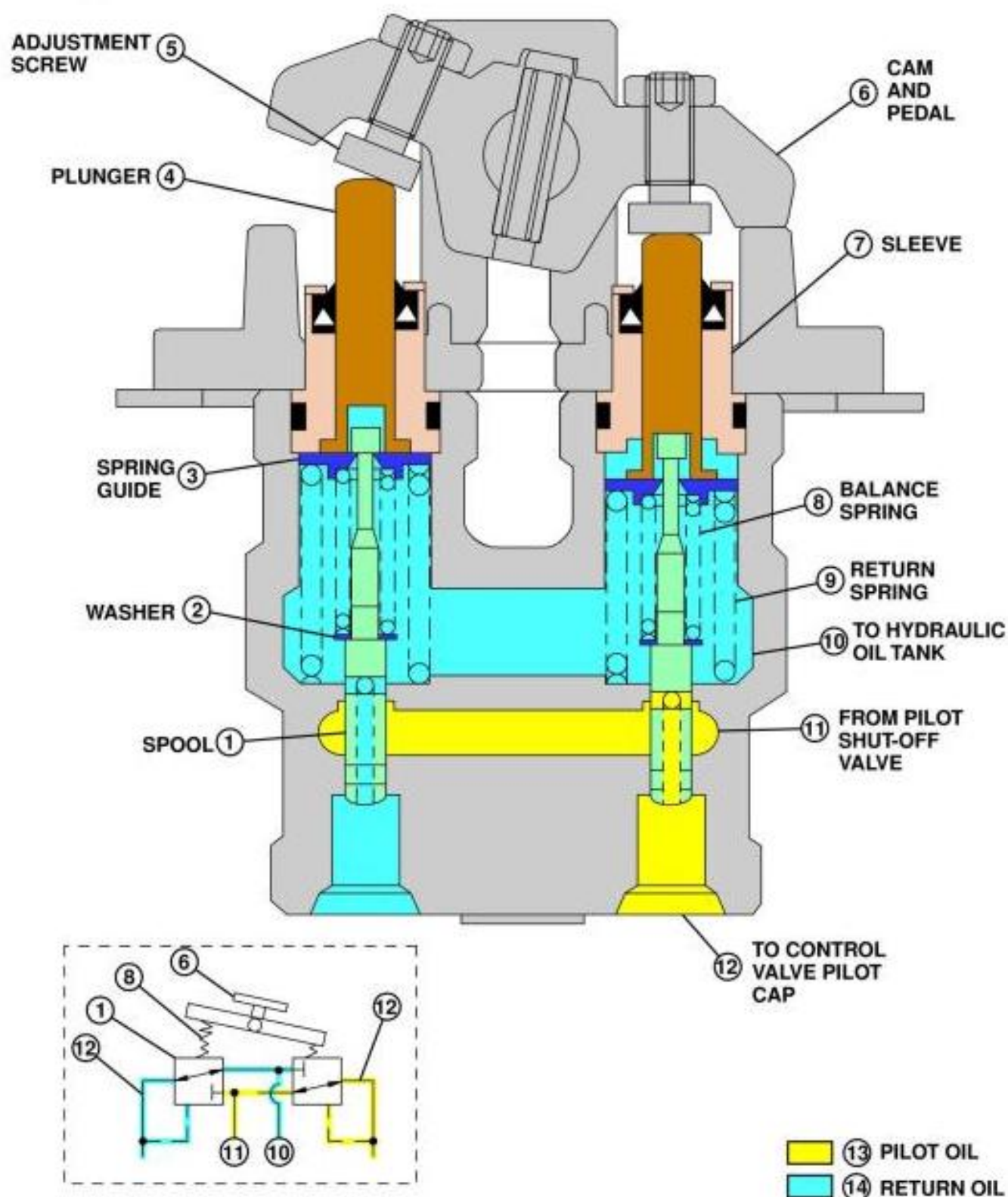

T141666

15 PROPEL PILOT CONTROLLER - FULL STROKE

### Propel Pilot Controller—Full Stroke

#### LEGEND:

- 1 Spool
- 2 Washer
- 3 Spring Guide



Thank you very much  
for your reading.  
Please click here  
to get more information.