

John Deere 304J Loader (SN. from 23372) Diagnostic, Operation and Test Service Manual (TM11216)

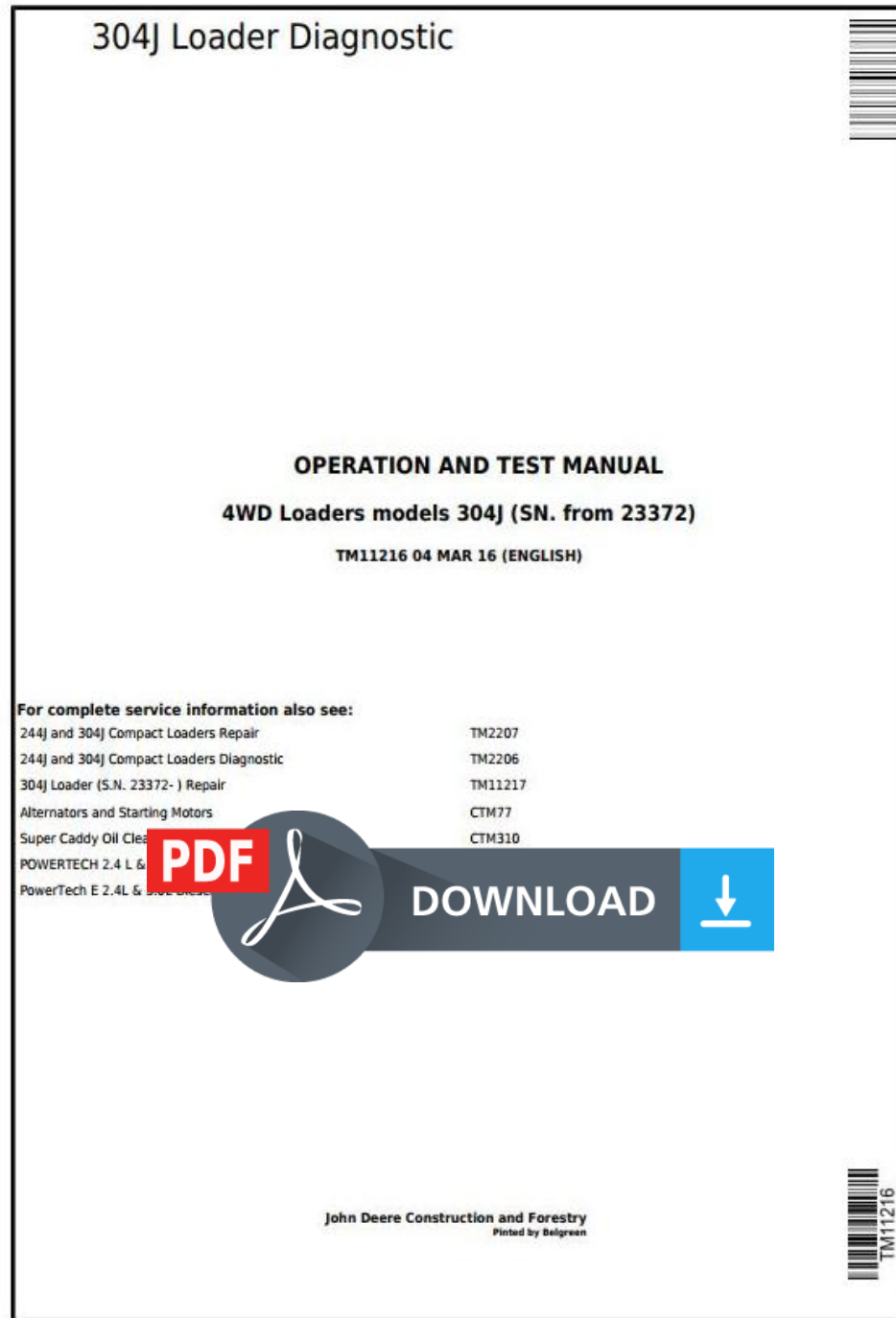

Covers: 304J,23372)

Type: Service Manual

Language: English

Pages: 580

Format: PDF

Features: Bookmarked, searchable, printable

Compatibility: Windows/Mac/Tablet/Mobile

This service manual contains important information for the maintenance, troubleshooting and servicing of the **John Deere 304J Loader (SN. from 23372) Diagnostic, Operation and Test Service Manual (TM11216)**

In this manual you will find detailed specifications, illustrations, schematics, diagrams and step-by-step procedures to properly service and diagnose the machine to the manufacturer's standards.

Contents:

- General Information
- Specifications
- Serial Number Location
- Engine Specifications
- Engine Diagnostics
- Engine Tests and Adjustments
- Engine Repair
- Power Train
- Transmission
- Axles
- Differential
- PTO
- Hydraulic System
- Electrical System
- Electrical Tests and Diagnostics
- Wiring Diagram / Schematic
- Ignition and Charging
- Steering
- Brakes
- Wheels
- Operator's Platform
- Body Panels
- Disassembly and Assembly
- Diagnostics, Tests and Adjustments
- Troubleshooting
- and much more...

Please note this manual is in **downloadable PDF format only**. If you have any questions about this product or would like to request sample pages, please contact us and reference the product name or SKU.

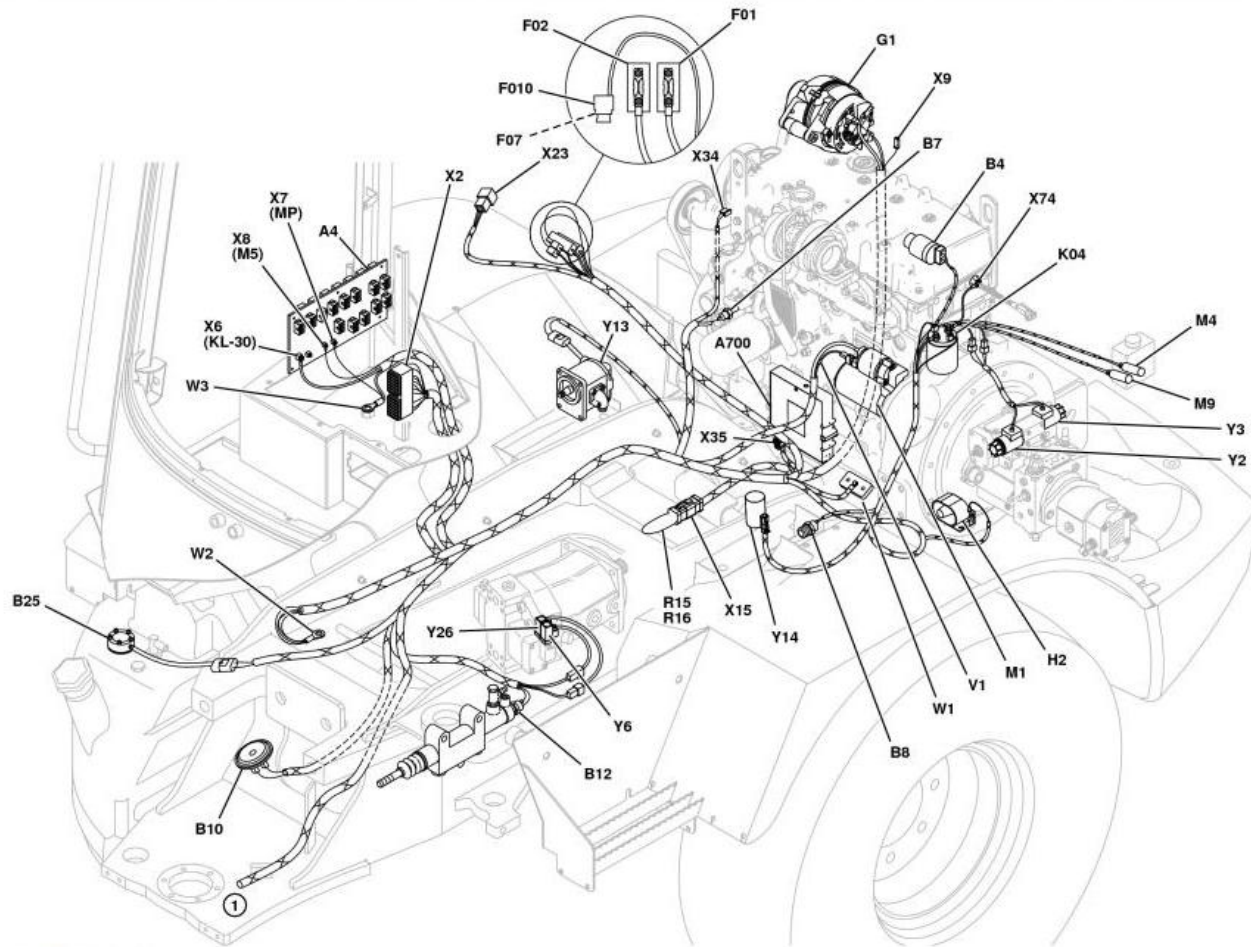

TX1056278
Loader/Rear Frame Harness (W7) Component Location (SHT 2 of 2)

Repair 32 and 48 Way CINCH™ Connectors

[1] -

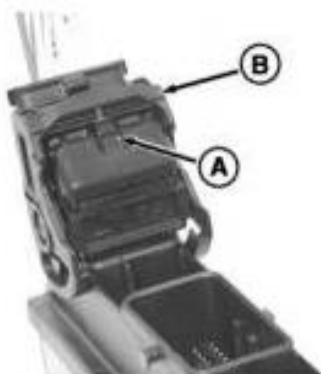

LEGEND:

A	Tab
B	Locking Cam
C	Cover Locks
D	Cover

CINCH™ Connector



CINCH™ Cover Lock Tabs



CINCH™ Cover

Push tab (A) and rotate locking cam (B) 90° to disconnect connector from controller.

[2] - Move cover locks (C) slightly outward with a small screwdriver.

[3] - Remove cover (D) away from wires.

[4] -



LEGEND:

A	Terminal Lock
---	---------------



Thank you very much
for your reading.
Please click here
to get more information.