

# John Deere 653E Tracked Feller Buncher Diagnostic, Operation and Test Service Manual (tm1578)



**Covers:** 653E

**Type:** Service Manual

**Language:** English

**Pages:** 532

**Format:** PDF

**Features:** Bookmarked, searchable, printable

**Compatibility:** Windows/Mac/Tablet/Mobile

This service manual contains important information for the maintenance, troubleshooting and servicing of the **John Deere 653E Tracked Feller Buncher Diagnostic, Operation and Test Service Manual (tm1578)**

In this manual you will find detailed specifications, illustrations, schematics, diagrams and step-by-step procedures to properly service and diagnose the machine to the manufacturer's standards.

**Contents:**

- General Information
- Specifications
- Serial Number Location
- Engine Specifications
- Engine Diagnostics
- Engine Tests and Adjustments
- Engine Repair
- Power Train
- Transmission
- Axles
- Differential
- PTO
- Hydraulic System
- Electrical System
- Electrical Tests and Diagnostics
- Wiring Diagram / Schematic
- Ignition and Charging
- Steering
- Brakes
- Wheels
- Operator's Platform
- Body Panels
- Disassembly and Assembly
- Diagnostics, Tests and Adjustments
- Troubleshooting
- and much more...

Please note this manual is in **downloadable PDF format only**. If you have any questions about this product or would like to request sample pages, please contact us and reference the product name or SKU.

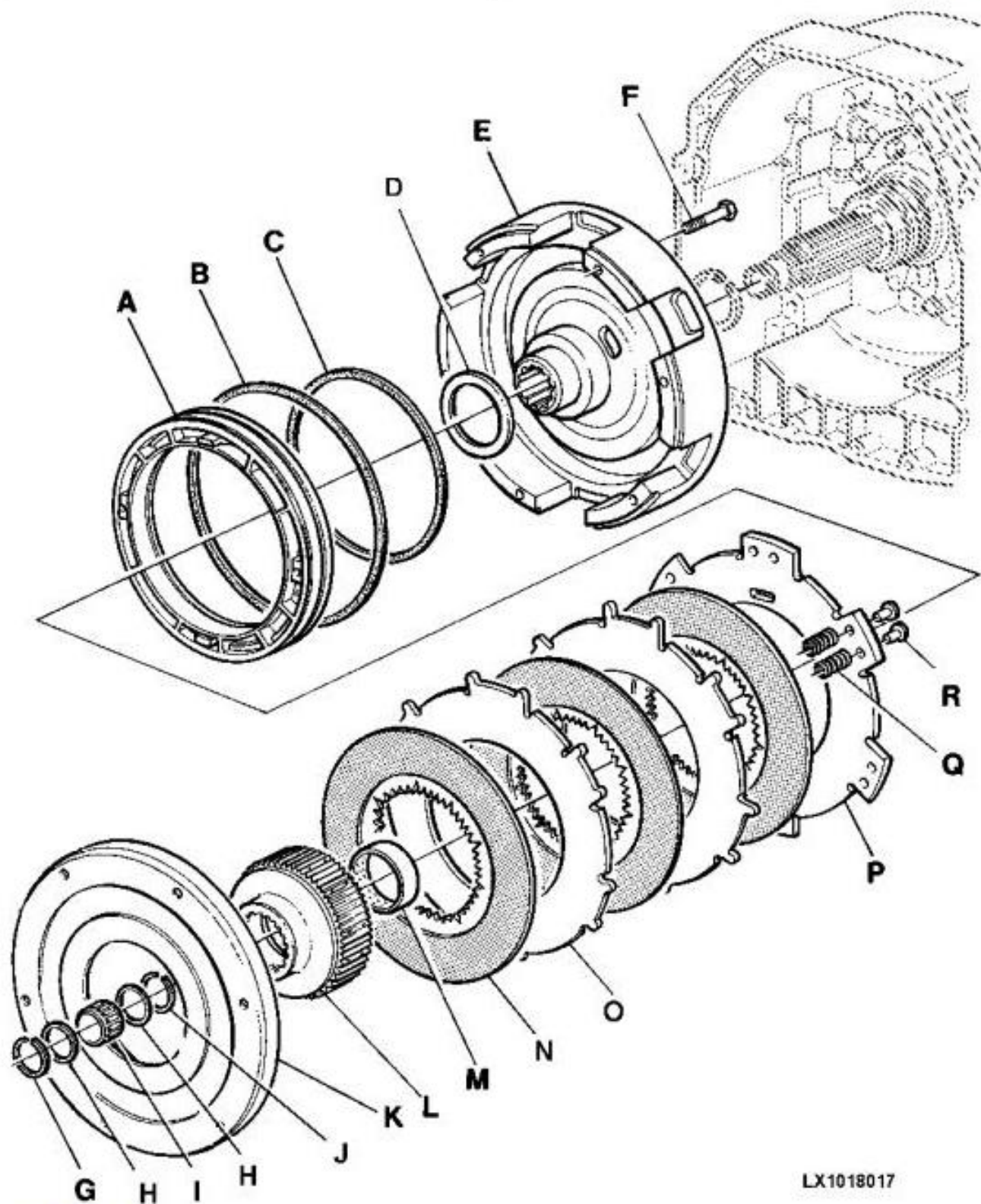

LX1018017

**LEGEND:**

A	Pressure piston
B	Seal ring
C	Seal ring
D	Thrust washer
E	Clutch drum
F	Cap screw
G	Thin snap ring

For some of these tasks, additional special tools are required. See [Air conditioning system - Special tools](#) in Section 90.

**IMPORTANT:**

**Observe the information on filling in refrigerant oil. See [Air conditioning system - Air conditioning service unit, Filling with refrigerant oil](#) in Section 90.**

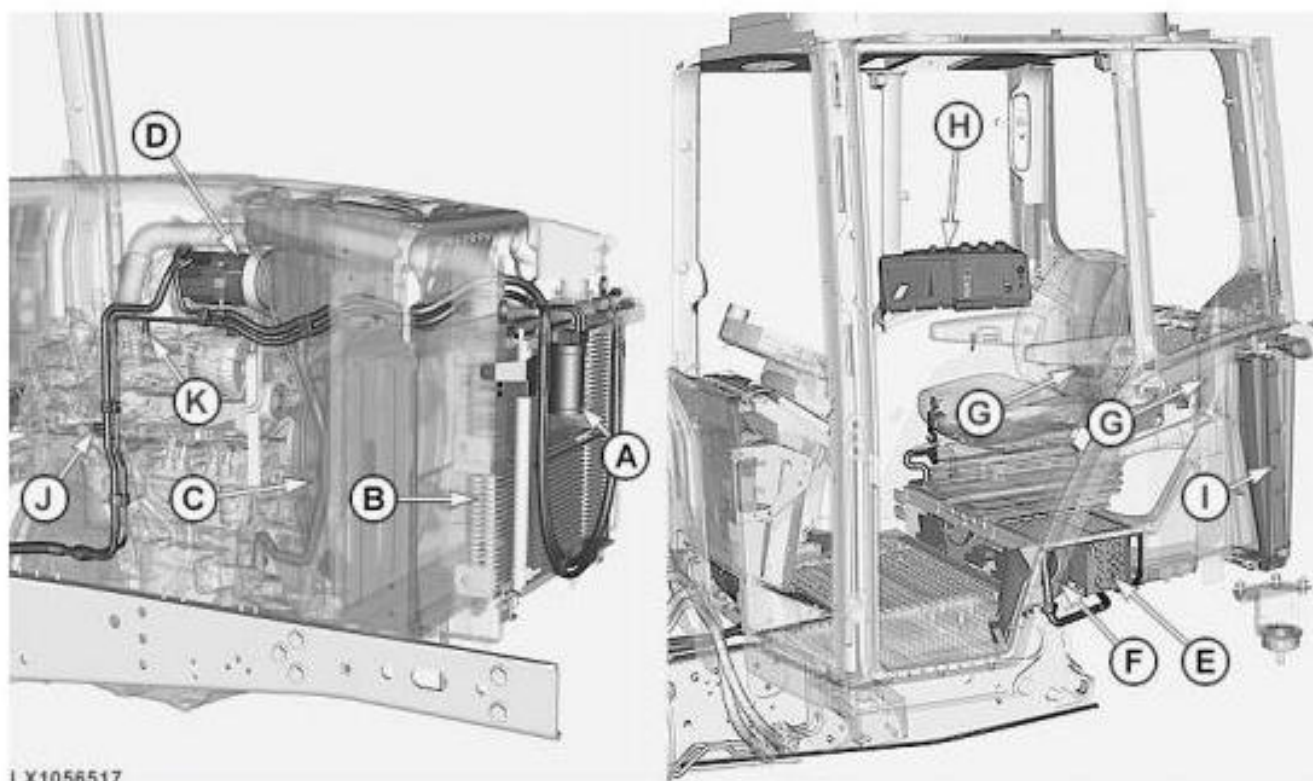

LX1056517

**LEGEND:**

A	Receiver-dryer
B	Condenser
C	Fan shroud
D	Compressor
E	Evaporator
F	Pressurizer blower motor
G	Recirculation air filter
H	Controller
I	Air filter
J	Low pressure connection
K	High pressure connection



Thank you very much  
for your reading.  
Please click here  
to get more information.