

John Deere 655K Crawler Loader Service Repair Technical Manual (TM12721)

655K Crawler Loader Repair

REPAIR TECHNICAL MANUAL

Loader models 655K (PIN: 1T0655KX__E233169—)

TM12721 04 MAR 16 (ENGLISH)

For complete service information also see:

655K Crawler Loader Diagnostic	TM12720
JDLink (MTG) Technical Manual	TM114519
120 Series Hydraulic Cylinders	CTM120519
6068 PowerTech OEM Diesel Engines Below 130kW(174HP) (Interim Tier 4) Level 23 ECU	CTM104619



John Deere Construction and Forestry

Type: Service Manual

Language: English

Pages: 579

Format: PDF

Features: Bookmarked, searchable, printable

Compatibility: Windows/Mac/Tablet/Mobile

This service manual contains important information for the maintenance, troubleshooting and servicing of the **John Deere 655K Crawler Loader Service Repair Technical Manual (TM12721)**

In this manual you will find detailed specifications, illustrations, schematics, diagrams and step-by-step procedures to properly service and diagnose the machine to the manufacturer's standards.

Contents:

- General Information
- Specifications
- Serial Number Location
- Engine Specifications
- Engine Diagnostics
- Engine Tests and Adjustments
- Engine Repair
- Power Train
- Transmission
- Axles
- Differential
- PTO
- Hydraulic System
- Electrical System
- Electrical Tests and Diagnostics
- Wiring Diagram / Schematic
- Ignition and Charging
- Steering
- Brakes
- Wheels
- Operator's Platform
- Body Panels
- Disassembly and Assembly
- Diagnostics, Tests and Adjustments
- Troubleshooting
- and much more...

Please note this manual is in **downloadable PDF format only**. If you have any questions about this product or would like to request sample pages, please contact us and reference the product name or SKU.

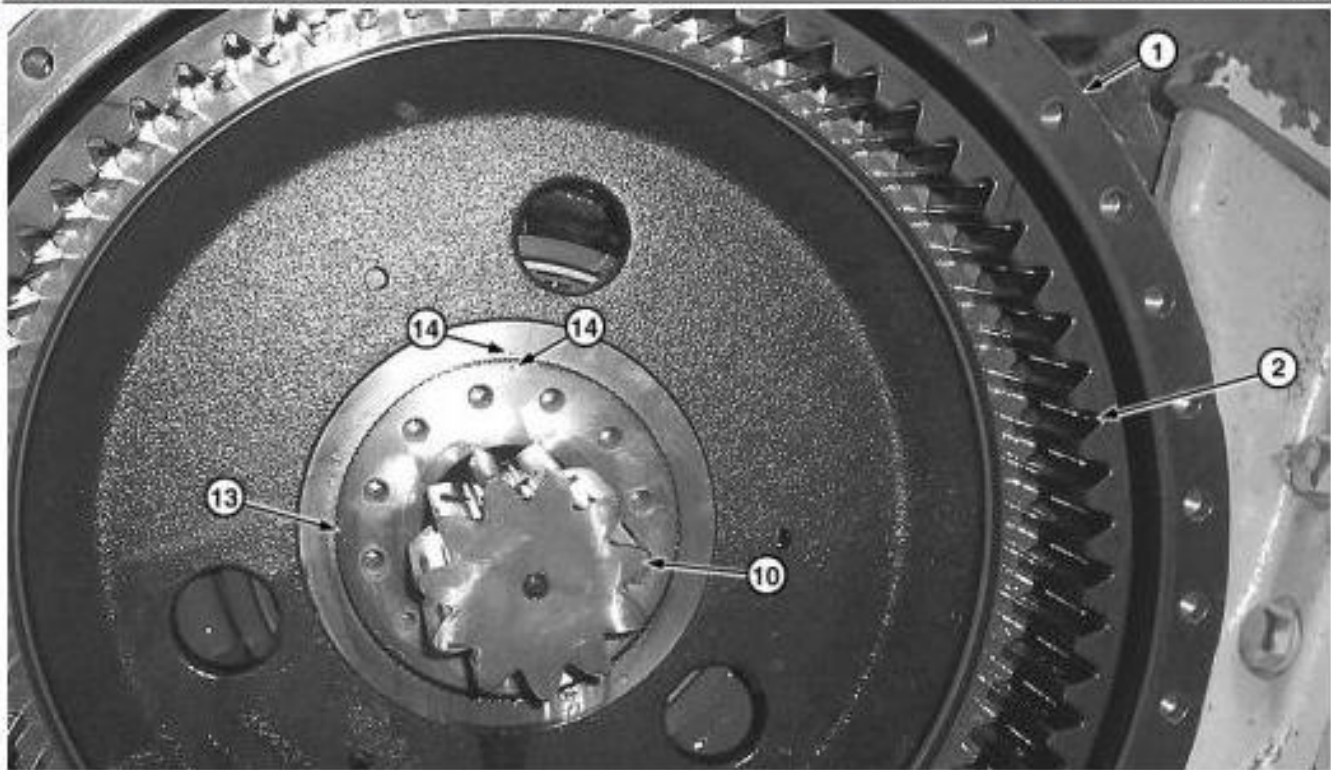

Planetary Housing with Ring Gear and Hub

LEGEND:

- | | |
|----|---------------------|
| 1 | Planetary Housing |
| 2 | Ring Gear with Hub |
| 10 | Sun Pinion Shaft |
| 13 | Inner Cover Housing |
| 14 | Punch Mark |

Mark ring gear with hub (2) and inner cover housing (13) with a center punch mark (14).

[9] -



CAUTION:

To prevent crushing injury from ring gear hub falling out of planetary housing, install cap screws with large flat washers to planetary housing.



LEGEND:

- | | |
|----|----------------------|
| 1 | Planetary Housing |
| 2 | Ring Gear with Hub |
| 16 | Flat Washer (2 used) |
| 17 | Cap Screw (2 used) |

Planetary Housing with Ring Gear and Hub

Install two cap screws (17) with large flat washers (16) to planetary housing as shown.

Hydraulic Integrated Circuit (HIC) Valve Disassemble and Assemble

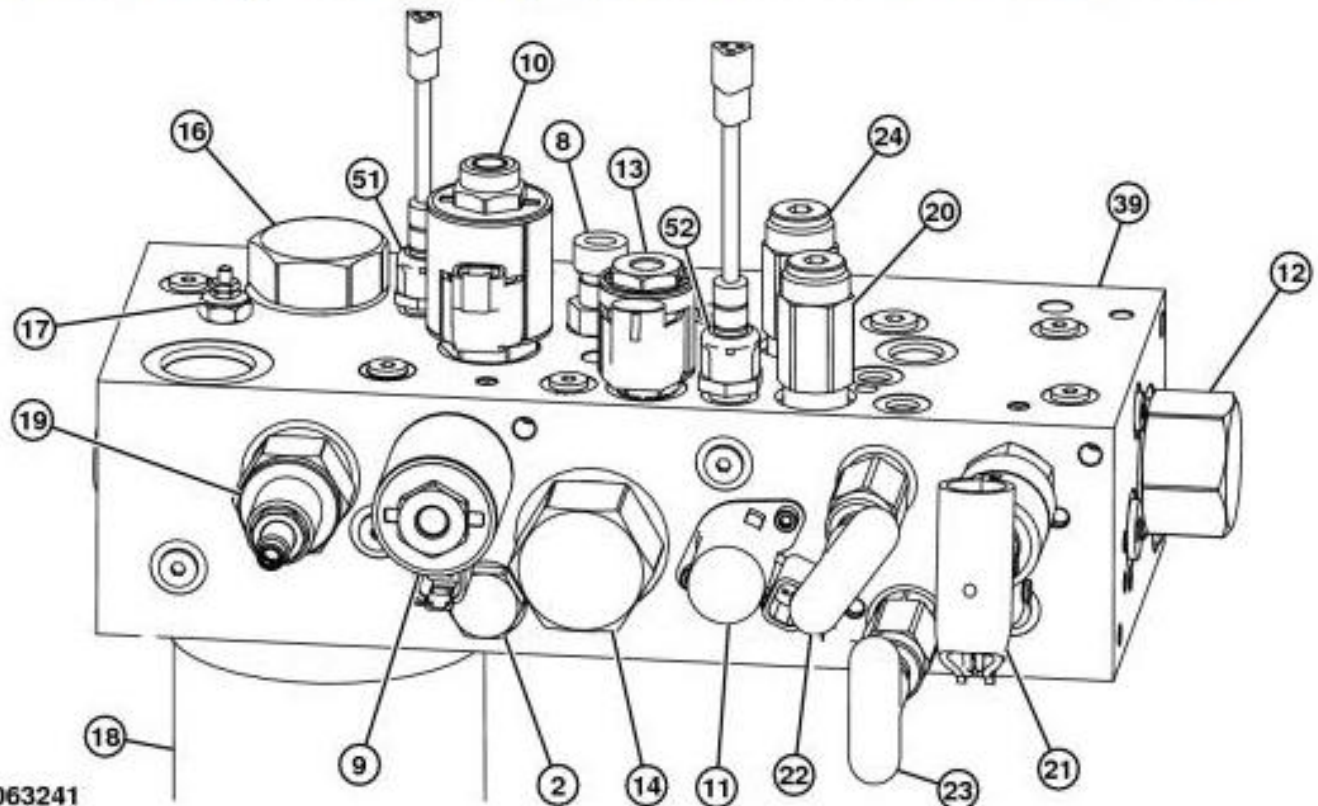

TX1063241

Hydraulic Integrated Circuit (HIC) Valve

LEGEND:

2	Ball Shuttle Valve
8	Hydrostatic Oil Temperature Sensor
9	Park Brake Solenoid 1
10	Park Brake Solenoid 2
11	Hydrostatic Oil Cooler Bypass Solenoid
12	Hydrostatic Oil Cooler Bypass Valve
13	Hydrostatic Oil Reservoir Bypass Solenoid
14	Hydrostatic Oil Reservoir Bypass Valve
16	Hydrostatic Charge Oil Filter Bypass Valve
17	Hydrostatic Charge Oil Filter Restriction Switch
18	Hydrostatic Charge Oil Filter
19	Neutral Charge Relief Valve
20	Hand Pump Park Brake Relief Valve
21	Hand Pump
22	Hand Pump Selector Valve 1
23	Hand Pump Selector Valve 2
24	Hand Pump Tilt Relief Valve
39	Hydraulic Integrated Circuit (HIC) Valve
51	Brake Pressure Sensor
52	Hydrostatic Charge Pressure Sensor

Hydraulic Integrated Circuit (HIC) Valve Component Torque Values

Item	Name	Torque Value
2	Ball Shuttle Valve	33.9 N-m 25 lb.-ft.
8	Hydrostatic Oil Temperature Sensor	24 N-m 18 lb.-ft.
9	Park Brake Solenoid 1	Cartridge: 33.9 N-m Cartridge: 25 lb.-ft. Coil Nut: 8.1 N-m Coil Nut: 72 lb.-in.



Thank you very much
for your reading.
Please click here
to get more information.