

# John Deere GX355D Lawn and Garden Tractors Technical Service Manual (tm1974)

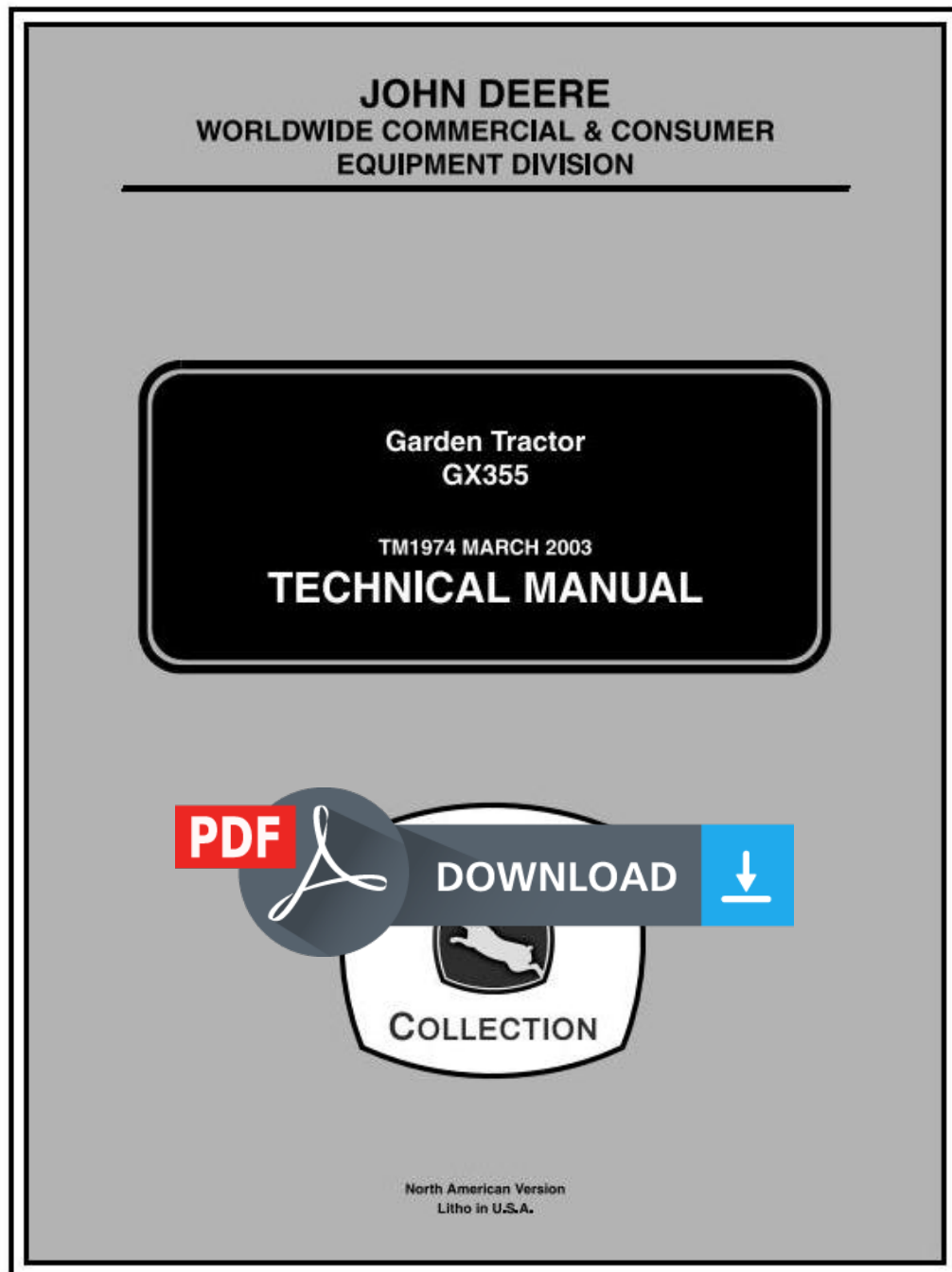

**Type:** Service Manual

**Language:** English

**Pages:** 366

**Format:** PDF

**Features:** Bookmarked, searchable, printable

**Compatibility:** Windows/Mac/Tablet/Mobile

This service manual contains important information for the maintenance, troubleshooting and servicing of the **John Deere GX355D Lawn and Garden Tractors Technical Service Manual (tm1974)**

In this manual you will find detailed specifications, illustrations, schematics, diagrams and step-by-step procedures to properly service and diagnose the machine to the manufacturer's standards.

**Contents:**

- General Information
- Specifications
- Serial Number Location
- Engine Specifications
- Engine Diagnostics
- Engine Tests and Adjustments
- Engine Repair
- Power Train
- Transmission
- Axles
- Differential
- PTO
- Hydraulic System
- Electrical System
- Electrical Tests and Diagnostics
- Wiring Diagram / Schematic
- Ignition and Charging
- Steering
- Brakes
- Wheels
- Operator's Platform
- Body Panels
- Disassembly and Assembly
- Diagnostics, Tests and Adjustments
- Troubleshooting
- and much more...

Please note this manual is in **downloadable PDF format only**. If you have any questions about this product or would like to request sample pages, please contact us and reference the product name or SKU.

# ELECTRICAL GENERAL INFORMATION

## General Information

### Reading Electrical Schematics

The schematic is made up of individual circuits laid out in a sequence of related functions. It is formatted with all power wires (A) across the top and all ground wires (B) across the bottom. Current flow is generally from top to bottom through each circuit and component. All components are shown in the OFF position. The diagram does not list connector (C) information unless needed to avoid confusion. If the connector is shown, the number or letter next to it is the terminal pin location (D) in the connector.

Each component is shown by a symbol (E), its name (F), and an identification code (G). The identification code

contains a device identifying letter (H) and number (I).

The identifying letter is always the same for a specific component, but the identifying numbers are numbered consecutively from upper left to lower right. The terminal designation (J) is placed directly outside the symbol next to the connecting wire path. Switch positions (K) are also placed directly outside the symbol. The solid line (L) shows the position the switch is currently in and dash lines (M) represent other switch positions.

Each circuit is identified at the bottom of the drawing by a section number (N) and section name (O).

The circuit number (P) and wire color (Q) of the wires are shown directly next to the wire path.

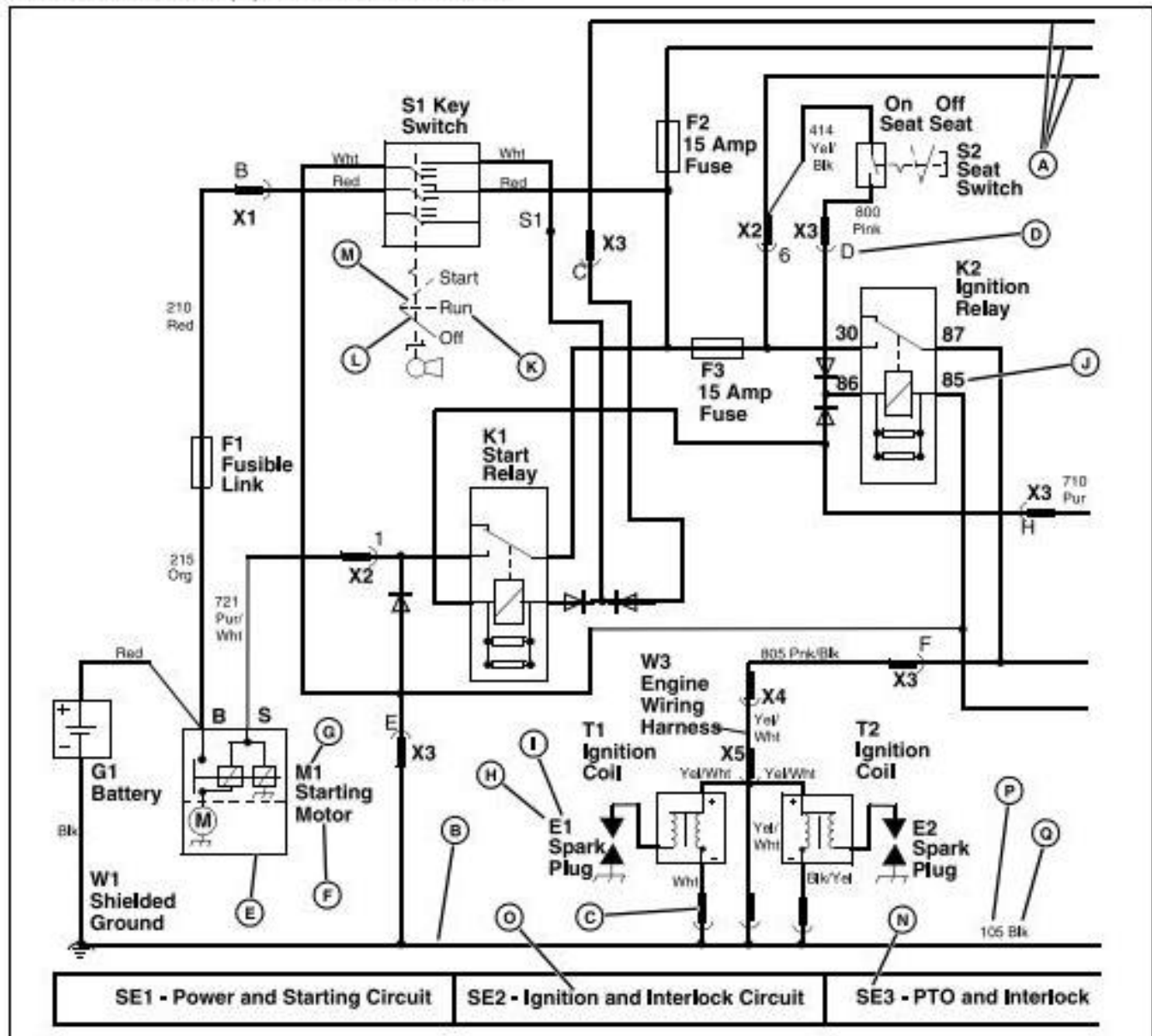

The same component name and identification code are

used consistently on all diagrams in this section. Components can be easily cross-referenced.

# STEERING REPAIR

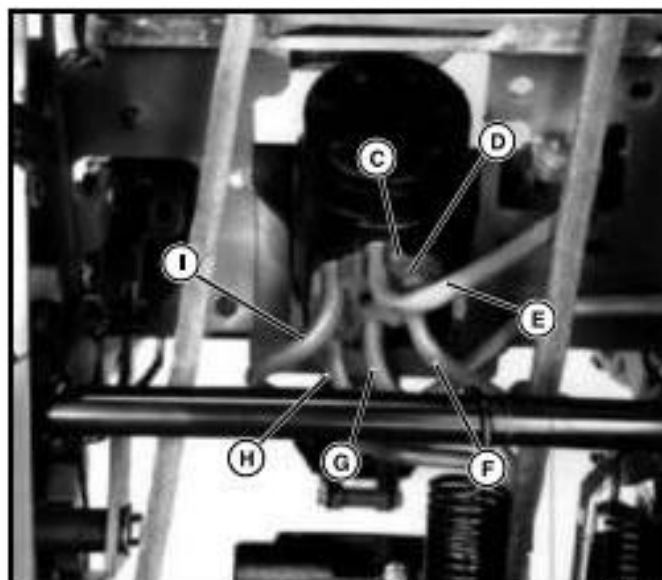

M82945

4. Remove cap screws (D).

**NOTE:** Loosen line clamps as required, to allow movement of hydraulic lines to gain clearance when removing steering valve.

5. Remove hydraulic lines (H and I).
6. Remove retainer plate (C).
7. Disconnect hydraulic lines (E - G).

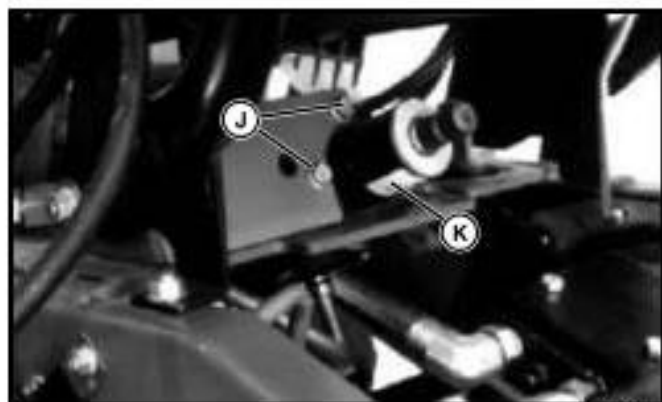

M82946

8. Remove cap screws (J) and steering valve (K).

## Installation:

Installation is done in the reverse order of removal.

**IMPORTANT:** Avoid damage! Always use new O-rings. Damaged or used O-rings will leak.

- Tighten oil line retainer cap screws to 27 N•m (20 lb-ft).
- Fill transmission to proper level with low viscosity HY-GARD, oil. See "Transaxle Oil" on page 16 in Specifications section.

## Disassembly:

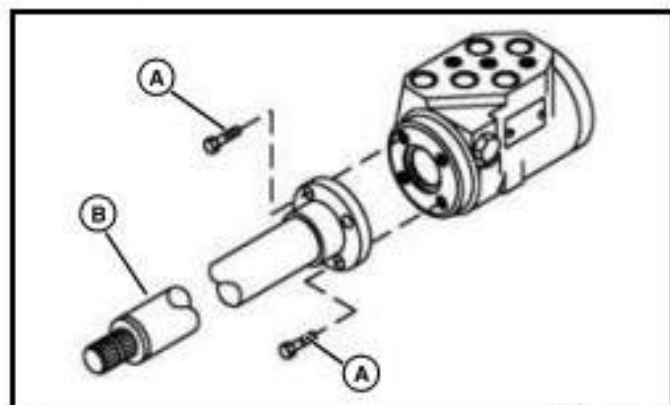

M82971AE

1. Remove two cap screws (A) and input shaft assembly (B).
2. Remove seven cap screws (L).
3. Remove parts (D - G).
4. Remove parts (I - O).

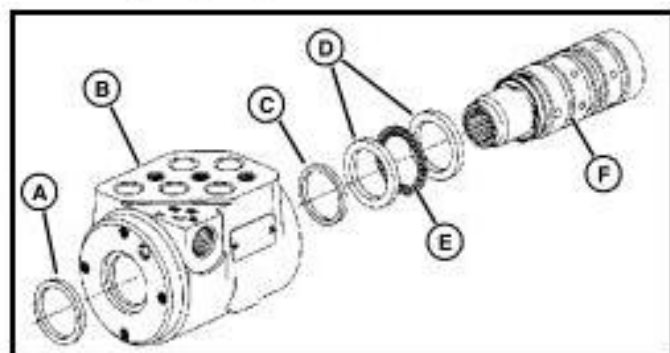

M81129

5. Pull spool and sleeve assembly (F) from housing (B).
6. Remove parts (C - E).

**IMPORTANT:** Avoid damage! Use care not to damage dust seal during removal.

7. Pry dust seal (A) from housing.

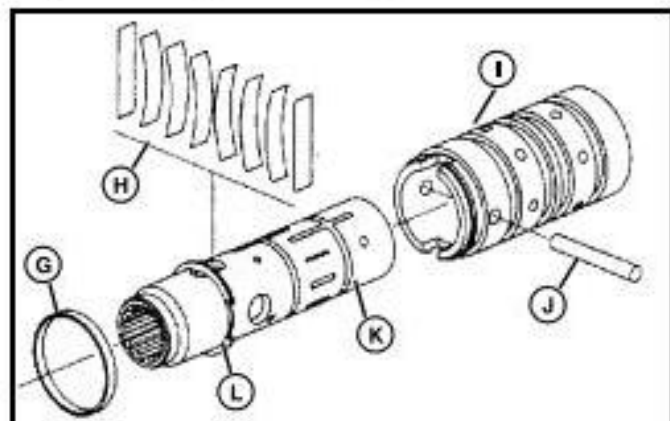

M81130



Thank you very much  
for your reading.  
Please click here  
to get more information.