

John Deere HITACHI Zaxis 190W-5N Wheeled Excavator Diagnostic, Operation and Test Service Manual (TM13253X19)



Covers: 190W-5N,HCMLBD60__0004001-)

Type: Service Manual

Language: English

Pages: 1313

Format: PDF

Features: Bookmarked, searchable, printable

Compatibility: Windows/Mac/Tablet/Mobile

This service manual contains important information for the maintenance, troubleshooting and servicing of the **John Deere HITACHI Zaxis 190W-5N Wheeled Excavator Diagnostic, Operation and Test Service Manual (TM13253X19)**

In this manual you will find detailed specifications, illustrations, schematics, diagrams and step-by-step procedures to properly service and diagnose the machine to the manufacturer's standards.

Contents:

- General Information
- Specifications
- Serial Number Location
- Engine Specifications
- Engine Diagnostics
- Engine Tests and Adjustments
- Engine Repair
- Power Train
- Transmission
- Axles
- Differential
- PTO
- Hydraulic System
- Electrical System
- Electrical Tests and Diagnostics
- Wiring Diagram / Schematic
- Ignition and Charging
- Steering
- Brakes
- Wheels
- Operator's Platform
- Body Panels
- Disassembly and Assembly
- Diagnostics, Tests and Adjustments
- Troubleshooting
- and much more...

Please note this manual is in **downloadable PDF format only**. If you have any questions about this product or would like to request sample pages, please contact us and reference the product name or SKU.

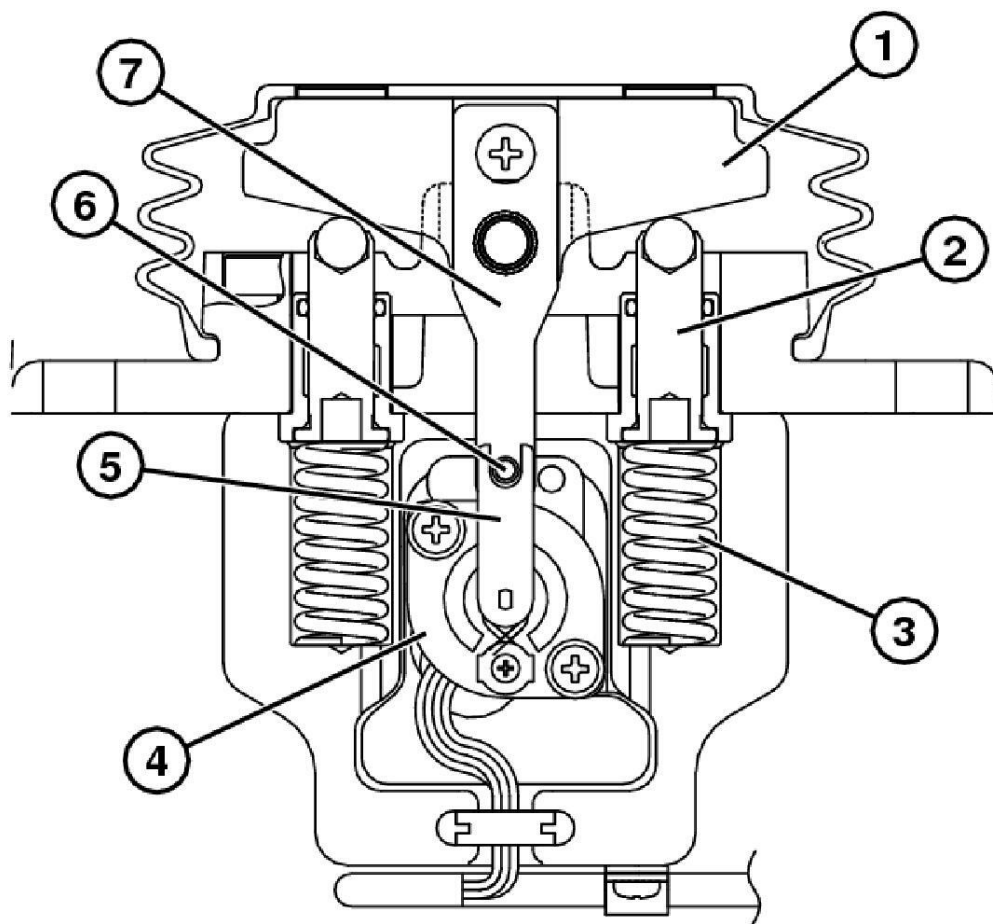

Attachment Pedal and Blade and Outrigger Control Lever

LEGEND:

1	Cam
2	Pusher
3	Spring
4	Potentiometer
5	Potentiometer Support
6	Pin
7	Cam Arm

The option controller (MC2) (A2) controls the blade/outrigger, auxiliary, assist, and two-piece boom positioning functions of the machine. The blade/outriggers are operated by the blade and outrigger control lever (R22) in the cab. Auxiliary hydraulics and boom positioning are operated by the attachment pedal (R21) on the floor of the cab. The assist hydraulics are operated by the assist 1 control switch (S32) and assist 2 control switch (S33) on the right pilot control lever.

Option Controller (MC2) Power Up (power and ground)— Unswitched battery power is available at pins E3 and E4 of the option controller (MC2) (A2) through option controller (MC2) 5 A fuse (F39). Ground is provided to pins D1, E1, E2, E5, and E6.

Secondary Pilot Cut Control— Secondary pilot shutoff solenoid (marked PiC) (Y66) is a normally open solenoid that supplies oil to solenoids of option controller MC2 (A2). MC2 compares operation of attachment pedal (R21), blade and outrigger control lever (R22), pilot disable switch (S39), and assist attachment flow rate adjustment switch (S49) with detected values of pressure sensors (B52, B54, B60, and B67). When MC2 recognizes an error with any of these values, ground is applied to pin B11 of MC2. Current from blade or outrigger and travel direction 10 A fuse (F29) activates the secondary pilot shutoff solenoid, shifting the spool. Pilot oil to boom positioning solenoids (Y57 and Y58), auxiliary control solenoids (Y59 and Y60), assist solenoids (Y61 and Y62), and blade and outrigger control solenoids (Y63 and Y64) is blocked by shifted spool, preventing operation.

Attachment Pedal (R21) and Blade and Outrigger Control Lever (R22)— The attachment pedal and blade and outrigger control lever each consist of a cam (1), pusher (2), spring (3), potentiometer (4), potentiometer support (5), pin (6), and cam arm (7). The attachment pedal and blade and outrigger control lever is fastened to the cam, which is fastened to the cam arm. When attachment pedal or blade and outrigger control lever is operated, cam and cam arm are tilted. Cam arm movement is

R2	Glow Plug 2
R3	Glow Plug 3
R4	Glow Plug 4
W4	Engine Harness
X5	Machine Harness-to-Engine Harness 32-Pin Connector
X6	Machine Harness-to-Engine Harness 16-Pin Connector
X7	Machine Harness-to-Engine Harness 14-Pin Connector
X8	Machine Harness-to-Engine Harness 1-Pin Connector
X9	Machine Harness-to-Engine Harness 20-Pin Connector
X101	Fuel Injector Harness Connector 1
Y1	Electronic Injector 1
Y2	Electronic Injector 2
Y3	Electronic Injector 3
Y4	Electronic Injector 4
Y14	Suction Control Valve

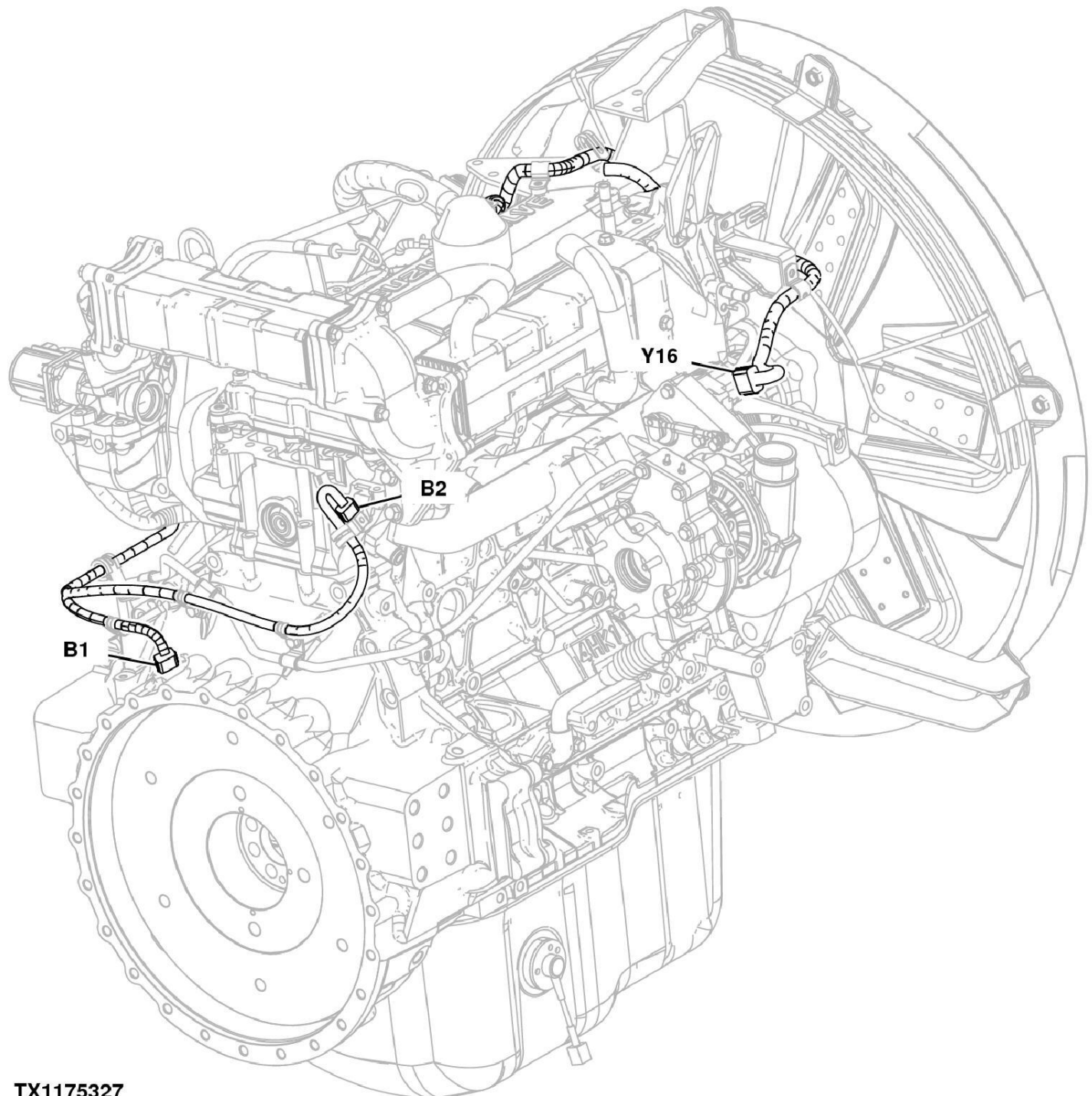

TX1175327

Engine Harness (W4) Component Location (right side shown)**LEGEND:**

B1 Crankshaft Position Sensor



Thank you very much
for your reading.
Please click here
to get more information.